

CODE NUMBER _____
(Kern County Section Corner Index)

CORNER RECORD

COUNTY OF MONO T. 1 S R. 31 E MD MERIDIAN CALIFORNIA
CORNER TYPE: GOV'T. CORNER ☒ MEANDER ☐ RANCHO ☐ CONTROL ☐ OTHER ☐
CORNER IDENTIFICATION — DATE OF VISIT 8-76 + 11/82 19 76

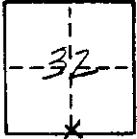

Stamped — $\frac{1}{4}$ S 32
S 5
Replaced 8-1976

CORNER — LEFT AS FOUND ☐ FOUND AND TAGGED ☐ REESTABLISHED OBLITERATED CORNER ☐ REBUILT ☐

PHYSICAL DESCRIPTION OF CORNER FOUND; EVIDENCE AND METHOD USED TO IDENTIFY OR REESTABLISH

Found 2 1/2" x 6" x 1/2" old wood in ring of rocks - No evidence of
any marking or stake.

PHYSICAL DESCRIPTION OF MONUMENTS REBUILT OR PERPETUATED

Replaced stake w/ 3/4" ODH Brass cap placed on top of a 2" ID wood
rod 36" long 12" below the surface and 5" above rock mound
that is 2' in diameter at the base x 15" high. Metal guard
post 2' x 1/2" x 1/2" (70' west of corner) (70' west of corner) (70' west of corner)
on 1/4" steel rod 36" long

CALIFORNIA COORDINATE SYSTEM ORDER: FIRST ☐ SECOND ☐ THIRD ☒
STATIONS USED: NGS (USC & GS) ☐ STATE ☒ COUNTY ☐ OTHER ☐ STATION 5th 4th 4th STATION Dodge
ZONE 3 ELEVATION _____ NORTHINGS (Y) 4350000.00 EASTINGS (X) 2155000.00

SKETCH: (Include reference tie or witness points, remarks and topo of area)

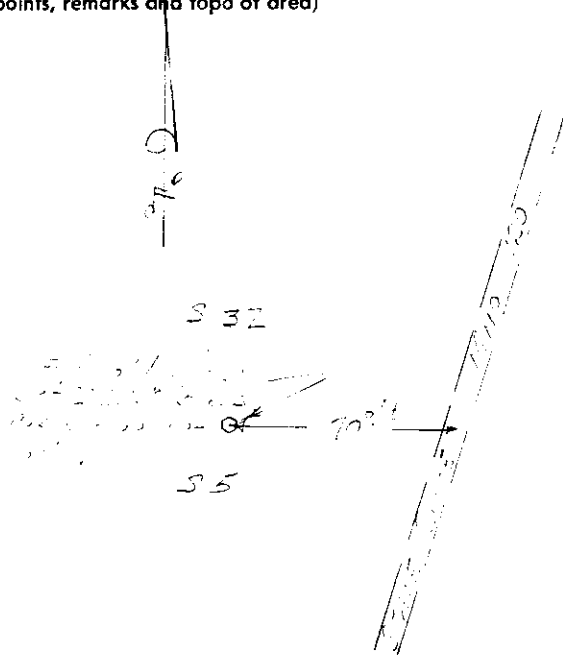

Handwritten notes:
This corner was
found in 1976
and was replaced
in 1977.
The corner was
found in a ring of
rocks and was
replaced with a
brass cap on a
wood rod.

STATE OF CALIFORNIA

SURVEYOR'S CERTIFICATE

THIS CORNER RECORD WAS PREPARED BY ME OR UNDER MY
DIRECTION IN CONFORMANCE WITH THE LAND SURVEYORS ACT
ON November 22 19 76

SIGNED: James C. Thompson

Surveyor's Office

COUNTY SURVEYOR'S CERTIFICATE

THE CORNER RECORD WAS RECEIVED JAN 16 19 77
AND EXAMINED AND FILED JAN 20 19 77

BY: James C. Thompson

TITLE: Survey of 1/4 Section 32

DOCUMENT No. 531-32-2

STATEMENT ON BACK OF SHEET