

CORNER RECORD

Agency Index

BOOK 123 PAGE 97

Document Number

CR 12472

City of OAKLANDCounty of ALAMEDA, California**Brief Legal Description**

CITY OF OAKLAND MONUMENT 85E74 AS SHOWN UPON MONUMENT MAP 1488B482_238 AND CR 2383 (BK 21 PG 17) NEAR THE INTERSECTION OF MARTIN LUTHER KING JR. WAY AND 24th STREET.

CORNER TYPE**COORDINATES (Optional)**RANCHO
SAN
ANTONIO
(V & D PERALTA)Government Corner ☐ Control
Meander ☐ Property
Rancho ☐ Other

N. _____ E. _____

☒ Elevation _____☐ Units Metric ☐ U.S. Survey Foot ☐☐ Horizontal Datum _____

Zone _____ Epoch Date _____

Vertical Datum _____

Date of Survey 10/31/2018☐ Complies with Public Resources Code §§8801-8819☐ Complies with Public Resources Code §§8890-8902PLS Act Ref: ☐ 8765(d) ☒ 8771 ☐ 8773 ☐ Other:Corner/
Monument: ☒ Left as found ☐ Established ☐ Rebuilt ☒ Pre-Construction
☐ Found and tagged ☐ Reestablished ☒ Referenced ☐ Post-Construction

Narrative of corner identified and monument as found, set, reset, replaced, or removed:

☒ See sheet #2 for description (s):

FOUND MONUMENT THAT COULD BE DAMAGED OR DESTROYED BY A PROPOSED GAS LINE CONSTRUCTION PROJECT. MONUMENT WAS REFERENCED AS SHOWN ON PAGE 2 OF 2.

THE PURPOSE OF THIS CORNER RECORD IS TO PRESERVE THE LOCATION OF THE MONUMENT PRIOR TO CONSTRUCTION. NO ATTEMPT WAS MADE TO DETERMINE THE RELATIONSHIP BETWEEN THE MONUMENT AND PROPERTY LINES, RIGHT-OF-WAY LINES, CENTERLINES OR OTHER MONUMENTS.

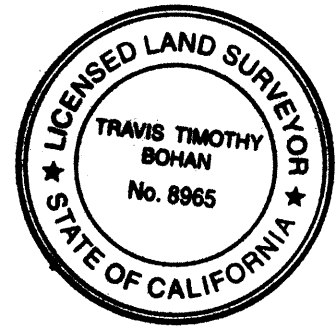
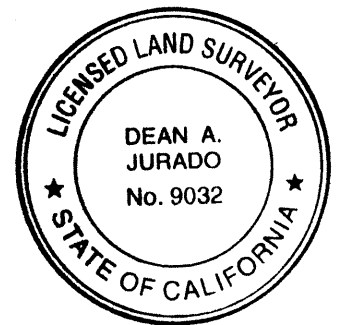
SURVEYOR'S STATEMENTThis Corner Record was prepared by me or under my direction in conformance with
the Professional Land Surveyors' Act on JULY 29, 2019Signed TRAVIS TIMOTHY BOHAN P.L.S. or R.C.E. No. 8965**COUNTY SURVEYOR'S STATEMENT**This Corner Record was received August 9, 2019and examined and filed September 20, 2019Signed [Signature] P.L.S. or R.C.E. No. 9032Title Interim County Surveyor

County Surveyor's Comment _____

CC-14126_94

**MARK
THOMAS**

2411 M.L.K. Jr. WAY
APN 8-677-28

24th STREET
(60' WIDE)

MARTIN LUTHER KING Jr. WAY
(80' WIDE)

S 22°32'49" E
59.80' (59.80')

N 54°00'05" E
26.11'

2323 M.L.K. Jr. WAY
APN 8-663-2

5-MAPS-28

8SE74
SZ58E1

N 22°32'46" W
71.45' (71.46')

SCALE: 1" = 30'

0' 15' 30'

24th STREET
(FORMER)

STATE OF
CALIFORNIA
1-980

BASIS OF BEARING:

BEARING BASIS IS ASSUMED

LEGEND:

- ⊙ FOUND CONCRETE MONUMENT WITH PIN IN WELL
- + FOUND CUT "T" FROM CR 2383 (REPLACED WITH CUT X)
- ⊠ SET CUT CROSS FOR REFERENCE POINT ON TOP OF CURB OR ON CONCRETE WALK
- () RECORD INFORMATION FROM CR 2383 (BK 21 PG 17)
- SZ58E1 ALAMEDA COUNTY MONUMENT IDENTIFICATION NUMBER