

County Surveyor's Office  
Stanislaus County Cal

Swamp and Overflowed Lands

Survey No 1644 see No 214 on page 299

Township 4 South

Range 8 East

Section 30 all between the U. S. Meander line  
and the Right bank of the San Joaquin River  
in the West  $\frac{1}{2}$  of Section 30.

Base and Meridian of Mount Diablo

Containing 76.13 Acres

Surveyed September 26<sup>th</sup> 1861 for  
John M Laird.

Field Notes

Beginning at Meander Post on the West line of Section 30 Run on the U. S.  
Meander line N  $37\frac{1}{2}^{\circ}$  E 5.00 chs. N  $80\frac{1}{2}^{\circ}$  E 18.00 chs. S  $86^{\circ}$  E 22.56 chs. to  $\frac{1}{4}$  Section line Run  
on  $\frac{1}{4}$  Section line S  $\frac{1}{2}^{\circ}$  E 16.84 chs. to the Right bank of the San Joaquin River.  
Meander down Stream Run S  $39\frac{1}{2}^{\circ}$  W 7.00 chs. S  $44^{\circ}$  W 7.27 chs. S  $33\frac{1}{2}^{\circ}$  W 3.67 chs.  
S  $64\frac{1}{2}^{\circ}$  W 3.38 chs. N  $10\frac{1}{2}^{\circ}$  W 3.37 chs. N  $50^{\circ}$  W 4.74 chs. N  $\frac{1}{2}^{\circ}$  E 9.00 chs. N  $15^{\circ}$  W 5.58 chs. N  $66^{\circ}$  E 6.75 chs.  
S  $89^{\circ}$  W 15.14 chs. to the West line of Section 30 Run on Section line N  $\frac{1}{2}^{\circ}$  W 2.88 chs.  
to the place of beginning

Run by the true Meridian Magnetic Variation  $15^{\circ} 45'$  East

Surveyed in accordance with the Act of the Legislature concerning  
Swamp and Overflowed Lands approved April 18<sup>th</sup> 1859 and  
the instructions of the Surveyor General

Silas Wilcox

County Surveyor Stanislaus County

Approved Oct 5<sup>th</sup> 1861

Hot Higley

Surveyor General

per E Furchel Deputy

Recorded Nov 16<sup>th</sup> 1861

E V B Beard

County Surveyor

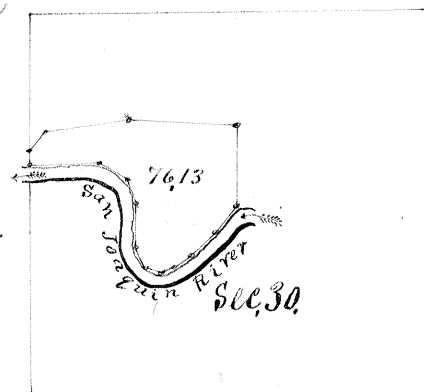

Scale  $\frac{1}{2}$  mile to 1 inch