

*Official Guide  
to the  
Leavenworth  
County Fair*



**AUGUST 7th-11th, 2012**

Leavenworth County Fairgrounds  
Tonganoxie, Kansas



**Don't forget to visit [www.leavenworthcountyfair.com](http://www.leavenworthcountyfair.com)  
for an interactive guide to this year's fair!  
Plus, find us on Facebook and Twitter for contests and giveaways!**



**@LeavCoFair**



**facebook.com/LeavenworthCountyFair**



**“ From Backyard to Barnyard” we have the right food, supplements and supplies for your pets and livestock.**

**Be a winner.... Come to our Kansas Country booth for help, feed or supplies during fair week.**

**Two Convenient Locations to Serve You**



**KANSAS COUNTRY STORE**

**“From Backyard to Barnyard”**

Quality Feed & Products for your Livestock & Pets.

<b>Kansas Country Store</b> 728 Cherokee Leavenworth, KS 913-651-6761	<b>Kansas Country South</b> 1203 Hwy 24-40 Tonganoxie, KS 913-845-3760
--	---

**STORE HOURS:**  
8:00 - 6:00 Mon-Fri  
8:00-4:00 Sat

**DOG & CAT FOOD  
GROOMING SUPPLIES  
COLLARS & LEASHES  
SUPPLEMENTS  
WILD AND EXOTIC BIRD FEED**

Taste of the Wild  
Purina Exclusive Dog & Cat  
Diamond, Science Diet,  
Core Wellness, Nutro, Chicken Soup,  
Blue Buffalo and many more

**Bring in this Coupon  
& Receive a  
10% DISCOUNT  
on your next Pet  
Product Purchase or  
Grooming Service.**

Expires 9/15/12

Ask About HOPE, Inc Low Cost Spay and Neuter Clinic at Kansas Country Store (in Leavenworth)



**Leavenworth County Fair Association**  
(913) 845-3457

**OFFICERS**

President	Mike Johnson, Basehor
Vice President	Mike Kissinger, Tonganoxie
Treasurer	Teresa Lee, Leavenworth
Secretary	Jane Turner, Leavenworth
Veterinarian	Kyle LaRosh, Tonganoxie

**DIRECTORS**

Terms expire 2012

Jaime Moore	Tonganoxie
Bob Beying	Easton
Jane Turner	Leavenworth
Russell Davidson	Tonganoxie
John Wagner	Easton
Tony Berg	Leavenworth
Harold Fevurly	Leavenworth

Terms expire 2013

Jeff Dickinson	Leavenworth
Dennis Eberth	Basehor
Jim Elder	Linwood
Teresa Lee	Leavenworth
Nancy McDougal	Lansing
Richard Parker	Easton
Steve Dickey	Tonganoxie

Terms expire 2014

Mike Johnson	Basehor
Jim Gambrill	Tonganoxie
Ronnie Ewert	Leavenworth
Nick Greenwood	Basehor
Luke Wood	Leavenworth
Mike Kissinger	Tonganoxie
David Todd	Easton

**KANSAS STATE RESEARCH AND EXTENSION,  
LEAVENWORTH COUNTY**

613 Holiday Plaza • Lansing, KS  
Office: (913) 364-5700 • Fax: (913) 364-5704  
www.leavenworth.ksu.edu

Brenda Taxeras  
4-H Youth Development Extension Agent

Steve McNorton  
Ag & Natural Resources Extension Agent

Denise Sullivan  
Family & Consumer Sciences Extension Agent

# Welcome to the

## • Celebrating 86 years •



*Welcome to the Leavenworth County Fair.*

*On behalf of the fair board I want to welcome everyone out to Tonganoxie August 7-11. As with everything in life, the fair has continually tried to keep up with the times and be as current as possible, that means from time to time changes are made. Let me start by introducing some changes in the leadership of the Fair Board.*

*After 20 years I chose to step down as president last fall. I thoroughly enjoyed my time as fair board president and it was a great pleasure to work with such a great group of individuals on the board. I'm very pleased to introduce to you the new president, Mr. Mike Johnson. Mike farms south of Basehor and has been on the board for many years and served as vice president. Moving into that position is Mike Kissinger.*

*Mike has been on the board for several years and has been a longtime 4-H leader.*

*After more years than any of us can remember, Mr. Jim Elder decided to step down as treasurer. Jim and his wife, Edna, have been a fixture at the fair for years. They'll still be around as Jim retained his seat on the board so if you see them around at the fair please give them a big thank you for their years of service. Teresa Lee is the new treasurer. She has been on the board several years and is an experienced finance manager with the Kansas State Prison.*

*A change in the leadership is not all that has changed for this year; several years ago the board decided to have a mud run on Friday night. This event has been very successful, however we have been getting complaints from our neighbors because the event lasting too long into the night. After much discussion the board*

*voted to move the demo derby to Friday night and the mud run to Saturday afternoon. If the switch does not work the board will take up discussion on other possible courses of action after the fair. And finally the last big change and most notable will not happen until 2013.*

*The 87th Leavenworth County Fair will begin on July 30 and run through Aug. 3. This is one week earlier than the current fair dates. This move was necessitated because of conflicting scheduling with our carnival. Many do not realize the important role the carnival plays in the annual fair. The revenue generated annually is between \$10,000 and \$12,000. Those funds are critical in keeping the buildings in good repair and paying all the utility bills. Additionally, finding a reputable carnival with a good safety rating and quality rides is extremely difficult. Well, that wraps up the change part of this column.*

*Now on to what is still the same.*

*We still have great music with the Fairmounters and County Route 5 performing under the Big Top. The annual parade is Tuesday evening followed by the Draft Horse Pull, the theme for the parade this year is "Blue Jeans and Country Dreams." Back by popular demand is the motorcycle trials riding exhibition by the Gray brothers and the lawnmower tractor pull. Admission to this event is a non-perishable food item. The Fair Board will donate all the proceeds to a local food pantry. The kids pedal pull and turtle races are still on Saturday afternoon. Of course all the exhibits will still be there and of course the food vendors on the food court. Parking is still just \$2, so please take the short drive from anywhere to Tonganoxie and enjoy the fair!*



David Todd

### INSIDE

CAMPER REGISTRATION .....	24	FOOD PRESERVATION .....	27	FIBER ARTS .....	36-37
DAILY FAIR SCHEDULES .....	4, 7, 8	FIELD CROPS/HORTICULTURE/HONEY 19		FLOWERS .....	42
DEMOLITION DERBY .....	9-10	GOATS .....	18	FASHION REVUE .....	31
DEMOLITION DERBY ENTRY FORMS 21-22		HONEY .....	19	FOOD/NUTRITION/PRESERVATION 34-36	
FAIR BOARD .....	3	HORTICULTURE .....	19	FORESTRY .....	34
FAIRGROUNDS MAP .....	46	POULTRY .....	17	GEOLOGY .....	35
FAIR LOCATION .....	6	RABBITS .....	17	GOATS .....	43
FAIR PARADE .....	4, 7	SHEEP .....	16	HOME ENVIRONMENT .....	34
FAIR PARADE ENTRY FORM .....	25-26	SWINE .....	16	HORSES .....	42-43
FAIR WELCOME .....	3	PRE-ENTRY FORMS .....	20-22	HORTICULTURE JUDGING CONTEST 32	
KIDS' PEDAL TRACTOR PULL .....	8	OUTLAW MUD RUN .....	4	LIVESTOCK JUDGING CONTEST . . .	32
LIVESTOCK AUCTION .....	36	TURTLE RACES .....	9	PHOTOGRAPHY .....	41-42
2011 LIVESTOCK BUYERS .....	45	UNDER THE BIG TOP .....	4	PLANT SCIENCE .....	42
LONGEST MARRIED COUPLE ENTRY FORM 25-26		4-H CANNED FOOD DRIVE .....	8	POULTRY .....	42
OPEN CLASSES .....	12	4-H/FFA CLASSES .....	31	PROJECT DISPLAYS .....	40
REGULATION FOR EXHIBITORS .12-13		PRE-FAIR EVENTS .....	31	RABBITS .....	42
BEEF CATTLE .....	14-15	RULES AND REGULATIONS .....	32-24	SHEEP .....	42
DAIRY CATTLE .....	14	AG CHALLENGE OF CHAMPIONS ...14		SPACE TECH .....	44
FIELD CROPS .....	19	BEEF .....	43	SWINE .....	42
FLOWER SHOW .....	29	BOOTH AND BANNER .....	39-40	TRACTOR OPERATOR .....	43
FLOWER CLASSES .....	29-30	BUCKET FED CALF .....	43	TEEN LEADERSHIP .....	44
HOME ECONOMICS .....	20	CATS/PETS .....	44	VEGETABLES .....	42
GENERAL RULES .....	20	CLOTHING & TEXTILES .....	37-38	VISUAL ARTS .....	36
ART, PHOTOGRAPHS .....	22-23	CLOVERBUD EXHIBITS .....	44	WOODWORKING .....	42
CERAMICS DIVISION .....	29	DAIRY .....	43		
CLOTHING, TEXTILES, NEEDLE ARTS 20-23		DEMONSTRATION/ILL. TALKS .....	39		
CRAFTS .....	23	DOGS .....	43		
FOODS .....	26-27	ELECTRIC .....	40-41		
		ENTOMOLOGY .....	33		





**TUESDAY, AUGUST 7th  
thru  
SATURDAY, AUGUST 11th**

**FREE SHUTTLE RIDES** to and from the parking lots 4:30 p.m. to 10:00 p.m.  
Plenty of Parking at the fairgrounds for \$2.00 per vehicle  
*Police Supervision*

**2 Nights of FREE Entertainment Under the Big Top**

**“COUNTY ROAD 5”**  
Thursday Night 8:00pm

**“THE FAIRMOUNTERS”**  
Friday Night 8:00pm

**FAIR PARADE 6:30pm     DRAFT HORSE PULL 8:00pm**  
Tuesday Night

**HOT ROD GARDEN TRACTORS & MOTO TRIALS**  
Free Admission with Canned Good Donation  
Thursday Night 7:00pm

**DEMOLITION DERBY**  
Friday Night 6:30pm

**MUD RUN**  
Saturday Night 4:00pm



Have a blast participating in these Fair events:

Kids' Pedal Tractor Pull • Draft Horse Pull • Canned Food Drive • Senior Day at the Fair • Turtle Races • Pie Eating Contest & More!

**CARNIVAL RIDES • GAMES • CONCESSIONS**

On the midway – Open Tuesday thru Saturday.

Midland Empire Shows of Plattsburg, MO will have a Merry-Go-Round, Ferris Wheel,  
and other rides, games and concessions.

**ARMBAND NIGHT**

Thursday, August 9, 6 to 10 p.m.  
Ride all the rides for one price

**4-H/FFA & OPEN CLASS EXHIBITS • COMMERCIAL EXHIBITS**

Open 11 a.m to 10 p.m. Tuesday – Saturday.

Read daily schedules for times and locations of shows & judging events.



# Taking the reins

Longtime fair board member new president

By Shawn Linenberger

slinenberger@theworldco.info

Mike Johnson has been involved in the Leavenworth County Fair since the mid-1960s when he was a member of Glenwood 4-H Club when he was 8 years old.

It's a tradition in his family to be in 4-H and involved in the fair, as he has nieces and nephews who make up the third generation of family members in the Glenwood club in rural Basehor.

He's also been on the fair board for about the past 15 years.

"BJ Wedel took me by the arm and said 'I want you to be my replacement,'" Johnson said, referring to a conversation with the now deceased Wedel, a longtime dairy farmer in rural Tonganoxie.

Now, Johnson is president of the fair board, taking over for David Todd, who stepped down after several years in the post.

Johnson said fair week was an opportune time for people to reconnect each year.

"I think it's a lot of people in the county getting together once a year who don't see those people but once a year," Johnson said.

"It's kind of a community get-together once a year."

Johnson, who lives in rural Basehor, said the fair has grown "big time" since the 1960s. The livestock portion of the fair was at its biggest number around 2000, he guessed, but said participation has been strong in recent years.

He said he'd like for the fair to continue as a great event for everyone to take in each summer. It's hard to beat those funnel cakes or one of the many carnival rides or games, he said. But he said he likes the focus to be on the

youths.

"My thought's always been I want it to be a 4-H fair for kids in the community," Johnson said. "A lot of places want to get it bigger faster. Ninety percent of the kids show one time — at the Leavenworth County Fair. In my opinion that's what it's for — the kids."



Mike Johnson

Johnson is a "John Deere guy" and let those colors be known last summer at the fair. The horticulture building needed a make-over and Johnson volunteered to paint the building. He painted the sides green and the roof yellow, a reflection of the John Deere colors.

He said it definitely was a topic of conversation at last year's fair. He said he told others that another building could be painted red and white for International or Case IH farm equipment.

"That got the talk last year," Johnson said with a laugh. "I'll guarantee you that."

Johnson's hopes for fair week are for some good weather and for everyone in the area to make it out to take in the summer event. At the same time, he would like to see the youths' participation to remain strong.

"I hope that the involvement in 4-H stays good in the county," Johnson said. "It's a good activity for kids to be in if they have a chance."

"And you don't have to be on a farm to be in 4-H. I hope they understand there are a lot of projects besides livestock that people in town or anywhere can participate in."

Visit with Johnson at this year's fair Aug. 7-11, 2012. You can find Johnson and other fair board members working throughout the fairgrounds at the 86th annual Leavenworth County Fair.

## CHANGES IN 2013

The Leavenworth County Fair will be July 30-August 3 in 2013.

The earlier time slot comes because of a scheduling conflict with the fair's carnival.

The Leavenworth County Fair generally has taken place during the second week in August.

## COUNTY ROAD 5

THURSDAY, AUGUST 9<sup>TH</sup>, 2013

8:00 PM at the

LEAVENWORTH COUNTY FAIR  
FREE ADMISSION



County Road 5 was established in the fall of 2003, and has been entertaining crowds ever since. Although encountered by many obstacles along the way, the group has endured and assembled a solid group of musicians to create a sound all their own. The group's never ending love for music, and deep desire to perform, has led them to play over 200 + shows per year, while writing and recording original music for the past 9 years.

Finding time in their busy schedule hasn't been easy, the band has been able to release 3 original albums with great success. Their debut album, "Drink About It", was released in the fall of 2007 and contained "Drink I couldn't handle" and "Drink about it", which were both #1 for multiple weeks and also among the "Top 100 Most Requested Songs of 2008 on Texas Radio" ("Drink I couldn't handle" - #16 & "Drink about it" - #34).

Due to the popularity of "Drink I couldn't handle" the group released a music video in the fall of 2009, which has been featured on many media outlets including GAC's Edge of Country, YouTube, Lonestar Music, Radio Free Texas, Ya'll Wire and many more.

Their 2nd album "Out of Control at the Hilltop" was released in the fall of 2009 and was a live recording at the legendary Hilltop Bar in Tonganoxie, KS. This album included new songs as well as old favorites as a tribute to the fans and supporters who helped along the way.

Their highly anticipated 3rd album "Asphalt & Whiskey" was released in May of 2012 and is the best yet. With all new material and a new twist on the Jerry Reed classic "Amos Moses" it is sure to thrill fans young and old alike. To accompany the new album will be at least 2 new music videos and a flurry of live shows.

## THE FAIRMOUNTERS

FRIDAY, AUGUST 10<sup>TH</sup>, 2012 at 8:00 PM



"The Fairmounters" are a local band formed in a small township in Leavenworth County, Kansas, called "Fairmount." The band consists of 3 brothers, Randy, Ricky and Ronnie McDowell plus a local friend Ron Asher. The band formed around 6 years ago by having random jam sessions with friends as the audience. They started taking the Bluegrass music they played serious, when the audience started bringing friends to hear the band and asked them to play for various occasions. The more people that heard the band, the more followers they had. They have wrote and performed several of their own songs and for the past two years (2010 and 2011) have won "Song of the year" in the new song showcase at the Winfield Bluegrass Festival.



# LEAVENWORTH COUNTY FAIRGROUNDS LOCATION

*All Roads Lead  
to The Fair!!!*

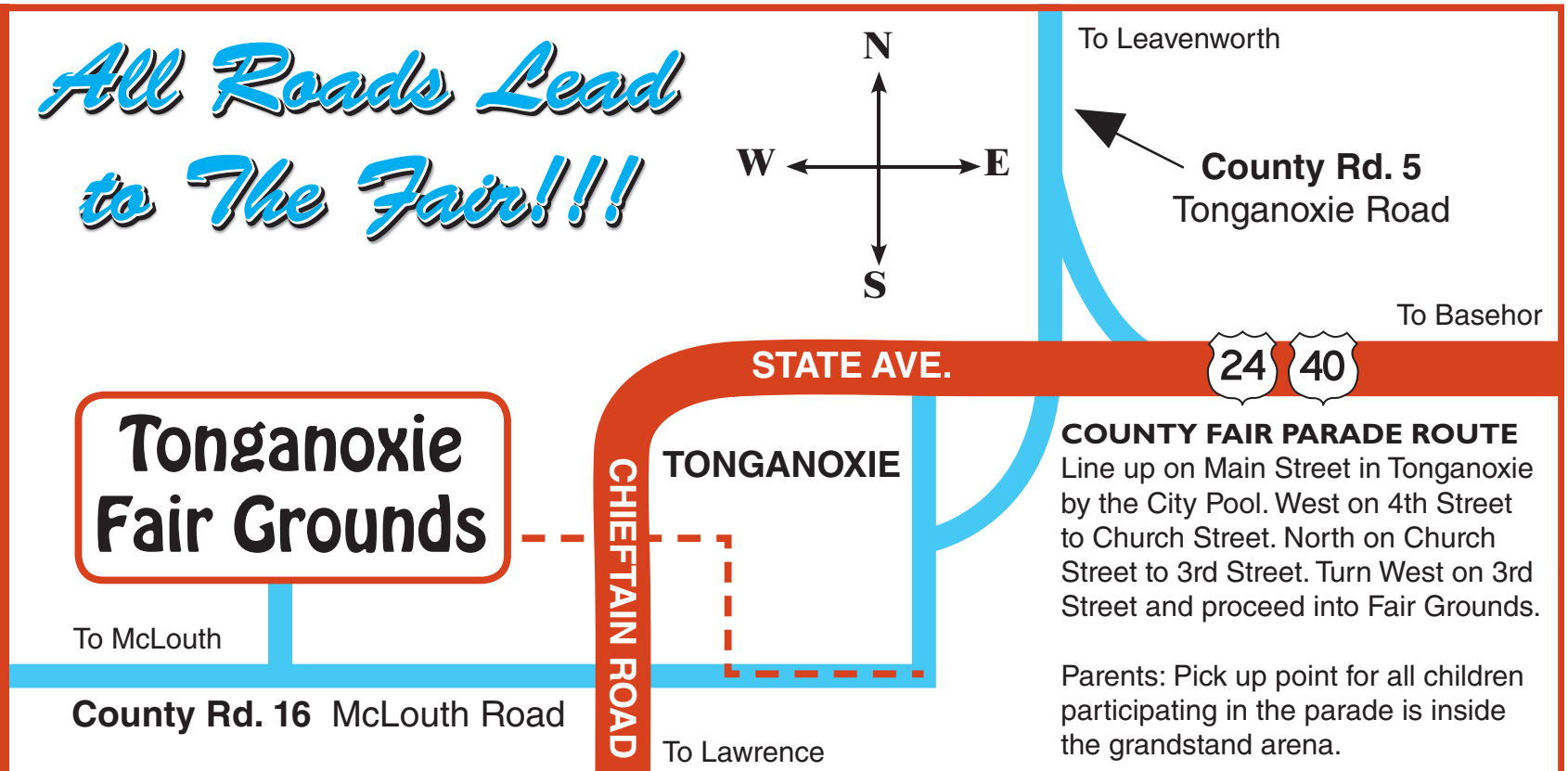

The Leavenworth County Fair is held in Tonganoxie in southern Leavenworth County. The fairgrounds can be reached from Leavenworth by traveling west on U.S. 24/40 through Tonganoxie to the K-16 intersection. Turn right on K-16 and go about one quarter mile to the fair entrance on the right hand side of the road. Fair exhibits will be open to the public all FIVE days of the fair (August 7 to 11) from 11 a.m. to 10 p.m.

## SENIOR DAY

At the 2012  
Leavenworth County Fair  
**Friday,**  
**August 10th**  
10:00 a.m. until 1:00 p.m.  
**UNDER  
THE BIG TOP**

The council on Aging proudly presents

### **“Kansas State Pick’in and Fiddl’in Champions Diane Gillenwater and Jolleen Thorpe”**

**Please join us for Bingo with prizes, door prizes, and a free lunch served to you, with plenty of cold drinks.**

Stay after to see the fairgrounds on the fair trolley. The trolley will pick you up at your car and return you to your car. Seniors 55+ are invited to attend. Sponsored by the Council on Aging and Tonganoxie and Basehor area businesses.

*We thank the following businesses for supporting Senior Day at the Leavenworth County Fair.*

#### Monetary Donations:

Evans Real Estate & Insurance Company, First State Bank & Trust, Quisenberry Funeral Home, Downtown Drug Store, Midwest Chiropractic Center, Dr. Robert Schuck, all of Tonganoxie

Gift Contributors: Kelley’s Grill & Bar, Basehor, Kansas Country Store Livestock and Pet Supplies in Tonganoxie and Leavenworth, Coffee Depot and Vintage Soap, The Jewelry & Clock Shoppe, Elle’s Restaurant, Eagle Memorials – Monuments and Tombstones, all of Tonganoxie.

Lunch Sponsors: Bichelmeyer’s Steakhouse Restaurant, Tonganoxie Nursing Home, Sonic Drive-In Restaurant, and Vintage Park Assisted Living, all of Tonganoxie.





# 2012 LEAVENWORTH COUNTY FAIR

## SCHEDULE OF EVENTS



### TUESDAY, AUG. 7

#### 4-H, FFA AND OPEN CLASSES

##### 8-9 A.M.

- 4-H/FFA & Open Goats entries accepted/weighed in, livestock barns
- Open Class Home Economics entries accepted, Home Economics Building

##### 8 A.M.-NOON

- 4-H clothing entries accepted, Tonganoxie 4-H Building
- 4-H project displays set up, green metal building-west side
- 4-H booth/banner entries accepted, green metal building-west side
- 4-H/FFA and Open Class Poultry entries accepted, poultry barn
- 4-H/FFA and Open Class Rabbits, rabbit barn (Also on Monday. See pre-fair events.)

##### 8-9 A.M.

- Open class home economics entries accepted, Home Economics Building (Also on Monday. See pre-fair events.)

##### 9 A.M.

- 4-H electricity consultation judging, green metal building

##### 9-11 A.M.

- 4-H/FFA Open Class Beef entries accepted/ weighed in, livestock barn

##### 9 A.M.-NOON

- 4-H photography entries accepted, Tonganoxie 4-H building
- 4-H/FFA and open class rabbit entries accepted, rabbit barn (also is 5-9 p.m. Monday, Aug. 8 at rabbit barn)

##### 10 A.M.

- Open class home economics judging and open class ceramics judging

##### 11 A.M.

- 4-H bucket calf entries accepted/ weighed in, livestock barns

##### NOON

- Opening ceremony colors presented at flag pole by Tonganoxie VFW Post 9271 and Tonganoxie High School band. Guest speaker: Mlss Northeast Kansas Meagan Johnson.

##### 1 P.M.



**YOUNG PARADE-GOERS** cover their ears as a loud entry makes its way through the parade.

- 4-H entomology, forestry and geology consultation judging, rabbit barn.
- 4-H photography consultation and home environment judging, Tonganoxie 4-H building

##### 1-4 P.M.

- 4-H/FFA and open class vegetable, plant and bee science entries accepted, green metal building

##### 1-5:30 P.M.

- 4-H/FFA and open class poultry entries accepted, poultry barns

##### 2 P.M.

- 4-H booth/banners and project display judging, green metal building

##### 5 P.M.

- 4-H/FFA and Open Class vegetables and plant science judging, green metal building

##### 6 P.M.

- Fair photo contest entries due, administration building
- 4-H/FFA and open class swine show, show arena.

##### 7 P.M.

- Fair photo contest judging, administration building

##### ENTERTAINMENT

##### 6:30 P.M.

- Annual Leavenworth County Fair Parade. Theme: Blue Jeans and Country Dreams.

**THE LEAVENWORTH COUNTY FAIR PARADE** is one of the first major events during fair week. This year's fair parade, which will take place at 6:30 p.m. Tuesday, Aug. 7, will run along its normal route down Fourth Street in downtown Tonganoxie. This year's theme is "Blue Jeans and Country Dreams." Parade pre-entry forms can be found on pages 25 and 26. Contact information for the parade: Bill Seymour, chairman, 913 449-8012, or Karen Seymour, 913-645-9982; 305 E. Second St., Tonganoxie, KS 66086.

Parade pre-entry forms on page 25, 26 of this catalog. Contact information: Bill Seymour, chairman, (913) 449-8012, or Karen Seymour, 913 645-9982; 305 E. Second St., Tonganoxie, KS 66086.

##### 8 P.M.

- Al Dyer Memorial Draft Horse Pull, Kansas Country Store Arena. Contact: Jeff Dickinson, (913) 775-2110; Tony Berg, (913) 683-1178



### WEDNESDAY, AUG. 10

#### 4-H, FFA AND OPEN CLASSES

##### 8 A.M.

- 4-H bucket calf consultation judging, Big Top Tent
- 4-H/FFA and open class market and other goat show and showmanship judging, show arena.

Please see SCHEDULE. page 8



# GOOD LUCK, GLENWOOD 4-HERS!

**ENVIROTECH**  
HEATING • COOLING  
ENERGY SOLUTIONS

Your Comfort is Our Business

**YORK**  
It's time to get comfortable

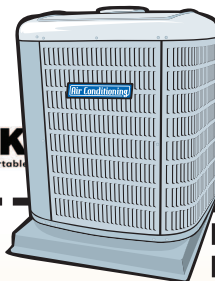

**A/C  
SPECIAL**

**\$79<sup>95</sup>**

**Air Conditioning  
tune-up and clean**

Valid thru 7/30/12



**913-268-6700 • www.envirotechks.com**

## Kids' Pedal Tractor Pull

Sponsored by Leavenworth County Farm Bureau Association

**Saturday, August 11, 2012 • 3:00 p.m.**

at the Leavenworth County Fair Grounds Show Arena.

Registration is from 2 to 3 p.m. on August 11th  
at the show arena.

**Pulling Classes are:**

A - 3 & 4 year olds

B - 5 year olds

C - 6 year olds

D - 7 year olds

E - 8 year olds

F - 9 year olds

G - 10 year olds

H - 11 & 12 year olds



Every participant receives a prize pack.  
Top 3 places in each pulling class receive a trophy.

# SCHEDULE OF EVENTS

from page 4

• 4-H/FFA and open class market and other goat show and showmanship judging, livestock show arena.

**9 A.M.**

• 4-H Cloverbud entries accepted and judged, Tonganoxie 4-H building.

**9:30 A.M.**

• 4-H/FFA tractor operators event, check in at the 4-H office.

**10 A.M.**

• 4-H/FFA poultry showmanship judging, poultry barn.

**10:30 A.M.-NOON**

• 4-H/FFA beef consultation judging, livestock show arena.

**10:30 A.M.**

• 4-H and open class flower judging, home economics building.

**2 P.M.**

• 4-H bucket calf fitting and showmanship judging, livestock show arena.  
• 4-H/FFA and open class poultry show, poultry barn.

**7 P.M.**

• 4-H/FFA and open class market lamb show/sheep breeding show and showmanship judging, livestock show arena.

**8 P.M.**

• 4-H/FFA and open class dairy cattle show, livestock show arena.

**ENTERTAINMENT**

**6-10 P.M.**

• Armband Night at the Carnival.

**7 P.M.**

• Hot Rod Garden Tractors & Motorcycle Riding.

**8 P.M.**

• Musical performance by County Road 5, Big Top Tent, free admission.

**FRIDAY, AUG. 10  
4-H, FFA AND OPEN CLASSES  
8 A.M.**

• Livestock showmanship round robin, livestock show arena.

**9:30-10:15 A.M.**

• Livestock judging contest registration, livestock show arena.

**10 A.M.-1 P.M.**

• Senior Day at the Fair, sponsored by Leavenworth County Council on Aging, Big Top Tent.

**10:30 A.M.**

• Livestock judging contest, livestock show arena.

**11:30 A.M.**

• 4-H rockets launched, baseball field near fairgrounds.

**11:30 A.M.-1 P.M.**

• Ag Challenge of Champions, 4-H office.

**5:30-6:30 P.M.**

• Reception for 2010 4-H/FFA livestock buyers, livestock show arena.

**6-6:15 P.M.**

• 4-H spirit awards, Ag Challenge of Champions and 4-H scholarships announced at north end of livestock show arena.

**6:30 P.M.**

• 45th annual livestock auction, show arena.

**ENTERTAINMENT**

**6:30 P.M.**

• Demolition Derby, grandstand.  
Admission: \$10 for adults, \$5 for youths ages 6-12 and free for children younger than 6.



**THURSDAY, AUG. 9  
4-H, FFA AND OPEN CLASSES**

**8 A.M.-NOON**

• 4-H/FFA and open class dairy cattle entries accepted, dairy barn.

**9 A.M.**

• 4-H/FFA and open class beef cattle show and showmanship judging, show arena.  
• 4-H/FFA and open class rabbit show and showmanship judging, rabbit barn.

**4 P.M. OR IMMEDIATELY  
FOLLOWING BEEF SHOW**

• 4-H/FFA and open class dairy goat show and showmanship judging, livestock show arena.

**5:30-8:30 P.M.**

• 4-H canned food drive, sponsored by Countywide 4-H Junior Leaders, west fair gates and 4-H food stand.

Please see FAIR, page 9





Photo by Shawn Linenberger

**YOUTHS ENJOY** one of the rides at the 2011 Leavenworth County Fair carnival. Rides and games are popular stops for fairgoers each year.



**CANNED ITEMS** entered in the 2011 Leavenworth County Fair receive several ribbons.

Photo by Shawn Linenberger

# Fair schedule

FROM PAGE 8

**8 P.M.**

• Musical performance by The Fairmounters, Big Top Tent, free admission.



10 a.m.-noon

• 4-H dog show agility classes.

11 a.m.-12:30 p.m.

• Turtle races registration, limit one turtle per child, Big Top Tent. Bill Adams, superintendent, (913) 306-5181.

1 p.m.

• Turtle races, Big Top Tent.

2 p.m.

• Kids Pedal Tractor Pull, 3 p.m., show arena. For more, see the ad on page 8.

## ENTERTAINMENT

4 p.m.

• Mud run, north of parking area.

Admission: \$10 for adults, \$5 for youths 6-12 and free for children younger than 6.

## SUNDAY, AUG. 12

8:30 a.m.

• Closing ceremony presented by Tonganoxie VFW Post 9271.

9 a.m.

• 4-H/FFA exhibits released.

10 a.m.

• Fairgrounds clean-up.

## SATURDAY, AUG. 11

### 4-H, FFA AND OPEN CLASSES

• 4-H horticulture judging contest, show arena, closed to the public.

10 a.m.

• 4-H/FFA shepherd's lead contest, Big Top Tent.

**DON'T FORGET TO VISIT**  
**WWW.LEAVENWORTHCOUNTYFAIR.COM**  
**FOR AN INTERACTIVE GUIDE**  
**TO THIS YEAR'S FAIR!**

**Coming Soon Next to Bichelmeyers in Tonganoxie, KS!**



**Just West of Bichelmeyer's Steakhouse • 913-669-7919**

**"I want my car to go to Tallman's"**



## Collision/Auto Body Repair

From Scratches, Small Dings to Major Damage, Tallman Auto & Body Will Get You Back on The Road, Good As New!

Let us handle your claim. We work with all insurance companies.

## Automotive Services

- Tune Ups
- Oil, Filter & Lubrication
- Alignment & Front-in Service
- Exhaust Repairs
- Air Conditioning Service
- Transmission Fluid & Filter
- Tire Balancing
- And so much more...

*Save Time & Money on Your Auto Repairs*

**Quality is not expensive—  
 It's priceless!**

Serving Kansas City Area for Over 58 Years.

**13910 State Ave. • PH: 913-371-2881 • FX: 913-721-3132**



# Demolition Derby

Friday, Aug. 10 • 7 p.m. • Grandstand

## Pit & Drivers Registration, Regulations and Rules:

1. All drivers and pit crew must be 16 years of age or older and must have a valid driver's license. No one younger than 16 allowed in pit.

2. All drivers and pit crew between 16 and 18 years old must have notarized parent signature on the Minor Release Waiver.

3. Entries will be accepted up to two (2) hours prior to show time.

4. All drivers must attend pit meeting prior to show time.

5. Driver's Safety- Safety belts, helmets (DOT approved), shirt and long pants are required for drivers during the event. Face shield or safety glasses of some type suggested. All drivers must remain in car until the end of the heat. No riders in demolition cars.

6. Any driver or pit person causing a disturbance must leave the grounds immediately. Belongings can be picked up the next day.

7. Proof of ownership or title to the car must be available upon request. VIN must also be on vehicle.

8. Only demo cars and their tow vehicles will be allowed in the pit area. Additional cars or trucks will not be allowed.

9. No alcoholic beverages will be allowed in the pit area. Any violation of this rule will result in disqualification and immediate removal from

the grounds.

10. Must have a wristband on and sign waiver of Liability and Indemnity Agreement to be in the pit area.

## Demolition Derby Car, Rules and Regulations:

1. Full size- American cars (other than Imperials and or Imperial sub frames) allowed. No jeeps, trucks, carryalls, 4 wheel drive, or commercial vehicles allowed (i.e. checkers, vans, ambulances, limos, hearses, etc.). Standard Police and taxi packages ok. Full Size: Total of 6 contact points hood & trunk (including 4" welds on trunk), weld 50% of all outside door seams and change body mounts to 3/4" bolt. The Compact class-may run a 4 cyl or 6 cyl motor and have a wheelbase of 108" or less. No pickups, vans or SUV's allowed.

2. Full-size may use motor and tranny of choice, motor must be in stock location. Distributor protectors are allowed. MUST BE connected to motor and transmission only. You may chain or weld motor tranny to keep in place. Suspension and cradle may be replaced as long as it stays the same make (ford of ford, chevy on chevy). You must have driver's door protection of some kind.

3. Number must be painted on both sides of car and 12"x 12" number sign on the top. Slogans and/or advertising must be in good taste.

4. All glass and chrome must be removed BEFORE reaching the grounds. This includes headlights and tail lights. Do not just knock out glass, but remove cleanly. Trunks and interior must be empty of all debris, spare tires, rims, parts, etc./

5. Gas tanks must be removed from stock position and relocated in back seat area and properly secured. No extra gas cans permitted in car. \*\*\*Boat tank or aftermarket fuel tank required. \*\*\*Do Not use OEM fuel tanks! If vehicle is equipped with an electric fuel pump a shut off switch (Red) must be placed in easy reach of driver. Batteries must be removed from stock position and relocated in passenger area. Cover battery and fuel tank for protection. Gas tank protector may be used as long as it does not go past speaker deck and does not touch any metal at any point. This will be a judgment call at inspection. "NO BUNGEE CORDS" Make sure they are secured tight and have no movement.

6. Radiators may be removed but not relocated. No added protection may be in front of radiator. Water only please.

7. All doors, hood, wagon gates and trunk lids must be fastened shut. A maximum of 6 fasteners per hood, door, trunk and wagon gate, not closer than 12 inches apart, no extra bolts or chains in front of radiator. Maximum fastener size will be 3/4" diameter. All

chains, wire, fasteners, etc. must pass through sheet metal only, with the exception of the front two bolts may go through the top side of frame. Trunks and hatchback may be welded 50%.

8. Driver and Passengers outside Door seams may be welded with strap no larger than 4" wide and 3/16" thick. Only driver's door may be reinforced. Driver's door may be welded solid.

9. Welding on body and frame. No reinforcements allowed other than specified below. Any metal added to reinforce the car is illegal! ABSOLUTELY NO WELDING ON FRAMES OR BODY UNLESS SPECIFIED Without adding extra metal or braces, weld only. A-arms forward OEM seams, Front bumper shock boxes, motor and Transmission Mounts and Drivers & Passenger outside door seams.

10. No reinforcement of body or frame. No chains, bolts or extra material may be attached, around or through frame. This includes any type of plating. Original body on stock frames for that year must be used. You may cut frames for minimal pre-bending, but may not weld the cut. You may replace body mounts, but must have minimal of a 1" space between the frame and body. You may replace stock bolts and washers on outside of body and frame, but must not exceed 1" bolt diameter or 3" washer diameter.

## Shuck Implement Company, Inc.



**MASSEY FERGUSON**  
masseyferguson.com

(785) 843-0893 (800) 654-5191

Fax: 785-843-1014

1924 E. 1450 Rd.

Lawrence, KS 66044

## Murrfield Farms Supply LC



**Fertilizer, Chemicals, Westendorf Loaders,  
Sitrex Rakes, Twine, Seed**

Bill & Joy Murr, Travis Starcher Lynn Murr

**913-796-6213**

**22947 243rd, St.  
McLouth, KS 66054**



# Derby rules and regulations

FROM PAGE 10

Body mount may not be covered in any way. Nobody bolt may extend below frame; all bolts and nuts must be inside of frame. Front radiator core support bolts may be changed. Package tray bolts are ok. Fender well cut out outs may have 4- 3/8 bolts per fender well. Also see Rule #11 below for rear cables. NO additional support may be added, in, through or attached to frame or body!

11. Suspension must be at stock height. Leaf springs must be stock. Coil over shocks, air shocks, lifts, blocked shocks or other reinforcement will not be allowed. OEM tow package OK. You can bolt or wire coil springs to rear end and frame to prevent springs from falling out. You can loop chain or wire from rear end to frame in 2 spots on each side. No bigger than #9 wire or three eights chain or cable may be used. Rear-end control arms may be reinforced, but must be workable. They may be shortened or made longer as well. The rods may also be reinforced.

12. No special bumpers, extra weights, trailer hitches, OEM Passenger Bumpers are interchangeable. Any Automotive bumper may be used on any car. No homemade bumpers or brackets. You can weld bumper brackets or towers to the frame. You can weld bumper brackets and shocks to the bumper. You can weld shocks to shock towers. You can collapse shocks and you can bolt the collapsed shocks to the towers with 1/2 - inch bolt or less and it must be done vertically. You may trim bumper ends or

fold them around. You can weld outer skin of bumper to the inner part of the bumper. When welding bumpers, shocks and brackets, do not add any metal just use the welder. Rear bumper may be replaced with no more than 4"x4" square tubing. This rule applies for coil spring cars only.

13. Pneumatic tires only. No solid tires or split rims. All wheel weights and any type of studs should be removed from tires. Valve stem protectors if mounted securely (rebar or flat stock) and Uni-lug center on OEM wheel ok.

14. Auxiliary transmission cooler will be allowed, but must be located in the rear passenger's compartment and properly covered. All transmission lines must be insulated on auxiliary coolers. Transmission lines may also be looped.

15. A single bar may be placed behind the driver's seat. The bar may be no higher than the stock seat and be parallel to the stock bench seat. A single bar may also be placed across the dash area. Bars may be connected with sidebars but sidebars must remain on the inside of passenger area. Bars must attach to sheet metal only

and maximum mounting plate size of six inches square on cross bar ends. Halo bar may be added and bolted to roof in 2 places. No kickers may be attached to the cage. Cage purpose is for driver's safety! Front and rear window bars (2 each) may be used but must attach to sheet metal only no further than 3" from window opening. Max size is 3" diameter or 3" angle for

window bars. Two (2) kickers may be placed in car, attached to sheet metal only. If roll bar goes all the way to floor that counts as kickers. Cage may not go over half way past rear seat area.

16. Any car not participating in the action for 30 seconds, not moving for one (1) minute or stalled for one (1) minute will be disqualified. Cars that are

hung together must make contact with other live cars in one (1) minute or be disqualified.

17. No intentional head-on or driver-door shots allowed. You must have at least a 12" hole in hood for fire protection (4 - 3/8" bolts may be used on cut outs).

18. No person under the influence of alcohol or controlled substance will be permitted to participate or enter show area.

19. A protest will cost \$200.00 up front. If the protest stands, the \$200.00 will be returned. If not, the \$200.00 is forfeited.

20. The judge may require a driver to remove or change any part or portion of the automobile, which the judge considers to be unsafe to the driver or to other drivers in the event. All decisions of the judge are final.

21. The officials if deemed necessary will deal with any situation not covered in these rules. Any questionable or judgment calls may need to be brought up at drivers meeting for approval.

22. 1980 & Newer: May weld OEM frame seams 12" per frame rail behind the A arm.

23. All cars have to be removed from the grounds by noon the next day, or they will be towed for salvage

PRERUN CARS ONLY CAN HAVE FOUR (4) 4"x8"x1/4" PLATES MAX NO EXCEPTIONS

1 CLASS OF SUV'S, COMPACT TRUCKS, MINI VANS....100% PAY-BACK PLUS 1st, 2nd, 3rd PLACE TROPHIES.

GATES OPEN AT 2:30PM \$35.00 ENTRY FEE.....\$15.00 PIT PASSES

ROLLOVER COMPETITION:

This year we will be having a Roll-over Competition. Pre-register only.

Please contact Colton Farr 913-775-0554 for rules and information.

LAWNMOWER DERBY:

This year we will also be having a Lawn Mower Derby. Pre-register only

Please contact Colton Farr 913-705-0554 for rules and information.

## DERBY TIME

• This year's Leavenworth County Fair Demolition Derby will be 6:30 p.m. Friday, Aug. 10, at the Leavenworth County Fair Grandstand.

• Admission to the event is \$10 for adults, \$5 for youths 6-12 and free for youths younger than 6.

• For more information about the demolition and lawnmower derbies and rollover competition, or for more information about rules for the demolition and lawnmower derbies and rollover event, contact Colton Farr at 913-705-0554.



**Geiger**  
**READY-MIX**  
Building Materials Since 1892

Serving Leavenworth County and Beyond with  
**CONCRETE & BUILDING MATERIALS**

913-772-4010 KC Metro: 913-281-0111



**Evans**  
"Since 1895"  
**REAL ESTATE & INSURANCE COMPANY INC.**  
502 E. 4th Street,  
Tonganoxie, KS 66086  
**913-845-2400**  
**913-845-2434**



## Interact with us via Facebook and Twitter

Go to [facebook.com/leavenworthcountyfair](https://facebook.com/leavenworthcountyfair) and [twitter.com/LeavCoFair](https://twitter.com/LeavCoFair) to post photos from the fair and more. We're also available at [leavenworthcountyfair.com](http://leavenworthcountyfair.com). There's already plenty of news being posted, so join us today!



**Humans aren't** the only ones trying stay cool during a Kansas August.



**Interacting with animals** in the livestock areas is a popular activity for people attending the Leavenworth County Fair.

### OPEN CLASS

# General rules and regulations for exhibitors

#### OPEN CLASS

##### TO ALL EXHIBITORS:

1. Premium competition is open to Leavenworth and surrounding counties. Premiums are paid only on classes as listed.
2. Entry Fees for the fair are as follows:
 

Flowers.....	25¢ per entry
FarmCrops.....	25¢ per entry
Home Economics Youth.....	25¢ per entry
Adults.....	25¢ per entry
Senior Citizens.....	25¢ per entry
Horses (Unless otherwise stated) .....	\$3 per class
Cattle.....	50¢ per entry
Swine.....	25¢ per entry
Sheep.....	25¢ per entry
Poultry.....	20¢ per bird
Rabbits.....	20¢ per head

- The entry fee is payable to the Division Superintendent at the time the entry is made except in the case of livestock exhibits. For livestock entry fee amounts and due dates see appropriate division.
3. Persons making entries shall be furnished with a duplicate tag to be placed on the article to be exhibited.
4. Check the "Fair Calendar of Activities" for time of opening and closing of entries.
5. Exhibitors must deliver their exhibit on the grounds to the superintendent of each division, who will direct the placement and arrangement on the grounds. Exhibitors must give their personal attention to their property, and immediately after the close of the fair, take charge of and remove same.
6. No animal or exhibit may be removed from

- the fairgrounds before 9 a.m. Sunday (except production dairy cattle and dairy goats.)
7. All exhibits shall be under control of the association during the fair and not be removed from the grounds during the fair without the consent or written permission of the president. Exhibitors, including those to go on to other shows, violating this rule must forfeit any and all premiums that have been awarded. Duplicate of the exhibit tag must be presented to the superintendent before exhibit is removed. This applies to all exhibits.
8. Judging of exhibits will be according to schedule.
9. After awards have been made, ribbons must be left on article or posted securely adjacent thereto, so that the public may identify awards

Please see GENERAL, page 13

## SUTTON-KOLMAN AUTOMOTIVE

We know your car and truck guaranteed!

CAR CARE SERVICES

General Services including Undercar, Heating & Cooling,  
Electrical, Transmission, Electronic, Internal Engine,  
Heavy Duty, Towing, Miscellaneous

913-369-8710

1204 Hwy, 24-40 • P.O. Box 499  
Tonganoxie, KS 66086

913-724-4244

15395 Briar Road  
Basehor, KS 66007

Bob Kolman, Owner

## MUFFLER MASTERS

### EXHAUST SPECIALIST

- Stainless Steel Tips • Custom Made Pipes • Dual Exhaust
- Lifetime Guarantee Mufflers Available • Welding - Section Repair
- Catalytic Converters • Expert Installation • Free Estimates
- Auto & Truck Mufflers • Complete Custom Truck, Bus, RV

LOWEST PRICES IN TOWN, WE WILL NOT BE UNDERSOLD!

105 Seneca, Leavenworth, KS

(2 blocks north of Riverfront Community Center)

913-682-3382

HOURS: 8 A.M. - 5 P.M., MON. - FRI



## OPEN CLASS

# General rules and regulations

## FROM PAGE 12

of judges.

10. Open class premium checks will be issued at the fair board office only and must be cashed within 30 days. They will not be mailed.

11. The association will not be responsible for any injuries, loss or damage to property, livestock or persons taking part on the fairgrounds. All proper precautions will be taken to avoid this possibility, but notice is given that the organization will not be and is in no way responsible, that entry to the grounds is at the risk of said property, livestock or persons concerned.

12. Should any individual enter an animal or article in any other name than that of the bona fide owner or in any other way attempt to perpetrate a fraud, such person, upon positive proof, shall not be allowed to compete or receive premiums.

13. Where a class is not filled the judges may award the prizes according to the merit of the exhibit. Lack of competition shall not bar anyone from a premium, but the article or animal shall not have a premium unless worthy of it.

14. The management reserves the right to remove from the grounds any exhibit, animals, concession or show that may have been falsely entered or deemed unsuitable or objectionable; to remove any sign, banner, or advertising matter of any kind which may be deemed objectionable by them without giving any reason therefore.

15. No alcoholic beverages allowed on the fairgrounds.

16. Articles that make up a collection cannot be entered for separate premiums.

17. Ribbons may be given on classes exhibited but not listed in the premium list, providing they are worthy.

18. The management reserves final and absolute right to interpret its rules and regulations, to amend and add to these rules and arbitrarily settle and determine all matters connected with the fair.

19. Lights out at 12:00 midnight. All livestock building will be closed. Persons on the grounds without valid reason will be asked to leave. This will be enforced by Leavenworth County Sheriff's Department. (NOTE: Exceptions will be made for the livestock shows that run late.)

20. The management reserves the right to remove from the fairgrounds any person or persons that are unruly, disruptive or threatening to any fair management, employees or patrons.

Premium List for 2011: Please read Article, Rules, and Regulations, relative to entry fees.

## ATTENTION ALL LIVESTOCK AND HORSE EXHIBITORS

### 1. LIVESTOCK PRE-ENTRY

A. ALL LIVESTOCK EXHIBITORS MUST PRE-ENTER the exact number or livestock they will be exhibiting. Open class entry forms can be found in the center pages of this catalog. 4-H/FFA entry forms are available at the extension office.

B. Open class only livestock exhibitors must send pre-entry forms (page 36 of this catalog) and fees to respective district superintendents by Friday, July 29th. NO EXCEPTIONS. Late entries will be returned unopened.

C. See appropriate division for entry fee amounts.

2. ONLY WOOD CHIPS or SHAVINGS ARE ALLOWED TO BE USED AS BEDDING and must be supplied by the exhibitor. Poultry and rabbits only may use straw.

3. Livestock, rabbits and poultry exhibitors must keep stalls and pens clean and in a presentable condition for public inspection. It is the duty of the superintendents to see that the rule is complied with. Unclean pens may bar a premium.

## STATEMENT FOR ANIMAL CARE FOR LEAVENWORTH COUNTY FAIR LIVESTOCK EXHIBITORS

The Leavenworth County Fair and Livestock Show is the showplace for animal agricultural and animal care for Leavenworth County Livestock Producers, 4-H and FFA members. All animals and livestock shown, housed or displayed shall receive care that is humane, healthful, stress free and consistent with public expectations. Cruelty, neglect or indifference to animal comfort and welfare will not be tolerated and will constitute grounds for removal from the premises. Ample feed and clean water will be provided to all animals consistent with sound animal husbandry practices and with rules and regulations set forth by the Leavenworth County Fair Association and the Leavenworth County 4-H Council. The environment in which animals are kept will be clean and sanitary at all times. Animals experiencing illness, injury, or discomfort will be professionally attended by a veterinarian. Exhibits shall reflect the care and concern that all Leavenworth County and Kansas producers have for livestock.

4. All livestock and horses (including draft horses) are subject to inspection by the fair veterinarian and animals showing evidence of infection or contagious

diseases will be removed from the fairgrounds. The management reserves the right to inspect all livestock for the use of illegal drugs. Violators will forfeit all prizes and could be subject to criminal charges.

A. Withdrawal times for drugs, growth promotants and other approved materials: Exhibitors, their parents, leaders and instructors have a serious responsibility to use animal health aids (drugs), growth promotants and any other approved material with great care, and only when needed and in correct amounts. Approved withdrawal times are set and must be followed to assure that meat customers receive wholesome food.

B. Blood and Urine Tests: The giving of an oral or injected diuretic, growth promotant, or other medication not approved for any domestic animal constitutes an unethical practice. The Fair Board Management reserves the right to have a blood, urine and/or tissue laboratory analysis made on any animal including horses and draft horses entered in competition. An exhibitor of an animal producing an analysis with a quantity of diuretic or any unapproved or illegal medication will forfeit all prizes and premiums, and may be barred from future competition at the Leavenworth County Fair. The Grand and Reserve Grand Champion of each species and any other exhibited animal may be tested.

C. Special Rule Sheep and Goats (Scrapies): All sexually intact sheep (ewes and rams) must be identified with an official USDA premise ID tag. This includes all market ewes. All sexually intake goats (does and bucks) must be identified with an official tattoo or tag (with appropriate papers). This is per current USDA and state of Kansas regulations.

5. Livestock entered as a definite breed need not have the certificate of registration, but must show definite characteristics of that breed, the judge having the right to declare an animal not eligible to compete. This rule means that good grades of a definite breed may compete in the breed of their sire.

6. No blocking chutes in any barn at any time. Blocking chutes are not to be placed in any location blocking a road, walkway or manure disposal area. The management reserves the right to move any blocking chutes placed in an unsuitable area. Exhibitors are expected to keep blocking chutes and surrounding areas neat and clean. Blocking chutes must be removed immediately after the fair.

## HOLTON LIVESTOCK EXCHANGE

# TUESDAY LIVESTOCK AUCTION

1/2 Mile East of Holton, KS  
(785) 364-4114

[www.holtonlivestock.com](http://www.holtonlivestock.com)

Dan Harris, Owner/Manager

## DONNA KOLOJACO INSURANCE AGENCY

*Celebrating 25 years*



HOME | PERSONAL AUTO | FARM | FARM AUTO

610 Liberty Street - Oskaloosa, KS 66066

**785-863-3400**

DONNA KOLOJACO  
Owner - Agent

KRISTA BARTLETT  
CSR

Email: [djkolajaco@embarqmail.com](mailto:djkolajaco@embarqmail.com)



For all your insurance needs...

**BUCKEYE INSURANCE GROUP** Insuring the Heartland®



**WE'RE ON A MISSION.**  
To make your banking smarter, better and faster.



Agent Rewards      Agent Access      Agent Answers

**Commerce Bank**  
Member FDIC

[commercebank.com/913.682.8282](http://commercebank.com/913.682.8282)

We ask, listen and solve.

© 2012 COMMERCE BANCSHARES, INC.

**BF Goodrich**  
Tires

**Todd's Tire, LLC**  
1001 East 1st Street  
Tonganoxie, KS 66086  
913-845-3777  
Fax: 913-845-8713  
Cell: 816-392-3845  
[www.toddstire.com](http://www.toddstire.com)  
Mobile Tire Service Available

**“Michelin offers safe, fuel efficient, long-lasting tires that provide exceptional performance and extraordinary value.”**



**MICHELIN**

## OPEN CLASS

# Dairy Cattle Division D0 & Beef Cattle Division B0

## DAIRY CATTLE

### DIVISION D0

PRE-ENTRY of Livestock Exhibits is a MUST: For pre-entry instructions see pages 11-12 under “General Rules and Regulations for Exhibitors.”

Entry Fee.....50 cents per entry

## Judging/Show: 8 p.m. Thursday, Aug. 9, Show Arena

Superintendent: Rob Leach.....(913) 723-3472  
Special Rules: Lactating dairy cattle will enter the fairgrounds on Thursday, August 10 from 8 a.m. to noon. These entries will be released to leave the fairground after 11 p.m. on August 12. Stalls must be cleaned prior to the removal of these animals. No production dairy cattle will be allowed to stay on the grounds other than the show day. All other animals must enter by Tuesday, August 7, 12 noon.

Premiums: First Place: \$10; Second place, \$5; Third place, \$2.50

Open class premium checks will not be mailed. They must be picked up at the fair office.

Awards: Junior Champion female in each breed will show for Supreme Junior Champion Female and Senior Champion Female.

The Leavenworth County DHIA will award:

\$50 Cash Prize for the Supreme Junior Champion Female and \$100 Cash Award for Supreme Champion Females and Grand Champions, ribbons only at the decision of superintendent.

Classes for each Breed: Class numbers will coincide with the 4-H/FFA classes. When completing the pre-entry form, please leave class number blank. Classes are as follows:

- Junior Heifer Calf – January 1 to April 30, 2011
- Heifer Calf – September 1 to December 31, 2010
- Junior Yearling Heifer – dropped March 1 to August 30, 2011
- Senior Yearling Heifer – dropped Sept. 1, 2010 to Feb. 28, 2011
- Heifer or Cow – dropped August 30, 2010 to September 1, 2011 (2 to 3 years old)
- Aged Cow – dropped before September 1, 2008

## BEEF CATTLE

### DIVISION B0

PRE-ENTRY of Livestock Exhibits is a MUST: For pre-entry instructions see pages 11-12 under “General Rules and Regulations for Exhibitors.”

Entry forms can be found in the center pages of the catalog. Additional entry forms are available at the extension office.

Entry Fee.....50 cents per head

## Judging/Show: 9 a.m. Thursday, Aug. 9, Show Arena

Co-superintendent: Matt Yunghans, (913) 727-2386, and Bill Baragary, (913) 708-3905.

General Rules:

1. All entries are due Aug. 1, 2011. NO EXCEPTIONS! Late entries will be returned unopened.
2. 4-H and FFA who are showing their beef animals in both 4-H/FFA and open class do not need to send in open class entries for those animals by August 1st. 4-H/FFA entries are due July 12 and are automatically entered in open class. Exceptions: If 4-H/FFA member is exhibiting a beef animal in open class only (example: bull, send in entry by Aug. 1. Be sure and mark on entry form that you are exhibiting in 4-H/FFA also and note total number of beef exhibits.)
3. Open class beef entries limited to 4 animals per exhibitor.
4. Open class entry fees must be paid with entry form in advance. Fees for Beef – 50 cents per head.
5. Mail all entries and entry fees to the beef superintendent.
6. All cattle entered are to be checked in with the superintendent on Tuesday,

Please see BEEF, page 15





Photo by Shawn Linenberger

**BEEF CATTLE** hang out in the shade at the 2011 Leavenworth County Fair. The animals are a few of the many judged each year at the fair.

# BEEF CATTLE

FROM PAGE 14

August 7, 9 to 11 a.m. Entries not checked in are considered as no-shows.  
7. Wood chips are the acceptable bedding and will be provided by the exhibitor. Straw for bedding will not be allowed. Hay and feed may not be stored in or around the cattle barn.

8. There is a limited space for cattle trailer parking. The fair board requests exhibitors to share trailer for storing additional feed. All other trailers should be removed from fairgrounds.

9. Cow/Calf pairs will be exhibited on show day only. No exception. Barn space provided if available.

10. The use of portable generators for electricity on beef show day is appreciated.

11. Review general rules section.  
Special Rules: Double registered animals may show as beef or dairy, but not both. Irrespective of general fair rules and regulations no other age classes will be allowed.

Premiums: Prizes offered on all recognized beef breeds and all crossbred heifers in each classification

.....\$10.00	First Place
.....\$5.00	Second Place
.....\$2.50	Third Place

Open class premium checks will not be mailed. They must be picked up at the fair office and cashed within 30 days.

Awards: Champion Bull, Champion Market Steer, Champion Heifer — 1st and 2nd places of each class show for Champion by Breed.

Classes for each Breed:

9 — Market Steers (classes divided by weight)

10 — Dairy Steer

11 — Bull calves dropped between Jan. 1, 2012, and Feb. 28, 2012 (calves must be weaned)

12 — Bull calves dropped between Sept. 1 and Dec. 31, 2011

13 — Summer Yearling Bulls dropped between May 1 & Aug. 31, 2010

14 — Junior Yearling Bulls dropped between Jan. 1 and April 30, 2010

15 — Bulls dropped between Sept. 1 and Dec. 31, 2010

16 — Junior Heifer Calves dropped between Sept. 1 and Dec. 31, 2011

17-Senior Heifer Calves dropped between Sept. 1 and Dec. 31, 2011

18-Summer Yearling Heifers dropped between May 1 and Aug. 31, 2011

19-Junior Yearling Heifers dropped between Jan. 1 and April 30, 2011

20-Heifers that have never calved dropped between Jan. 1 and Dec. 31, 2010

Classes for Combined Breed:

21-Cow/Calf Pair

Limitations: Cows may not enter in this class more than twice (example: Cow can be entered in 2011 and 2012)

# It's Christmas in JULY!



Join now,  
Get December  
**FREE!**

Join Snap Fitness 24/7  
in the month of July  
and get December dues  
**FREE! Plus, save \$100**  
on your Enrollment Fee!

That way, you can  
spend the extra dough  
on friends and family  
during the holiday  
season!

Valid on new memberships at  
Shawnee & Basehor locations.

Offers expires July 31, 2012.

## SHAWNEE

Corner of K7 and Johnson Drive  
913.441.9496

[www.snapfitness.com/shawnee](http://www.snapfitness.com/shawnee)

Check out our new location, double  
the size of our old location. It is about  
50 yards behind our old facility and  
located directly behind Walgreens.  
We have added more equipment and  
a dedicated group training room. This  
makes the Shawnee club the largest  
Snap Fitness in the Mid-West!

## BASEHOR

Corner of State and 155th Street  
913.724.2424

[www.snapfitness.com/basehor](http://www.snapfitness.com/basehor)

We have expanded the club! You now  
have a group training room, stretching  
area and more overall space.

- No Contracts, No Gimmicks!
- Access to ALL Snap locations!
- Open 24/7 for your convenience!
- 30-Day Money Back Guarantee
- Small Group Training
- Personal Trainers for fast results!
- FREE Fast Start Package includes  
a Fitness Score Session and  
Equipment Orientation

**SNAP**  
FITNESS-24-7™  
fast • convenient • affordable



No Contracts! Open 24/7! No Contracts! Open 24/7! No Contracts! Open 24/7!



# OPEN CLASS Swine and sheep



## SWINE

### DIVISION SW

PRE-ENTRY OF LIVESTOCK EXHIBITS is a MUST: For pre-entry instructions see pages 11-12 under "General Rules and Regulations for Exhibitors"  
Entry Fee.....25 ¢ per entry  
Entries Checked in and Weighed: Monday August 8th from 5 to 10 p.m.

## Judging/Show: 6 p.m., Tuesday, Aug. 7, Show Arena

Superintendent: Dean Sheets.....(913) 723-3505  
Assistant: Gene Waters.....(913) 250-0660  
Special Rules: Exhibitors limited to 2 market and 2 breeding animals. Market hogs must have been born after Feb. 1, 2011. The fair association strongly discourages clipping of swine and will not allow clipping of swine on fairgrounds.  
Premiums: Prizes offered on all breed are:  
\$4.50 ..... First Place  
\$3.50 ..... Second Place  
\$2.00 ..... Third Place  
Open class premium checks will not be mailed. They must be picked up from the fair office.  
Classes for Each Breed:  
26 ..... -Spring Gilt  
27 ..... -Market Hog

### PEE-WEE SHOWMANSHIP

Non-competition. Participation only. Open to all those 6 years old and younger. All exhibitors will receive an award. Exhibitors may show animals belonging to another family member that already is at fair. All exhibitors will show in one class before the regular show. Return entries by July 27 to Gene Waters, 26730 New Lawrence Dr., Leavenworth, KS 66048. Judging and show coincides with Division SW.



## SHEEP DIVISION SH

PRE-ENTRY of Livestock Exhibits is a MUST: For pre-entry instructions see pages 11-12 under "General Rules and Regulations for Exhibitors"  
Entry Fee.....25¢ per entry  
Entries Checked in & Weighed: Monday, 4-5 p.m. Monday, Aug. 8.

## Market Lamb/Breeding Show/Showmanship: 7 p.m., Wednesday, Aug. 10, 2011, Show Arena

Superintendents: Oni and Jeff Hoge.....(913) 301-3080  
Junior Assistant: Lauren Hoge  
Special Rules: All sexually intact ewes and rams must be identified with an official USDA premise ID tag. This is per current State of Kansas regulations. This includes all market ewes.  
Premiums: Prizes offered on all recognized breeds are:  
..... \$4.50 First Place  
..... \$3.50 Second Place  
..... \$2.00 Third Place  
Open class premium checks will not be mailed. They must be picked up at fair office.  
Classes for Each Breed:  
30..... -Ram Lamb  
31..... -Rams, over 1 year  
32..... -Ewes, age – over 1 year  
33..... -Market Lamb, show at short fleece

**ARROW** 

PEST CONTROL **PRO**

**Protecting**  
People, Pets, and the  
Environment  
**24/7 Emergency Service**  
*Proudly Serving Customers in  
Kansas & Missouri*



415 N. Main | Tonganoxie, KS 66086 | 913-845-3400  
www.arrowpestcontrolpro.com

**BARBIE'S  
CHAMPIONSHIP TROPHIES**



ENGRAVING SERVICES AVAILABLE  
COMPANY OR PERSONAL LOGO'S  
AVAILABLE  
  
TROPHIES \* PLAQUES \* BRASS PLATES  
\* PLASTIC SIGNS \* RIBBONS \* MILITARY TAGS  
\* ENGRAVED GIFT ITEMS  
  
1918 South 4th Street, Leavenworth  
651-3323 or 1-800-878-BARB



# OPEN CLASS

## Poultry and Rabbits

### POULTRY

#### DIVISION PO

PRE-ENTRY of Livestock Exhibits is a MUST: For pre-entry instructions see pages 11-12 under "General Rules and Regulations for Exhibitors"

Entry Fee.....20¢ per entry

Entries Checked in: Tuesday, Aug. 7

From 8 a.m. to noon and 1 p.m. to 5:30 p.m.

### Judging/Show: 10 a.m. Wednesday, Aug. 8, Poultry Barn

Superintendent: Diane Larsen.....(913) 683-3291

24714 187th Street, Leavenworth, KS 66048

Special Rules: Ample room will be provided. Bring feed for birds for five days. Exhibitors are responsible for keeping pens clean. READ GENERAL RULES AND REGULATIONS. All birds going to state fair this year must be tested free of pullo-rum-typhoid by a certified blood-tester or a typhoid clean hatchery by July 29th or within 90 days of the state fair. Exhibitors must mail certificates with entries to superintendent by July 20th.

Contact the Extension office for information on licensed testers in the county. There will be a \$1.25 fee per bird for testing done on open class poultry at entry time.

Premiums: Offered on all recognized breeds.

Prizes for classes 40 through 43 are:

.....	\$1.00	First Place
.....	\$.75	Second Place
.....	\$.50	Third Place

Prizes for classes 44 through 51 are:

.....	\$1.50	First Place
.....	\$1.00	Second Place
.....	\$.75	Third Place

Open class premium checks will not be mailed. They must be picked up at fair office.

Classes

40-Standard Breeds, Large Fowl-Young Pen. One bird of either sex.

41-Standard Breeds, Large Fowl-Old Pen. One bird of either sex.

42-Standard Breeds, Bantams-Young Pen. One bird of either sex.

43.-Standard Breeds, Bantams-Old Pen. One bird of either sex.

44-Production Pullets – Pen of 3. Standard bred, crossbred or straincross pullets to be judged on egg production qualities only.

45-Production Hens – Pen of 3. Crossbred or straincross birds of the same sex to be judged on meat productions qualities only.

46-Meat Type Chickens-Pen of 3. Crossbred or straincross birds of the same sex to be judged on meat production qualities only.

47-Turkeys, all breeds- Pen, 1 bird of either sex.

48-Ducks, all breeds- Pen, 1 bird of either sex.

49-Geese, all breeds- Pen, 1 bird of either sex.

50-Pigeons, all breeds- Pen, 1 bird of either sex.

51-Pen of other poultry – 1 bird of one breed NOT LISTED ABOVE (Exhibitors may have any number of entries in this class but each entry must be a different breed)

### RABBITS

#### DIVISION RA

PRE-ENTRY of Livestock Exhibits is a MUST: For pre-entry instructions see pages 11-12 under "General Rules and Regulations for Exhibitors"



Entries Checked in: 5-9 p.m. Monday, Aug. 6 and 8 a.m.-noon Tuesday, Aug. 7

From 8 a.m. to 12:00 p.m.

Entry Fee.....20¢ per entry

### Judging/Show: 9 a.m., Thursday, Aug. 9, Rabbit Barn

Superintendent: Mary Heston.....(785) 865-6261

Special Rules:

- 1.ALL RABBITS MUST BE TATTOOED IN LEFT EAR.
- 2.May not be released until Sunday 9 a.m. to noon.
- 3.Bring Bedding, feed and water cups or crocks and must keep pans clean.
- 4.Exhibitors are responsible for clean pens.

Premiums: ..... \$1.00 First Place

.....	75¢	Second Place
.....	50¢	Third Place

Open class premium checks will not be mailed. They must be picked up at fair office.

Classes

110-Junior Bucks 3 months and under 6 months

111-Junior Doe 3 months and under 6 months

112-Intermediate Buck 6-8 months

113-Intermediate Doe 6-8 months

114-Senior Buck over 8 months

115-Senior Doe over 8 months

116-Meat Pen A recognized breed, not over 5 pounds each and not over 60 days old.

**BUTLER'S MUFFLER  
SHOP SOUTH**

- Performance Exhaust • Shocks & Struts
- Complete Brake Service • Hitches
- Full Auto Repair Service

**(913) 727-5858****SCOTT RUGGLES - OWNER**

4616 S. 4th • Leavenworth, KS 66048

**SINCE 1959**

*See You at the Leavenworth County Fair!*

**B&J**

**COUNTRY MART**

**DOUBLE COUPONS EVERYDAY**

**FULL LINE FLORAL DEPARTMENT**

**B & J Country Mart**

913-845-2949 • 24/40 & Ridge Street • Tonganoxie, KS 66086



# STORAGE BOX

Need space? Need to rent a truck?  
Need packing supplies? Need to ship a package?  
Need welding or speciality gasses?  
**The Storage Box is the Answer!**

Storage Box has been providing exceptional service and value for over 35 years. Storage Box has three locations and we are the local premier Authorized U-Haul Dealer.

Storage Box services: Self-service storage with 8 unit sizes, and outside storage for RV's, campers and boats and cars. Also, packing supplies, Prax-air welding and speciality gasses.

Storage Box also operates "The Leavenworth Shipping Depot" which is a full-service package shipping service that even offers holiday gift wrapping!

**CALL US TODAY 913-727-1236**



Across the street, across the nation, locally owned Century Van Lines provides professional moving and storage services. Whether you are moving your home, your office, your college student, or just moving a few items around, we can help.

We also offer professional packing and unpacking and nearly every type of storage solution to meet the unique needs of every customer. Call us today for a free quote or more information.

**CENTURY VAN LINES MOVING AND STORAGE**

**913-651-3600**



**OPEN CLASS**

## Goats

### GOATS

#### DIVISION GO

PRE-ENTRY of Livestock Exhibits is a MUST: For pre-entry instructions see pages 12-13 under "General Rules and Regulations for Exhibitors"

Entries Checked in: Monday, August 6, 5 to 10 p.m.

Entries Checked in and Weighed: Tuesday, August 7, 8-9a.m., Livestock Barns  
Entry Fee.....25¢ per head

**Judging/Show: 9 a.m., Wed., Aug. 8, Show Arena**

Open class registration can be mailed to:

Superintendent: Leana Leslie.....575-3710

**Milking/Goat Judging/Show: 4 p.m. OR Immediately**

**following the Beef Cattle Show Thursday, Aug. 9**

Special Rules: Lactating dairy goats will enter the fairgrounds on Thursday, August 19 from 8 a.m. to noon. These entries will be released to leave the fair-ground after 11 p.m. on August 10. Stalls must be cleaned prior to removal of these animals. No production dairy goats will be allowed to stay on the grounds other than the show day. All sexually intact does and bucks must be identified with an official tag or tattoo with appropriate papers. This is per current USDA and State of Kansas regulations.

Premiums: Prizes offered on all breeds

.....\$4.50 First Place  
.....\$3.50 Second Place  
.....\$2.00 Third Place

Open class premium checks will not be mailed. They must be picked up at fair office.

DAIRY ONLY CLASSES for each breed  
(breed name is needed)

04-Junior Doe up to 6 months  
05-Junior Doe 6 to 12 months not in milk  
06-Junior Doe 12 to 24 months not in milk  
07-Senior Doe 12 to 24 months in milk  
08-Senior Doe 24 months and older in milk  
10-Yearling Bucks up to 12 months

ALL OTHER BREEDING STOCK

(breed name is needed)

Category: Miniature (M) & Fiber (F). Please put stock in appropriate category and class. (ie, Miniature, Jr. doe born during current year would be M11). All bucks may be displayed on the day of show only.

Classes Miniature & Fiber

11-Jr Doe born current year  
12-Yearling doe not over 2 years  
13-Adult doe over 2 years  
14-Weather Goat/Market (only in fiber)  
15-Yearling buck

Breeding Chevron (Meat Chevron Only)

16-Jr Doe up to 6 months of age  
17-Jr Doe 6 to 12 months of age  
18-Yearling doe 12 to 24 months of age  
19-Adult doe 24 months or older  
20-Yearling buck  
21-Market Chevron



## OPEN CLASS

# Field crops, horticulture and honey

## Field Crops, Horticulture and Honey

### DIVISION C

Superintendent: Jason Ernzen, (913) 727-3980

Entries accepted Tuesday, August 7th  
from 1 to 4 p.m., Green Metal Building

25¢ per entry

## Judging starts at 5 p.m. Wednesday, Aug. 7

Special Rules: Exhibitors may have one entry per class

Field crops

Premiums: .....	\$2.00	First Place
.....	\$1.50	Second Place
.....	\$1.00	Third Place

Open class premium checks will not be mailed. They must be picked up at fair office.

### FIELD CROP CLASSES:

CORN .....	11 – White or Yellow (ten ear exhibit)
SORGHUM .....	15 – Hybrid grain sorghum (ten head exhibit)
.....	16 – Hybrid forage sorghum (ten head exhibit)
WHEAT .....	20 – One gallon sample
ALFALFA .....	22 – One gallon sample of seed
RED CLOVER .....	23 – One gallon sample of seed
BROME GRASS .....	24 – One gallon sample of seed
HAY .....	Exhibit to consist of one flake or slice from a rectangular bale, or 10 inch section cut from a round bale. The flake or slice should be approximately 6 inches in thickness and tied in two directions.
25 .....	– Alfalfa
26 .....	– Red Clover
27 .....	– Prairie
28 .....	– Brome Grass
29 .....	– SOYBEANS – Bundle of three plants

## HORTICULTURE – VEGETABLES

Premiums for garden display are:

.....	\$3.00	First Place
.....	\$2.50	Second Place
.....	\$1.00	Third Place

### 35 – GARDEN DISPLAY

Exhibit consists of 5 different fresh vegetables. Canned vegetables are not accepted. Only one variety of a specific vegetable may be exhibited. The names of the 5 vegetables to be exhibited are:

Large Vegetables: (one each) watermelon, squash, pumpkin, eggplant, cabbage, cantaloupe, etc.

Medium Vegetables: (5 each) cucumbers, carrots, beets, tomatoes, onions, peppers, parsnips, okra, Irish potatoes, sweet potatoes, etc.

Small Vegetables: (approx. one dozen) Green beans, etc.

Premiums: for other vegetable exhibits, fruit and honey are:

.....	\$2.00	First Place
.....	\$1.50	Second Place
.....	\$1.00	Third Place

Open class premium checks will not be mailed. They must be picked up at fair office.

- 40 – Plate of 5 tomatoes
- 41 – Plate of 5 cherry tomatoes
- 42 – Plate of 5 red potatoes
- 43 – Plate of 5 white potatoes
- 44 – Plate of 5 sweet potatoes
- 45 – Plate of 5 white onions
- 46 – Plate of 5 yellow onions
- 47 – Plate of 5 red onions
- 48 – Plate of 12 beans, green snap
- 49 – Plate of 12 beans, yellow wax
- 50 – Plate of 5 table beets
- 51 – Plate of 5 carrots
- 52 – One eggplant
- 53 – Plate of 5 peppers, bell
- 54 – Plate of 5 peppers, hot
- 55 – Plate of 5 peppers, sweet
- 56 – Plate of 5 turnips

- 57 – One watermelon
- 58 – One pumpkin
- 59 – One cantaloupe
- 60 – Plate of 5 cucumbers
- 61 – Plate of 5 okra
- 62 – One squash, summer
- 63 – One squash, winter
- 64 – One squash, zucchini
- 65 – Other vegetable (follow size guidelines above for number of specimens to exhibit)

## HORTICULTURE – FRUITS

- 66 – Plate of 5 apples (any variety)
- 67 – Plate of 5 pears (any variety)
- 68 – Plate of 5 peaches (white)
- 69 – Plate of 5 peaches (yellow)
- 70 – One small basket white grapes
- 71 – One small basket blue grapes

## HORTICULTURE – HONEY

- 80 – Liquid Honey – Light color exhibited in 2 lb. Queen Line jars, three two-pound jars to each entry.
- 81 – Liquid Honey – Dark color exhibited in 2 lb. Queen Line jars, three two-pound jars to each entry.
- 82 – Chunk Honey - exhibited in 2 lb. Queen Line jars, three two-pound jars to each entry.
- 83 – Cut or section comb honey, three combs or sections to each exhibit. Cut comb is to be approx. 4" x 4" packed in commercial trays or plastic boxes. Section combs are to be approx. 4 1/2" x 4 1/2" or 4" x 5" packed in cardboard



507 N. Union  
McLouth, KS 66054  
(888) 796-6111  
www.ljec.coop

*"Owned by Those  
We Serve"*

**Serving Our Member-Owners in  
Northeast Kansas Since 1946**

## EAGLE MEMORIALS

Granite & Bronze Markers  
Benches, Signs, Address &  
Yard Rocks  
*Buy direct from Mfg.*

www.eaglememorials.com  
Visit our displays located at  
327 West Street, Tonganoxie

### Lawrence

Phone: 785-331-7400  
Cell: 816-803-1942

### Tonganoxie

Shop: 913-369-9453  
Fax: 913-369-2447





## OPEN CLASS

# Home Economics

### Home Economics

(LOCATED ON WEST END OF ADMINISTRATIVE BLDG)

Superintendents: Ferry Evans, (913) 845-2405 and Barbara Kramer, (913) 796-6141.

### Judging begins at 10 a.m. Tuesday, Aug. 7

General Rules: 25 ¢ per entry. You may pick up entry cards at FIRST STATE BANK or courthouse annex in Tonganoxie or at the EXTENSION OFFICE in Leavenworth.

Entry Time:

- Monday, 6:30 to 8:30 p.m.
- Tuesday, 8 to 9 a.m.

ALL ENTRY CARDS MUST BE FILLED OUT AND ATTACHED TO ITEM BEFORE COMING TO ENTRY TABLES. (NO EXCEPTIONS)

Release Time:

- Saturday, 9-10 p.m.
- Sunday, 9-11 a.m.

General Rules:

1. Premium competition is open to Leavenworth County and surrounding counties.
2. Premiums are paid only on classes as listed.
3. Entry fee is \$.25 per entry.
4. Entry cards may be picked up at the First State Bank, the courthouse annex in Tonganoxie, the County Extension Office in Leavenworth, the Tonganoxie Library or at the fair during entry times.
5. Entry card must be filled out in its entirety prior to going to the entry table.
6. Exhibitors are limited to one entry per class, except where noted otherwise.
7. Unauthorized use of copyright materials, such as Disney, cartoon characters or sports logos, is not permitted.
8. All entries will be divided into three age groups:  
S – Senior Citizen, age 60 or over  
A – Adult age 17 – 59  
Y – Youth, age 16 and under (state age)  
Mark appropriate age group on entry card.  
Example: 100-S, 100-A, 100-Y (8)
9. The bottom part of the entry card is your receipt and MUST be presented when

picking up your entry.

10. First, second and third-place ribbons are awarded in each class in each age group. Ribbons are awarded on merit. The judge reserves the right to withhold awards if entries are not deserving of recognition.

11. Special award ribbons are awarded at the judge's discretion.

12. No entries will be released before 9:00 p.m. on Saturday – NO EXCEPTIONS!

13. Any exhibit left after 11 a.m. Sunday will become the property of the Open Class Home Economics Department. There is no post fair pick-up point.

14. Every precaution will be taken to ensure the safety of all entries, but in no case will management be responsible for the loss or injury to same.

15. Please check each department for additional special rules.

16. Open class checks must be picked up in the fair office. They will not be mailed.

### CLOTHING, TEXTILES & NEEDLE ARTS

Superintendent: Nancy Wood.....(913) 683-4527

Entry Time:

- Monday, 6:30 to 8:30 p.m.
- Tuesday, 8 to 9 a.m.

Entries Released: .....

- Saturday, 9 to 10 p.m.
- Sunday, 9 to 11 a.m.

NO EXCEPTIONS

### Judging begins 10 a.m. Tuesday, Aug. 7

Special Rules:

1. Please read Home Economics General Rules on this page.
2. Entry must have been completed in the last two years.
3. Quilts may be entered in two classes: once for the piecing and once for the quilting.

Please see CLOTHING & TEXTILES AND NEEDLE ARTS, page 21

## Coleman Equipment



Kubota®



**Coleman Equipment**

Your local authorized Kubota dealer

Sales • Rental • Service • Parts • Tools

24000 W 43rd St., Bonner Springs, Ks 66012

(913) 422-3040 • [www.Colemanequipment.com](http://www.Colemanequipment.com)



[Facebook.com/colemanequip](https://www.facebook.com/colemanequip)

[Twitter.com/colemanequip](https://twitter.com/colemanequip)



**Quality, Innovation and Value from Kubota**



## OPEN CLASS

# Clothing, Textiles and Needle Arts

FROM PAGE 20

4. Entry should be in good condition, clean and ready for exhibit.

5. If an article is an original design, please note by adding "O" to the entry card- example: 140A-(O). Attach a brief note describing how you got your idea.

Premiums: .....\$1.50 First Place  
.....\$1.25 Second Place  
.....\$1.00 Third Place

Open class premium checks will not be mailed. They must be picked up at fair office.

### NEEDLEWORK, EMBROIDERY AND COUNTED CROSS STITCH

- 100 Picture (other than counted cross stitch)
- 101 Pillow (stuffed)
- 102 Pillow Cases
- 103 Towels
- 104 Multiple Item (set)
- 105 Table or Lunch Cloth
- 106 Napkins
- 107 Scarf or Runner
- 108 Needlepoint
- 109 Crewel
- 110 Hardanger
- 111 Ribbon
- 112 Shadow
- 113 Beaded (other than counted cross stitch)

- 114 Smocked Item
- 115 Sampler (combination of stitches)
- 116 Waste Canvas
- 117 Counted Cross Stitch (11 count & under)
- 118 Counted Cross Stitch (14-17 count)
- 119 Counted Cross Stitch (18-27 count)
- 120 Counted Cross Stitch (28 count & above)
- 121 Counted Cross Stitch (embellished)
- 122 Embroidered Doll/Toy (stuffed)

### KNITTING & CROCHETING

- 126 Tatting
- 127 Pillow (stuffed)
- 128 Edging or insertion
- 129 Zilet Crochet
- 130 Infant or Doll Clothing
- 131 Toy or Accessory
- 132 Thread (multiple item – set)
- 133 Thread Small (13" & under)
- 134 Thread Medium (up to 20")
- 135 Thread Large (up to 36")
- 136 Thread X-Large (over 36")
- 137 Afghan (ripple, shell)
- 138 Afghan (granny square)
- 139 Afghan (stitch w/ embroidery or work in design)
- 140 Afghan (2 or more threads)
- 141 Afghan (other full size)
- 142 Afghan (crib, nursery)
- 143 Yarn Small (13" and under)
- 144 Yarn Medium (14"-25")
- 145 Yarn Large (26"-36")

- 146 Yarn X-Large (over 36")
- 147 Yarn – Multiple item (set)
- 148 Yarn (over 36")
- 149 Constructed item (i.e. sweater)
- 150 Other knit or crocheted item not listed

### QUILTS

- 200 Hand Applique Top
- 201 Machine Applique Top
- 202 Hand Embroidered Top
- 203 Machine Embroidered Top
- 204 Hand Pieced Top
- 205 Machine Pieced Top
- 206 1 Hand Pieced Block
- 207 1 Machine Pieced Block
- 208 Comforter
- 209 Hand Quilting
- 210 Hand Quilting by more than one person
- 211 Machine Quilting
- 212 Multi-Media
- 213 Miniature
- 214 Crib, Nursery, Lap
- 215 Wall Hanging, Table Runner
- 216 Placemats, other multiple item
- 217 Garment
- 218 Wearable Art
- 219 Part Antique
- 220 Other Quilting item not categorized
- 221 Your First Quilt
- 222 Unfinished Quilt
- 223 Embellished Quilt

- 224 T-Shirt Quilt
- 225 Crazy quilt

### FASHION CONSTRUCTION

- 250 Dress
- 251 2 or 3 Piece Suit
- 252 Coat or Jacket
- 253 Skirt
- 254 Blouse or Shirt
- 255 Pants, Slacks, Jeans, Shorts
- 256 Lounge or Night Wear
- 257 Sweatshirt or T-Shirt
- 258 Child's Garment
- 259 Doll Clothing
- 260 Vest
- 261 Fashion Accessories
- 262 Wearable Art
- 263 Formal or Gown
- 264 Smocking
- 265 Costume
- 266 Other Fashion Item not categorized

### RECLAIMED TEXTILES

- 270 Wall Hanging
- 271 Rug
- 272 Home Accessories
- 273 Toys
- 274 Wearable Item
- 275 Other

Please see ARTWORK, page 22



**Fair principles  
are rich in history,**  
*much like our dedication and service  
to Leavenworth County Residents!*

### Services include:

Online Banking 24/7  
Checking Savings Money Market CD's  
Home Loans, Car & Personal Loans



Leavenworth  
5151 S. 4th St.  
913-727-1040

Basehor  
15500 State Ave.  
913-724-2050

Downtown  
312 South 5th St.  
913-682-3232



Visit us online for complete services [www.citizensfsb.com](http://www.citizensfsb.com)

TRUSTED FROM GENERATION TO GENERATION



OPEN CLASS

Artwork and Photographs

TRADITIONALLY HOOKED  
ARTICLES

- 280 Tapestry
- 281 Primitive
- 282 Wall Hanging
- 283 Other Item Not Listed

CHRISTMAS

ALL OF THE NEEDLE ARTS

- 800 Ornament
- 801 Stocking
- 802 Mantel Scarf or Table Runner
- 803 Tree Skirt
- 804 Picture
- 805 Quilted item
- 806 Garment
- 807 Accessory
- 808 Doll
- 809 Holiday Other Than Christmas

ART & PHOTOS

Art Superintendent:  
Cory Thompson.....(913) 526-3008  
Photography Superintendent:  
Denise Baker .....(913) 449-9445  
Entry Time:  
MONDAY.....6:30 to 8:30 p.m.  
TUESDAY.....8 to 9 a.m.  
Entries Released:  
SATURDAY.....9 to 10 p.m.

SUNDAY.....9 to 11 a.m.

Judging begins 10 a.m.  
Tuesday, August 7, 2011

Special Rules:  
1. Please read Home Economics General Rules, page 23.  
2. All paintings, drawing and photographs MUST BE mounted and framed with secure tabs (or wire across the back) for hanging or they will BE DISQUALIFIED.  
3. All pictures and photos must have exhibitors name and address on back.  
4. Subject matter must be original (no use of copyright material).  
5. Pictures/photos must have been completed in the last two years.  
6. Amateur entries only, please.  
Premiums:  
\$1.50 ..... First Place  
\$1.25 ..... Second Place  
\$1.00 ..... Third Place  
Open class premium checks will not be mailed. They must be picked up at fair office.

ARTWORK – ACRYLIC

- 301 Abstract
- 302 Landscape
- 303 Action
- 304 Still Life
- 305 Formal
- 306 Floral
- 307 Animal
- 308 Other

ARTWORK – WATERCOLOR

- 309 Abstract
- 310 Landscape
- 311 Action
- 312 Still Life
- 313 Portrait
- 314 Floral
- 315 Animal
- 316 Other
- 317 Street Scene
- 318 Seascape

ARTWORK – OIL

- 320 Abstract
- 321 Landscape
- 322 Action
- 323 Still Life
- 324 Portrait
- 325 Floral
- 326 Animal
- 327 Other

ARTWORK – PEN & INK

- 330 Abstract
- 331 Landscape
- 332 Action
- 333 Still Life
- 334 Portrait
- 335 Animal
- 336 Other

ARTWORK – PENCIL

- 340 Abstract
- 341 Landscape
- 342 Action
- 343 Still Life
- 344 Portrait
- 345 Animal
- 346 Other

ARTWORK – PASTEL/CHARCOAL

- 360 Abstract
- 361 Landscape
- 362 Action
- 363 Still Life
- 364 Floral
- 365 Animal
- 365A Portrait
- 366 Other

ARTWORK – OTHER MEDIA

- 350 Color Marker
- 351 Tube Ball Point
- 352 Paint by Number
- 353 Colored Pencil
- 354 Crayon Work (youth)
- 355 Finger Paint (youth)
- 367 Scratchboard
- 368 Silk Screen
- 369 String or Wire Art
- 370 Collage

- 371 Decoupage
- 372 Glass Etching
- 373 Lithograph
- 374 Plaque
- 375 Mixed Media
- 376 Mixed Media & Glass
- 377 Computer-Generated Art
- 378 Animal
- 379 Other

PHOTOGRAPHS – COLOR

- 380 Landscape
- 380A Cloudscape
- 381 Action
- 382 Still Life
- 382A Architectural
- 383 Portrait
- 384 Special Effects
- 385 Animal
- 385A Birds
- 386 Sequence up to 4
- 387 Flowers
- 388 Wildlife
- 389 Mixed Garden
- 390 Other

PHOTOGRAPHS – BLACK & WHITE

- 390A Landscape
- 391 Action
- 392 Still Life
- 393 Portrait
- 394 Others
- 395 Old Photograph Restored
- 396 Animal
- 396A Birds
- 397 Special Effects
- 398 Sequence up to 4
- 399 Flowers
- Photographs – Digitally Enhanced

PHOTOGRAPHS – BLACK & WHITE

- 400 Landscape
- 401 Action
- 402 Still Life
- 403 Portrait
- 404 Animal
- 404A Birds
- 405 Special Effects
- 406 Flowers
- 407 Other



**McGraw  
Fertilizer  
Service, Inc.**

**Bulk Fertilizer •  
Custom Spraying •  
Chemicals •  
Anhydrous Ammonia •  
Agricultural Lime •  
Lawn Fertilizer •  
Starter Fertilizer •  
Weed & Feed •**

**Box 464 • Tonganoxie KS 66086  
PHONE: (913) 845-2598 • FAX (913) 845-2055**



**DON'T FORGET TO VISIT  
WWW.LEAVENWORTHCOUNTYFAIR.COM  
FOR AN INTERACTIVE GUIDE  
TO THIS YEAR'S FAIR!**

Plus, find us on Facebook and Twitter  
for contests and giveaways!

 @LeavFair  
 facebook.com/LeavenworthCountyFair



# OPEN CLASS Crafts

FROM PAGE 25

## PHOTOGRAPHS – DIGITALLY ENHANCED

- 400 Landscape
- 401 Action
- 402 Still Life
- 403 Portrait
- 404 Animal
- 405 Special Effects
- 406 Flowers
- 407 Other

## CRAFTS

Superintendent: Susy Ross, (913) 845-2477  
Entry Time:  
MONDAY.....6:30 to 8:30 p.m.  
TUESDAY.....8 to 9 a.m.  
Entries Released:  
SATURDAY.....9 to 10 p.m.  
SUNDAY.....9 to 11 a.m.

## Judging Begins 10 a.m. Tuesday, Aug. 9

Special Rules:  
1. Please read Home Economics General Rules, page 23.  
2. All crafts must be completed (rugs should be bound, etc.)  
3. All items must have been made in the last two years  
4. Kits are permitted  
5. If an article is an original design please not by adding "O" to the entry card; ie: 140-A(O). Attach a brief note describing how you got your idea.  
Premiums:  
\$1.50.....First Place  
\$1.25.....Second Place  
\$1.00.....Third Place  
Open class premium checks will not be mailed. They must be picked up at fair

- office.
- 400 Artificial Flowers – handmade
  - 401 Artificial Flowers – in a craft
  - 402 Basket with handle
  - 403 Basket without handle
  - 404 Bead Work
  - 405 Bird Houses
  - 406 Candle Making
  - 407 Clay – on wheel, polymer, etc.
  - 408 Cement/Plaster
  - 409 Decoupage
  - 410 Dough Art
  - 411 Dolls – Handmade
  - 412 Embellishing a bought item
  - 413 Fabric Crafts (fabric, foam, fur, etc.)
  - 414 Glass Crafts
  - 415 Holiday Craft – Christmas
  - 416 Holiday Craft – Easter
  - 417 Holiday Craft – Halloween
  - 418 Holiday Craft – Thanksgiving
  - 419 Holiday Craft – Valentines
  - 420 Holiday Craft – Other
  - 421 Jewelry
  - 422 Latch Hook
  - 423 Leather (laced, stamping, constructions, etc.)
  - 424 Lego, Imagination
  - 425 Lego, Kit
  - 426 Metal Craft (copper, tin, etc.)
  - 427 Machine Embroidery
  - 428 Miniatures
  - 429 Model Kits
  - 430 Natural Material Crafts
  - 431 Painting (on an item, not a picture)
  - 432 Paper Craft (includes origami)
  - 433 Plastic Canvas Needlework
  - 434 Recycled Material Craft
  - 435 Soap Making
  - 436 Stamping
  - 437 Weaving, not a basket
  - 438 Wood Burning
  - 439 Wood Carving (relief, in the round, etc.)
  - 440 Wood Working
  - 441 Wooden Toy
  - 442 Scrapbooking
  - 443 Cookbook
  - 444 Other

# Frequently asked questions

Every year the Fair Office receives many questions about the fair. Below is a list of some of the most frequently asked questions. The Fair Catalog is full of information. Obviously, we can't cover everything in this short column. If you have questions about a specific event please contact the person listed in the catalog. If you have additional questions please contact a Fair Board member. In the front of this catalog is a complete list of all the members of the Fair Board. More FAQs on page 25.

## How much does it cost to attend the fair?

There is no admission fee to the fair. There is a \$2 charge for parking. There is an admission for the Mud Run, Demolition Derby and some Grandstand events.

## How do I get a booth at the fair?

Contracts for booth space are mailed in the spring, usually around April / May. If you had a booth the previous year you will automatically receive a contract. If you are a new exhibitor you need to contact a fair board representative or Mike or Tammy Kissinger 913-845-2639. For all food vendors: Jane Turner 913-727-6666.

## How much does a booth cost?

Booth space inside the administration building is \$150 for a 10 x 10 area. Outside is \$150 per 10 feet of frontage.

## What is the official publication of the fair?

The Tonganoxie Mirror prints and distributes the official fair catalog. The Mirror is the only paper officially authorized by the Leavenworth County Fair Association to sell advertisements in the Fair Catalog.

## I hear business names being announced during the Mud Run and Demolition Derby. What is this for?

Those businesses being announced are sponsors of the events. They have donated either equipment or funds to the Fair Board to help defray the cost of the event.





# COMMUNITY National Bank

"Community Minded...Community Strong"

Member  
**FDIC**

Tonganoxie - Basehor

[www.communitynationalbank.net](http://www.communitynationalbank.net)



**Just like in 4-H, Head, Heart, Hands and Health  
are all an important part of success.  
From the Heads of the Professional staff,  
to putting their Hearts and Hands back in to the Community,  
makes for a strong, Healthy financial institution.  
That's why Community National Bank has been so successful.**

**Congratulations to all members of 4-H and their leaders**

- \* **Mobile Banking**
- \* **E-Statements**
- \* **On-Line Bill Pay**
- \* **E- Alerts**
- \* **Transfer Funds**
- \* **Account access 24/7**
- \* **On-Line Mortgage Applications**
- \* **Free Debit Card**



PRE-ENTRY FORM

2012 Leavenworth County Fair - Tonganoxie, Kansas

OPEN CLASS  
LIVESTOCK

DIVISION:

Name:

Address:

Enter only one division on each blank. Fill out all information, completely printed or typewritten.  
**ALL ENTRIES DUE JULY 25, 2012 - NO EXCEPTIONS.** Late entries will be returned unopened. Entry fees must be paid with entry form. No refunds. Make checks payable to: Leavenworth County Fair Association. Mail to appropriate division superintendent.

Class no.	Description	Breed	Date of Birth	No. of Animals

PRE-ENTRY FORM

2012 Leavenworth County Fair - Tonganoxie, Kansas

OPEN CLASS  
LIVESTOCK

DIVISION:

Name:

Address:

Enter only one division on each blank. Fill out all information, completely printed or typewritten.  
**ALL ENTRIES DUE JULY 25, 2012 - NO EXCEPTIONS.** Late entries will be returned unopened. Entry fees must be paid with entry form. No refunds. Make checks payable to: Leavenworth County Fair Association. Mail to appropriate division superintendent.

Class no.	Description	Breed	Date of Birth	No. of Animals

PRE-ENTRY FORM

2012 Leavenworth County Fair - Tonganoxie, Kansas

CAMPER  
REGISTRATION

Name:

Phone:

Address:

City: State: Zip:

**FEE:**  
\$90.00 for campers  
\$120 for camper w/ slide-out  
\$10.00 for tent

**MAIL COMPLETE APPLICATION TO:**  
Nancy McDougal  
23630 147th St, Leavenworth, KS 66048  
Home Phone: 913-727-6465

☐ Camper w/ slide-out \_\_\_\_\_ ft.    Slide-out one side ☐    both sides ☐

Fee must be sent with application. Applications not accepted will be returned.

**CHECK OR MONEY ORDERS ONLY - INSUFFICIENT CHECKS CHARGE \$30**

Limited to the first 60 and

**MUST BE A LIVESTOCK EXHIBITOR OR LIVESTOCK SUPERINTENDENT.**

Applications will be screened against entries. No alcoholic beverage allowed on fairgrounds. Lights out at 12:00 midnight policy in general rules section will be enforced. All minors must be at camp site or in campers by midnight. Leavenworth County Sheriff's Department will enforce.  
**ALL CAMPERS MUST HAVE LEGAL GUARDIAN OR PARENT STAYING IN THE CAMPER.** Any camper unsupervised may be asked to leave at the discretion of the fair board.

I hereby acknowledge that I am a livestock exhibitor and have read the terms of the application and will comply with all Fair Association Rules.

Legal Guardian

Exhibitor



# Frequently asked questions, part 2

## What are the rules for the parade?

1. Absolutely no throwing of candy from floats or vehicles. This is a violation of Tonganoxie city ordinance.
2. No three wheelers, go carts, mini bikes or dirt bikes will be allowed to be driven in the parade.
3. Fire Departments are encouraged to participate, however they will be limited to one vehicle per department.
4. Parents are responsible for their children! If you put your child on a float, you are responsible for making arrangements with the driver of that float for picking up your child after the conclusion of the parade.
5. The parade chairman and the Leavenworth County Fair board reserve the final and absolute right to interpret its rules and arbitrarily settle and determine all matters connected with the fair, including the parade.

## How do I, or my business, become a sponsor?

Sponsorships are always needed and welcomed for a wide variety of events held during the county fair. If you wish to contribute to the rodeo, demolition derby, live entertainment, turtle races, or any other events contact the Fair Board. If you are interested in sponsoring something specifically for the 4-H or FFA exhibitors, contact the Leavenworth County Extension Office.

## I would like to volunteer at the fair. What do I do?

Volunteers are needed in all areas of the fair. Contact a fair board member and we will put you in contact with the appropriate person for your area of interest.

## How do I get into the annual parade?

On this page and page 26 are entry sheets with rules and contact information.

## Who makes the rules for the parade?

The superintendent of the parade is Bill Seymour. He is the official representative of the Fair Board. The rules are made through a cooperative effort with the Tonganoxie Police Department, Leavenworth County Sheriff and the Fair Board. Those entities reserve the right to interpret and enforce all rules.

## How do I make a suggestion or comment about the fair?

The Fair Board meets the 3rd Monday of every month, with the exception of August, at 8 PM in the Administration Building. These meetings are open to the public. If you wish to be put on the agenda, or if you are unable to attend but wish to make a comment, contact Fair Board President Mike Johnson (913) 269-6329.

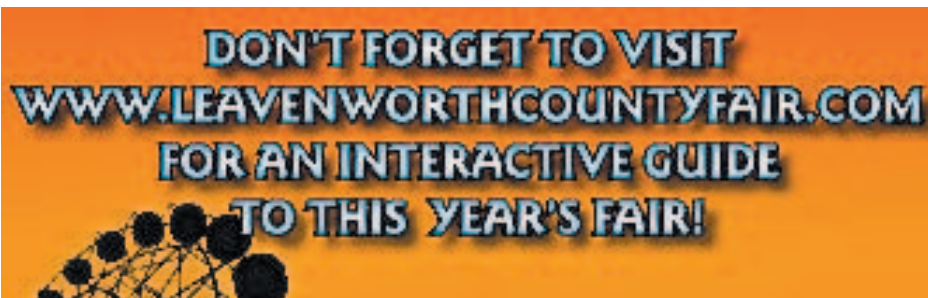

### PRE-ENTRY FORM

2012 Leavenworth County Fair - Tonganoxie, Kansas

## DEMOLITION DERBY

Friday, August 10, 6:30 p.m., Grandstand



Name: \_\_\_\_\_  
 Address: \_\_\_\_\_  
 City: \_\_\_\_\_ State: \_\_\_\_\_ Zip: \_\_\_\_\_  
 Make: \_\_\_\_\_ Model: \_\_\_\_\_ Year: \_\_\_\_\_  
 Car Number: \_\_\_\_\_

**Send Entry Form and \$35 Entry Fee to:**  
 Barney Farr  
 1707 Pawnee Ct.,  
 Leavenworth, KS 66048

For more information  
 contact Barney Farr at  
 913-758-1337.

### PRE-ENTRY FORM

2012 Leavenworth County Fair - Tonganoxie, Kansas

## Longest Married Couple in Leavenworth County



Name: \_\_\_\_\_  
 Date of Marriage: \_\_\_\_\_  
 Address: \_\_\_\_\_  
 City: \_\_\_\_\_ State: \_\_\_\_\_ Zip: \_\_\_\_\_

**Entry Due:**  
 August 7th, 2012

**Send to:**  
 Bill Seymour  
 305 East 2nd Street  
 Tonganoxie, KS 66086  
 Bill 913-449-8012  
 Karen 913-645-9982

**Prizes:**  
 Gift Certificate,  
 Dinner for Four, Flowers,  
 or Honored in Parade

### PRE-ENTRY FORM

2012 Leavenworth County Fair - Tonganoxie, Kansas

## PHOTOS of the Fair Contest

Sponsored by the Leavenworth County Fair Board



Entrants Name: \_\_\_\_\_  
 Address: \_\_\_\_\_  
 City: \_\_\_\_\_ State: \_\_\_\_\_ Zip: \_\_\_\_\_  
 Photo Category: \_\_\_\_\_

Photos can be any size snapshot. Does not need  
 frame, mounting, or mat but must have been taken  
 at the Leavenworth County Fair.

**Entries Due:**  
 August 7th, 2012, 6:00 p.m.  
 at the Administration Bldg.,  
 Fairgrounds.  
**Judging:** 7:00 p.m.  
**On Exhibit:** August 7-11  
 Administration Bldg.

**Prize Categories:**  
 Oldest Photo 1949-1970  
 1926-1948 1971-Present

### PRE-ENTRY FORM

2012 Leavenworth County Fair - Tonganoxie, Kansas

## FAIR PARADE

Tuesday, August 7th, 2012 6:30 p.m.



Name: \_\_\_\_\_  
 Address: \_\_\_\_\_  
 City: \_\_\_\_\_ State: \_\_\_\_\_ Zip: \_\_\_\_\_  
 Type of Entry: \_\_\_\_\_

**Entry Due:**  
 August 5th, 2011

**Send to:**  
 Bill Seymour  
 305 East 2nd Street  
 Tonganoxie, KS 66086  
 Bill 913-449-8012  
 Karen 913-645-9982

Fill out all information completely  
 (printed or typewritten) and one  
 division on each parade blank.



PRE-ENTRY FORM

2012 Leavenworth County Fair - Tonganoxie, Kansas

# FAIR PARADE

Tuesday, August 7th, 2012 6:30 p.m.



**Entry Due:**  
August 3th, 2012

**Send to:**  
Bill Seymour  
305 East 2nd Street  
Tonganoxie, KS 66086  
Bill 913-449-8012  
Karen 913-645-9982

Name: \_\_\_\_\_

Address: \_\_\_\_\_

City: \_\_\_\_\_ State: \_\_\_\_\_ Zip: \_\_\_\_\_

Type of Entry: \_\_\_\_\_

Fill out all information completely  
(printed or typewritten) and one  
division on each parade blank.

PRE-ENTRY FORM

2012 Leavenworth County Fair - Tonganoxie, Kansas

# PHOTOS of the Fair Contest

Sponsored by the Leavenworth County Fair Board



**Entrants Name:** \_\_\_\_\_

**Address:** \_\_\_\_\_

**City:** \_\_\_\_\_ **State:** \_\_\_\_\_ **Zip:** \_\_\_\_\_

**Photo Category:** \_\_\_\_\_

Photos can be any size snapshot. Does not need  
frame, mounting, or mat but must have been taken  
at the Leavenworth County Fair.

**Entries Due:**  
August 7th, 2012, 6:00 p.m.  
at the Administration Bldg.,  
Fairgrounds.

**Judging:** 7:00 p.m.

**On Exhibit:** August 7-11  
Administration Bldg.

**Prize Categories:**  
Oldest Photo 1949-1970  
1926-1948 1971-Present

PRE-ENTRY FORM

2012 Leavenworth County Fair - Tonganoxie, Kansas

# Longest Married Couple in Leavenworth County



**Entry Due:**  
August 7th, 2012

**Send to:**  
Bill Seymour  
305 East 2nd Street  
Tonganoxie, KS 66086  
Bill 913-449-8012  
Karen 913-645-9982

Name: \_\_\_\_\_

Date of Marriage: \_\_\_\_\_

Address: \_\_\_\_\_

City: \_\_\_\_\_ State: \_\_\_\_\_ Zip: \_\_\_\_\_

**Prizes:**  
Gift Certificate,  
Dinner for Four, Flowers,  
or Honored in Parade

PRE-ENTRY FORM

2012 Leavenworth County Fair - Tonganoxie, Kansas

# DEMOLITION DERBY

Friday, August 10, 6:30 p.m., Grandstand



Name: \_\_\_\_\_

Address: \_\_\_\_\_

City: \_\_\_\_\_ State: \_\_\_\_\_ Zip: \_\_\_\_\_

Make: \_\_\_\_\_ Model: \_\_\_\_\_ Year: \_\_\_\_\_

Car Number: \_\_\_\_\_

**Send Entry Form and  
\$35 Entry Fee to:**  
Barney Farr  
1707 Pawnee Ct.,  
Leavenworth, KS 66048

For more information  
contact Barney Farr at  
913-758-1337.

## OPEN CLASS

# Foods

## FOODS DEPARTMENT

Supt.: Starla Jones (913) 845-3995  
Entry Time:  
MONDAY.....6:30 to 8:30 p.m.  
TUESDAY.....8 to 9 a.m.  
Entries Released:  
SATURDAY.....9 to 10 p.m.  
SUNDAY.....9 to 11 a.m.

## Judging begins 10 a.m.

## Tuesday, Aug. 7

Y – Youth – to age 16;  
A – Adult – ages 17 to 59  
SC – Senior Citizens 60 years & older.

Special Rules:

1. Read Home Economics general rules on page 23.
2. Exhibits shall be on cardboard or stiff paper plates and slipped into a clear plastic bag and fastened with a wire twist or zip bag, except cakes. Cakes will be on a covered cardboard or plate.
3. All entries must be whole products. No half cakes, etc.
4. Fair personnel are not responsible for entries after 11 am Sunday.
5. Food items will be sold on Tuesday at 3 p.m. Anyone wishing to take their pie, cake, or bread home must say so when entering and pick up by 3 p.m. Tuesday before the sale.
6. One cookie, one section of cake, pie or bread will be left for display. Profits from the food items sale will be used for improvements of the home economics exhibit areas. Decorated cakes will not be sold.
7. If entering more than 5 food entries, must furnish a list of items and classes.

Premiums for all classes:..

\$1.50.....	First Place
\$1.25.....	Second Place
\$1.00.....	Third Place

Open class premium checks will not be mailed. They must be picked up at fair office. Special awards for yeast breads using Red Star Yeast. Please attach empty yeast package to entry.

## YEAST BREADS

500 White Bread  
501 Whole Wheat Bread  
502 Rye Bread  
503 Multi-grain Bread  
504 Raisin Bread  
505 Sourdough Bread  
506 French Bread  
507 Cinnamon Rolls (4)  
508 Whole Wheat Rolls (4)  
509 Light Rolls (4)  
510 Sweet Rolls (4)  
511 Coffee Cake  
512 Tea Ring  
513 Machine Yeast Bread  
514 Ethnic Bread

## QUICK BREADS

520 Vegetable Quick Bread  
521 Fruit Quick Bread  
522 Plain Quick Bread  
523 Coffee Cake  
524 Cinnamon Rolls (4)  
525 Muffins (4)  
526 Baking Powder Biscuits (4)  
527 Machine Quick Bread  
528 Nut Quick Bread

## WHOLE CAKES

535 Dietetic Cake – include recipe  
536 Angel Food (w/ or w/o frosting)  
537 Chiffon (w/ or w/o frosting)  
538 Sponge (w/ or w/o frosting)  
539 Chocolate or Devils Food (frosted)

540 Bundt Cake (frosted or unfrosted)  
541 Burnt Sugar Cake (frosted)  
542 German Chocolate Layer Cake (frosted)  
543 White or Butter Layer Cake (frosted)  
544 Spice Cake  
545 Vegetable Cake  
546 Fruit Cake  
547 Gingerbread Cake  
548 Cup Cakes (4)  
549 Pound Cake  
550 Other Flavor Cake

## DECORATED ITEMS

Judged for artistic design – need not be edible

555 Decorated Novelty Cakes  
556 Decorated Occasion or Holiday Cake  
557 Decorated Sugar mold (1 or set)  
558 Decorated Cup Cakes (4)  
559 Decorated Cookies (4)  
560 Decorated Mints (4)  
561 Decorated Wedding Cake  
562 Decorated Ginger Bread House

## COOKIES (4 ON A PLATE)

570 Biscotti Cookies  
571 Snickerdoodle Cookies  
572 Oatmeal Cookies  
573 Icebox Cookies  
574 Peanut Butter Cookies  
575 Chocolate Chip Cookies  
576 White Sugar Cookies  
577 Ginger Cookies  
578 No Bake Cookies  
579 Fruit Cookies  
580 Vegetable Cookies  
581 Chocolate Cookies  
582 Brownies  
583 Bar Cookies  
584 High Fiber Cookies (w/recipe)  
585 Dietetic Cookies (w/recipe)  
586 Nut Cookies  
587 Mixed Ingredient Cookies  
588 Cookies not listed

## PIES (WHOLE PIE IN PIE PAN)

595 Apple Pie  
596 Peach Pie  
597 Cherry Pie  
598 Berry Pie  
599 Apricot Pie  
600 Raisin Pie  
601 Mincemeat Pie  
602 Gooseberry Pie  
603 Rhubarb Pie  
604 Pie not listed

## CANDY (4 PIECES)

610 Molded Mints  
611 Hard Candy  
612 Dipped Candy  
613 Fudge Candy  
614 Divinity  
615 Peanut Brittle Candy  
616 Chocolate Marshmallow Candy  
617 Pralines Candy  
625 President's Cookie Jar  
President's Cookie Jar: Fancy assorted cookies in a clear glass, widemouth jar 1 gallon capacity. Jar, attractively decorated according to the 2012 theme: "Blue Jeans and Country Dreams" will count 50%, cookies 50%. Jar must be filled with not less than 3 different kinds of cookies. Each cookie should be wrapped separately in clear plastic wrap. Bring 1 of each kind on a paper plate with each cookie individually identified and wrapped in plastic wrap, so that the judge will not need open jar. Plate of cookies will not be returned. The winning cookie jar will be presented to the Fair Board President at 6:30 p.m. Friday, Aug. 10 before livestock auction.



## OPEN CLASS

# Food Preservation

Supt.: Barbara Wood, (913) 369-2495; Mary Ellen Barnes, (785) 843-3783  
 Entry Time:  
 MONDAY, 6:30-8:30 pm; TUESDAY, 8-9 am  
 Released:  
 SATURDAY.....9 to 10 p.m.  
 SUNDAY.....9 to 11 a.m.

### Judging Begins 10 a.m. Tuesday, Aug. 9

#### Special Rules:

1. Please read Home Economics General Rules, page 20.
  2. Jars must be standard canning jars with lids and rings that are easy to remove for judging.
  3. Jars must be clean and sealed
  4. List processing method (pressure or water bath) on entry card
  5. Exhibitors may exhibit three different "not listed" or diabetic per section. Please identify product.
  6. All food preservation must be processed since last fair.
- Premiums:  
 \$1.50, First; \$1.25, Second ; \$1.00, Third.  
 Open class premium checks will not be mailed. They must be picked up at fair office.  
 Y – Youth – to age 16; A – Adult – ages 17 to 59; SC – Seniors 60 years and older.

#### FRUITS

- 600 Blackberries
- 601 Raspberries
- 602 Gooseberries
- 603 Peaches
- 604 Pears
- 605 Plums
- 606 Apricots
- 607 Cherries
- 608 Apples
- 609 Applesauce
- 610 Rhubarb
- 611 Fruit Juice
- 612 Fruit not listed
- 612a Diabetic Fruit

#### VEGETABLES

- 613 Tomatoes
- 614 Green String Beans
- 615 Wax String Beans
- 616 Beets
- 617 Carrots
- 618 Pumpkin or Squash
- 619 Tomato Juice
- 620 Vegetable Soup Mixture
- 621 Sauerkraut
- 622 Corn
- 623 Peas
- 624 Small Whole Potatoes
- 625 Greens
- 626 Tomato Sauce (plain or seasoned)
- 627 Mixed Vegetables
- 628 Spaghetti Sauce
- 629 Vegetable not listed

#### MEAT OR MAIN DISH

- 630 Fish
- 631 Beef
- 632 Poultry
- 633 Meat Sauce
- 634 Chili
- 635 Not listed

#### DRIED

Up to three entries will be accepted in class No. 636, 637 and 639. Dried foods should be enclosed in a moisture proof clear container.

- 636 Fruit
- 637 Vegetable
- 638 Jerky (include recipe)
- 639 Herbs (3 ounces or less)
- 640 Trail mix (1/2 to 3/4 cup)
- 641 Fruit Leather (3 rolled pieces 5" to 6" long)
- 642 Whole Grain Granola (w/recipe)
- 643 Vegetable Seasoning Mix
- 644 Mixed Vegetables
- 645 Dried Food not listed
- 645a Diabetic

#### PICKLES

(may be opened for judging)

- 646 Taco Sauce/Salsa
  - 647 Pickled Beets
  - 648 Sweet Cucumber Pickles
  - 649 Dill Pickles
  - 650 Lime Pickles
  - 651 Bread-Butter Pickles
  - 652 Beans
  - 653 Watermelon
  - 654 Relish
  - 655 Hamburger Relish
  - 656 Pickled Peppers
  - 657 Barbecue or Chili Sauce
  - 658 Ketchup
  - 659 Pickled Fruit
  - 660 Pickled Vegetable
  - 661 Pickled Mixed Vegetables
  - 662 Okra
  - 663 Not listed
  - 663a Diabetic Jelly
- No paraffin seals, must be water-bath processed. May be opened for judging.
- 664 Grape
  - 665 Blackberry
  - 666 Raspberry (red or black)
  - 667 Peach
  - 668 Plum
  - 669 Cherry
  - 670 Apple or Crab Apple
  - 671 Gooseberry
  - 672 Elderberry
  - 673 Strawberry
  - 674 Blueberry
  - 675 Pear
  - 676 Mint
  - 677 Jelly not listed
  - 677a Diabetic

#### JAMS, PRESERVATIVES & BUTTER

No paraffin seals, must be water-bath processed. May be opened for judging.

- 678 Apple Butter
  - 679 Strawberry
  - 680 Blackberry
  - 681 Raspberry (red or black)
  - 682 Gooseberry
  - 683 Peach
  - 684 Cherry
  - 685 Apricot
  - 686 Plum
  - 687 Pear Honey
  - 688 Blueberry
  - 689 Jams not listed
  - 690 Strawberry Preserves
  - 691 Preserves not listed
  - 692 Butters not listed
  - 692a Diabetic
- Marmalades & Miscellaneous  
 No paraffin seals, must be water-bath processed. May be opened for judging.
- 693 Orange
  - 694 Mixed Marmalade
  - 695 Marmalade not listed
  - 696 Chutney
  - 697 Syrup
  - 698 Pie Filling
  - 699 Miscellaneous

# LEAVENWORTH

## Cooperative Association

"Quality and Service Since 1963"



Proud Supporter of 4-H and FFA

"Come visit our booth  
at the Fair!"



- Propane Home, Bottles, RV's
- Full Service Agronomy Center
  - Chemicals - Fertilizer - Seed
- Refined Fuels / Bulk Farm Delivery
- Dog Grooming
- Pet Food & Pet Supplies
- Farm Store
  - Feed -Animal Health -Livestock Equipment -Lawn & Garden
- Convenience Store with Breakfast & Lunch Menu

STORE HOURS: MON - FRI 8 AM - 5 PM; SAT 8 AM - 12 NOON

**4th & Eisenhower • Lansing, KS • 727-1900**

71280

## COURTNEY'S

### Used Trucks Agri Business

**25659 Springdale Road**  
**(14 miles west of Leavenworth, KS)**  
**McLouth, Kansas 66054**  
**(913) 796-6198**



## OPEN CLASS Ceramics

Superintendents: Nancy Henre, (913) 626-6826; and Rich Henre

In consideration of each and every entrant participating in the ceramic division of the Leavenworth County Fair, we have made the list of rules and regulations to help all members of this committee and judges produce an honest and fair competitive show that a ceramist would feel proud to be a part of.

1. Any ceramist may enter for competition, in Leavenworth County, Fort Leavenworth, V.A., and any surrounding county that does not have an open class competitive show.

2. All entries must be made entirely by entrant within the past 12 months.

3. Placement of the entries is decided by the owner entrant although we will be happy to assist with the placing of an item in the proper category.

4. Plaster, sand filling and/or anything other than true ceramic will not be allowed in any form other than specified in the divisions, such as fabrics, etc.

5. Plants, real or artificial may not be included in planters, etc. for the sake of safety and judging.

6. NO "naughties" or "nudes" except art replicas, will be accepted.

7. Entries will be taken from 6:30 to 8:30 p.m. Monday and from 8 to 9 a.m. Tuesday. NO EXCEPTIONS! Delivery and pickup will be the responsibility of the entrant.

8. Entries will be picked up on Saturday evening from 9 to 10 p.m. and Sunday 9

to 11 a.m. Absolutely no sooner or later. No exceptions will be made.

9. No entries will be released without a proper claim check.

10. LEAVENWORTH COUNTY FAIR Ceramic Division and staff members are not responsible for loss or damages but we will do our best to avoid any harm to all items.

11. No fees and no premiums

12. Legitimate complaints should be discussed with the superintendent of the ceramic division or the president of the association.

Judges will be ceramic professionals from out of the county who are familiar with any and all phases and techniques commonly used on entries.

Adult volunteer workers are always welcome. Without you help this division could not exist. Helpers are always needed for cleanup, setting up, taking entries and guarding. Even one hour of your time can be a great help.

Awards: Consist of first, second, third and best of division, best of show rosette and trophies for children, teens, hobbyists, best of show and professional provided there are 100 entries or more.

Special Rules: Judging will be in private Tuesday morning at 10 a.m. Judging will be based on merit, talent, imagination and workmanship. No ribbon will be awarded unless entry deserves it. All entries must be made by entrant alone and commercial pieces will not be allowed.

Divisions and Categories: All categories

must have entries by 2 or more persons to be eligible for judging.

Thank you for participating in the Ceramic Division. We welcome any help or suggestions you may offer. Thank you, Ceramic Committee.

### DIVISION 1 – UNFIRED STAINS

- 1-A Opaques only
- 1-B Antiqued Translucents
- 1-C Metallics
- 1-D Woodtones
- 1-E Stain Glaze Combinations
- 1-F Dry Brushing
- 1-G Miscellaneous

### DIVISION 2 – CHALKS

- 2-A Entire Piece
- 2-B Accent
- 2-C Overglaze
- 2-D Miscellaneous

### DIVISION 3 – GLAZES

- 3-A Glosses
- 3-B Matte/Satin
- 3-C Glaze Combinations
- 3-D Exotics (crystallines, speckles, mixtures, etc.)
- 3-E Miscellaneous

### DIVISION 4 – UNDERGLAZES

- 4-A Translucents
- 4-B Opaque
- 4-C Brushwork
- 4-D Miscellaneous (could include all or part of above, also airbrushed)

### DIVISION 5 – OVERGLAZES

- 5-A Lustres/Halos
- 5-B Decals
- 5-C Chalk Over Glazed pieces
- 5-D China Painted

### DIVISION 6 – UNUSUAL TECHNIQUES

- 6-A Unusual Techniques (cutout, etc., raised cutout-spraffito-carving using or /in relief air)
- 6-B Air Brushed
- 6-C Stoneware
- 6-D Miscellaneous Adaption

### DIVISION 7 – FREE FORMED CLAYS

- 7-A Low Fired
- 7-B Porcelain
- 7-C Stoneware
- 7-D Miscellaneous Adaptation

### DIVISION 8 – PLAQUES, PICTURES, PLATES, HANGING CLOCKS, ETC.

- 8-A Stains
- 8-B Glazes
- 8-C Special Effects-Combinations
- 8-D Miscellaneous

### DIVISION 9 – LAMPS

(Only ceramic shades will be allowed during judging. Other shades will be attached and lighted if space allows.)

- 9-A Stained
- 9-B Glazed
- 9-C Miscellaneous

### DIVISION 10 – MINIATURES

- 10-A Stained
- 10-B Glazed
- 10-C Porcelain-Stoneware
- 10-D Free-Form
- 10-E Overglazed
- 10-F Miscellaneous

We now accept  
**SNAP**  
benefits  
(aka Vision Card)

**15% OFF**  
Everything in the store  
WITH THIS COUPON - GOOD THRU AUG 31, 2012  
(No other discounts apply)

**Morefields  
Supersaver**

**4601 Commercial Place • Leavenworth, KS 66048 • (913) 727-1051**  
(Formerly The Bargain Factory)

**We are right behind the Ford dealership on S. 4th St.**

### NEW SUMMER HOURS:

Monday, Tuesday 9:00am - 5:30pm; Wednesday, Thursday, Friday 9:00am - 6:00pm  
Saturday 9:00am-5:30pm; Sunday 10:00am - 4:00pm

**Senior Citizen's  
10% discount  
every Tuesday  
and Military 10%  
discount everyday!**

- Grocery
- Frozen Food
- Diapers and everything baby
- Fabric and Sewing Supplies
- Books
- Electronics
- Furniture
- Health & Beauty Aids
- Housewares
- Cleaning Supplies
- Hardware
- Tools
- Pet Supplies
- Much, Much More...



# OPEN CLASS Flowers

## FLOWER SHOW

In Home Economics Building  
Supt.: Barbara Dale, (913) 845-2591; (913) 845-2591; Asst. Supt. Jean Pearson, (913) 845-3228.  
Entries due at fair: 8:30-10 a.m. Wed., Aug. 8

**Judging starts 10:30 a.m.**

**Wednesday, Aug. 8**

Entries released.....1 p.m. Thursday, Aug. 9  
Special Rules: Please read rules carefully as judges and chairmen will abide by rules below.

1. Entry card must show section, class, name of flower/entry, and exhibitor's name. Card will have name covered until after judging.
2. Please fill out entry cards prior to entering building. Use pencil, or address labels. Do not go to entry table until you have all cards filled out and flowers arranged in containers.
3. Entry fee is \$.25 per entry.
4. There are two divisions:  
Adults: Age 17 and older  
Juniors: Age 16 and younger
5. Entries are limited to one per class or variety. Exceptions: when an exhibit falls in "variety not listed," mark card showing "not listed" after name of flower. Exhibitor may exhibit two different "not listed" per section. Flower variety must be identified.
6. Entries will be received from 8:30-10 a.m. Wednesday. Exhibits arriving after 10 a.m. may be displayed but not judged.
- EXHIBITS MUST REMAIN IN PLACE UNTIL 1 P.M. THURSDAY.**
7. All persons except judges and Flower Show Committee shall be excluded while

- judging is taking place.
8. Judges may withhold awards in classes considered unworthy. Judges' decisions final.
  9. All flowers and plant entries must be grown by the exhibitor, except wildflowers used in arrangements.
  10. Houseplants must be in exhibitor's possession for three months. Remember that a well groomed plant makes a better exhibit. This does not mean oil or spray.
  11. The flag of the United States should not be displayed above or in front of the arrangement. Check regulations before using flags of other countries.
  12. Exhibitors will furnish their own containers. Specimen entries must be in crystal clear bottles or jars with no leaves in the water.
  13. All arrangements may be accessorized with wood, rocks, foliage, figurines, etc. If an important contribution to the finished design.
  14. Exhibitors are responsible for their own property. Flower show and county fair officials are not responsible for vases or accessories that are lost or broken.
  15. A specimen could be any of the following:  
- .....a single flower  
-a stalk (a heavy stem with flowers and foliage)  
-a spray (more than one flower & foliage with sufficient stem and foliage)  
Premiums: (Both adult and youth classes)  
1st, \$1.50; 2nd, \$1.25; 3rd, \$1.00.  
Open class premium checks will not be mailed. They must be picked up at fair office.

## SCHEDULE OF EXHIBITS

### SECTION A – ROSES

Class.....	Specimen
1.....	Climber – pink
2.....	Climber – red
3.....	Climber – yellow

4.....	Floribunda – pink
5.....	Floribunda – red
6.....	Floribunda – yellow
7.....	Grandiflora – any color
8.....	Hybrid Tea – bi-color
9.....	Hybrid Tea – lavender
10.....	Hybrid Tea – pink
11.....	Hybrid Tea – red
12.....	Hybrid Tea – white
13.....	Hybrid Tea – yellow
14.....	Miniature – any color
15.....	Antique – any color
16.....	Roses not listed

### SECTION B – PERENNIALS

Class.....	Specimen
17.....	Chrysanthemum – large, bronze
18.....	Chrysanthemum – large, buff
19.....	Chrysanthemum – large, fuchsia
20.....	Chrysanthemum – large, pink
21.....	Chrysanthemum – large, purple
22.....	Chrysanthemum – large, red
23.....	Chrysanthemum – large, white
24.....	Chrysanthemum – large, yellow
25.....	Chrysanthemum – small, bronze
26.....	Chrysanthemum – small, buff
27.....	Chrysanthemum – small, fuchsia
28.....	Chrysanthemum – small, pink
29.....	Chrysanthemum – small, purple
30.....	Chrysanthemum – small, red
31.....	Chrysanthemum – small, white
32.....	Chrysanthemum – small, yellow
33.....	Daisy
34.....	Fever Few – white
35.....	Fever Few – other
36.....	Gaillardia
37.....	Hardy Aster – pink
38.....	Hardy Aster – purple
39.....	Ornamental Grass

40.....	Plantain Lily (Hosta)
41.....	Hardy Salvia
42.....	Dianthus
43.....	Anthemis (yellow Daisy family)
44.....	Blackberry Lily
45.....	Purple Cone Flower
46.....	Rose Mallow
47.....	Blazing Star or Gay Feather
48.....	Bee Balm
49.....	Phlox
50.....	Sedum Spectabile (Live forever)
51.....	Goldenrod
52.....	Perennial not listed

### SECTION C – BULBS AND RHIZOMES

Class.....	Specimen
53.....	Cactus Dahlia
54.....	Canna
55.....	Dahlia – double, any color
56.....	Dahlia – Pom-Pom, any color
57.....	Dahlia – single, any color
58.....	Gladiola – bicolor
59.....	Gladiola – blue
60.....	Gladiola – bronze
61.....	Gladiola – green
62.....	Gladiola – lavender
63.....	Gladiola – pink
64.....	Gladiola – purple
65.....	Gladiola – red
66.....	Gladiola – white
67.....	Gladiola – yellow
68.....	Hemerocallis (Day Lily)
69.....	Asiatic Lily
70.....	Naked Lady (Lycoris)

Please see FLOWERS, page 30



## Our North Campus

Serving Leavenworth and Lansing Communities  
2101 10th Ave., Leavenworth, KS 66048  
Office 913-682-7474

**Preschool (licensed) 3 years to Pre-K  
taking reservations now 913-682-4747**

WORSHIP Saturday 5:30 pm  
Sunday 8am, 9:30 am (Contemporary) & 10:45 am  
Bible Classes & Sunday School at 9:30 am.

[www.gatheringinchrist.org](http://www.gatheringinchrist.org)

**Visit our booth  
at the  
County Fair**

## Our South Campus

Serving Basehor, Bonner Springs  
and Tonganoxie Communities  
16928 Evans Rd., Bonner Springs 66012

WORSHIP Sunday Traditional 8:00 am  
Contemporary Worship with Children's Church 10:30 am  
Sunday School & Adult Bible Classes at 9:15 am

## TRINITY FAMILY LEARNING CENTER

Providing Pre-School childcare  
for ages 1 year to 5th graders;  
Before & After School Care with Bus Service  
& Summer Program up to 5th grade  
**Enroll Now: 913-724-4441**



# OPEN CLASS Flowers

FROM PAGE 29

- 71..... Peruvian Daffodil
- 72..... Peruvian Lily
- 73..... Tuberose
- 74... Bulb-Rhizomes, not listed

SECTION D – ANNUALS

- Class Specimen (3 Blossoms each)
- 75..... Asters – Double
  - 76..... Asters – Single
  - 77..... Cosmos
  - 78... Globe Amaranth, mixed
  - 79... Marigold – large double
  - 80 . Marigold – medium double
  - 81..... Marigold – dwarf
  - 82..... Marigold – single
  - 83..... Marigold – white
  - 84..... Nasturtiums
  - 85..... Pinks – red
  - 86..... Pinks – variegated
  - 87..... Pinks – white
  - 88 . Strawflower – Helichrysum (mixed)
  - 89..... Zinnias
  - 90 Zinnias – miniature, bicolor
  - 91 Zinnias – miniature, lavender
  - 92... Zinnias – miniature, pink
  - 93..... Zinnias – miniature, red
  - 94.. Zinnias – miniature, white
  - 95.Zinnias – miniature, yellow
  - 96..... Zinnias – Mexican
  - 97..... Bells of Ireland
  - 98..... Calendula
  - 99 Celosia (Cockscomb) feathered
  - 100 Celosia (Cockscomb) feathered small
  - 101 Celosia (Cockscomb) plain
  - 102 ..... Coleus
  - 103 Impatiens (Sultana) double
  - 104 Impatiens (Sultana) orange
  - 105 . Impatiens (Sultana) pink
  - 106 ... Impatiens (Sultana) red
  - 107 Impatiens (Sultana) salmon
  - 108 Impatiens (Sultana) white
  - 109 ..... Periwinkle
  - 110 ..... Salvia- red
  - 111 ..... Snapdragon
  - 112 . Snapdragon – miniature
  - 113 ..... Spider Plant – Cleome
  - 114 ..... Summer Poinsettia
  - 115 ..... Sunflower
  - 116 ..... Verbenas – pink
  - 117 ..... Verbenas – purple
  - 118 ..... Verbenas – red
  - 119 ..... Zinnia – giant, bicolor
  - 120 ..... Zinnia – giant, pink
  - 121 ..... Zinnia – giant, orange
  - 122 ..... Zinnia – giant, red

- 123 ..... Zinnia – giant, white
- 124 ..... Zinnia – giant, yellow
- Class..... Spray
- 125 ..... Petunia – double, pink
- 126 . Petunia – double, purple
- 127 ..... Petunia – double, red
- 128 Petunia – double, variegated
- 129 ... Petunia – double, white
- 130 ..... Petunia – ruffled
- 131 ..... Petunia – single, pink
- 132 .... Petunia – single, purple
- 133 ..... Petunia – single, red
- 134 Petunia – single, variegated
- 135 ..... Petunia – single, white
- 136 ..... Rose moss
- 137 ..... Annual not listed

SECTION E – FLOWERING VINES AND SHRUBS

- Class..... Specimen
- 138 ..... Bittersweet
  - 139 ..... Callicarpajewel berry
  - 140 ..... Clematis
  - 141 ..... Grape Myrtle
  - 142 ..... Hibiscus
  - 143 ..... Kerria
  - 144 ..... Passion Flower
  - 145 ..... Pyracantha
  - 146 ..... Rose of Sharon
  - 147 ..... Silver Lace
  - 148 ..... Butterfly Bush
  - 149 ..... Spirea
  - 150 ..... Weigela
  - 151 ..... Variety not listed

SECTION F – HOUSE PLANTS

- Class..... Specimen
- 152 ..... Achimenes
  - 153 Airplane Plant – green or variegated
  - 154 African Violet – double flower
  - 155 African Violet – single flower
  - 156 African Violet – variegated foliage
  - 157 Begonia – Angel Wing, large
  - 158 Begonia – Angel Wing, small
  - 159 ..... Begonia – Beefsteak
  - 160 .... Begonia – Lettuce Leaf
  - 161 ..... Begonia – Rose, pink
  - 162 ..... Begonia – Rose, red
  - 163 ..... Begonia – Rose, white
  - 164 ..... Begonia – Tuberous
  - 165 .... Begonia – Turkey Foot
  - 166 ..... Begonia – not listed
  - 167 Cacti – large, in pot over 12"
  - 168 Cacti – medium, in pot 12" or under
  - 169 Cacti – miniature, in pot 3" or under
  - 170 Cacti – collection in pot (large over 12")
  - 171 Cacti – small, in pot 6" or under

- 171A Container consisting of 2 or more plants. Large — 13 inches or larger.
- 171B Small container between 6 inches and 12 inches.
- 172 Succulent collection in 1 pot, medium 12" or under
- 173 ..... Caladium
- 174 ..... Fern (not fruit or flowering plant)
- 175 ..... Foliage
- 176 ..... Geranium – regular
- 177 ..... Geranium – scented
- 178 ..... Grapeleaf Ivy
- 179 . . Hanging Planter, flowering
- 180 . Hanging Planter, foliage
- 181 . . Hanging Planter, mixed plants
- 182 ..... Ivy – standard
- 183 ..... Ivy – miniature
- 184 ..... Joseph Coat
- 185 ..... Kolanchoe
- 186 . Philodendron (all species)
- 187 ..... Pothos
- 188 ..... Shrimp Plant
- 189 . Succulents – large, over 6"
- 190 . Succulents – small, 6" or under
- 191 . Succulents – miniature, 3" or under
- 192 . Succulents – collection in one pot
- 193 ..... House Plants not listed

SECTION G – ARRANGEMENTS

- Will Be Judged First
- Class..... Specimen
- 194 ..... At the Fair
  - 195 . Take just 3 flowers plus foliage
  - 196 . . Vegetables & Fruit are flowers too
  - 197 ..... Vegetable Figure
  - 198 . Grass and more
  - 199 ..... Birds Paradise
  - 200 ..... The Fairy Garden
  - 201 Blue Jeans and Country Dreams
  - 202 ..A New Baby has Arrived

- 203 . Petite Designs – 2 like containers not over 3" high or wide
- 204 . . Petite Designs – 2 like containers not over 6" high or wide
- 205 . . Petite Designs – one & only, not over 3" high or wide
- 206 . . Petite Designs – one & only, not over 6" high or wide
- 207 . . Arrangement in unusual container
- 208. .Using Nature's Art (driftwood, rock, shells, etc.)
- 209. .Span the Seasons (both dry and fresh flowers)
- 210 . .Home Dried (list drying methods)
- 211 ..... Anything Goes
- 212. . Flower Pictures in Frame (dried flowers mounted on background, ready to hang or stand)
- 213. . Monochromatic (shades of one color including container)
- 214 . . Remember the 20th Century (in antique container)
- 215Place Setting Display (1 place setting, w/live floral centerpiece, 24" x 30" display area)
- 216 ..... Vacation Memories
- 217Along the Roadway (wild flowers)
- 218 ..... Spring has Sprung
- 219 ..... Summer Pleasures
- 220 ..... Autumn Gold
- 221 ..... Winter Wonderland
- 222 ..... Foliage Alone
- 223 ..... The Wind Blows
- 224 ..... Recycled Container
- 225 ..... From the Kitchen
- 226 ..... Religious Theme
- 227 ..... Salute to America

SECTION H  
230 Water Garden

**WWW.LEAVENWORTHCOUNTYFAIR.COM**  
**FOR AN INTERACTIVE GUIDE TO THIS YEAR'S FAIR!**

Plus, find us on Facebook and Twitter for contests and giveaways!

 @LeaCountyFair  
 facebook.com/LeavenworthCountyFair

 **Arrow Auto Sales** 

**NEXT TO SUBWAY**

**NOW OPEN**

415 North Main  
Tonganoxie, KS 66086  
913-845-3400



**Your Tonganoxie Car Dealer for Quality Used Cars & Trucks**

 **STEVE FARMS**  
**Angus and Buelingo Cattle**

**Joe & Judy Steve**  
18933 Lecompton Road  
Leavenworth, KS 66048  
913-651-7489



## 4-H/FFA AND OPEN CLASSES

# Pre-fair events and fair week activities

### PRE-FAIR ACTIVITIES SATURDAY, JULY 21

- 9 a.m., 4-H dog obedience and showmanship show (livestock show arena)
- 9:30 a.m., 4-H cat/pet check-in (Tonganoxie 4-H building)
- 10 a.m., 4-H cat/pet show (Tonganoxie 4-H building)

### THURSDAY, AUG. 2

- (Tonganoxie High School – West Campus)
- 9 a.m., 4-H constructed clothing modeling judging, 4-H constructed clothing consultation judging and 4-H leadership project consultations.
  - 10 a.m. - noon, 4-H family/consumer sciences judging contest

### FRIDAY, AUG. 3

- (Tonganoxie High School – West Campus)
- 9 a.m., 4-H buymanship judging, make up day leadership project consultations
  - 9:30 a.m., 4-H demonstrations/illustrated talks judging
  - 7 p.m. public fashion style revue (Tonganoxie Performing Arts Center)

### SUNDAY, AUG. 5

- 8 a.m., 4-H/FFA horse show registration
- 9 a.m., 4-H/FFA horse show (horse arena)
- 1 p.m., fairgrounds setup – everyone!

### MONDAY, AUG. 6

- 9 a.m., 4-H foods and nutrition/preservation consultation (Tonganoxie 4-H building),



Photo by Shawn Linenberger

**YOUTHS PARTICIPATE** in the Ag Olympics during the 2011 Leavenworth County Fair. A scavenger hunt and other competitions highlight the event in which many 4-H members participate.

- 4-H woodworking consultation judging (green metal building – west side) and 4-H visual arts consultation judging (green metal building – east side)
- 10 a.m., 4-H fiber arts consultation judging (green metal building – east side)
- 4-5 p.m., 4-H/FFA/open class sheep entries weighed in
- 5-9 p.m., 4-H/FFA/open class rabbit entries accepted (rabbit barn)
- 5-10 p.m., 4-H/FFA/open class swine entries weighed in (livestock barns)

### FAIR WEEK ACTIVITIES TUESDAY, AUG. 7

- 8-9 a.m., 4-H/FFA/open goats entries

- accepted/weighed in (livestock barns)
- 8 a.m. - noon, 4-H clothing entries accepted (Tongie 4-H building), 4-H project displays setup, 4-H booth/banner entries accepted (green metal building), 4-H/FFA/open class poultry entries accepted (poultry barn) and 4-H/FFA/open class rabbit entries accepted (rabbit barn)
- 9 a.m., 4-H electricity consultation judging (green metal building)
- 9-11 a.m., 4-H/FFA/open class beef entries weighed in (livestock barns)
- 9 a.m. - noon, 4-H photography entries accepted (Tonganoxie 4-H building)
- 11 a.m., 4-H bucket calf entries accepted and weighed in (livestock barns)
- 1 p.m., 4-H entomology consultation judg-

ing, 4-H forestry consultation judging, 4-H geology consultation judging (rabbit barn), 4-H photography consultation judging and 4-H home environment judging (Tongie 4-H building)

- 1-4 p.m., 4-H/FFA/open class vegetables, plant science and bee science entries accepted (green metal building – east side)
- 1-5:30 p.m., 4-H/FFA/open class poultry entries accepted (poultry barn)
- 2 p.m., 4-H booths, banners and project displays judging (green metal building – west side)
- 5 p.m., 4-H/FFA/open class vegetables and plant, science judging (green metal building – east side)
- 5-8 p.m., 4-H SpaceTech (all areas) consultation judging (Tonganoxie 4-H building)
- 6 p.m., 4-H/FFA/open class swine show (livestock show arena), 4-H food, woodworking, visual arts and fiber arts entries **MUST** be checked in by NOON on Monday.

### WEDNESDAY, AUG. 8

- 8 a.m., 4-H/FFA/open class market and other goat show (livestock show arena), and 4-H bucket calf consultation judging (big top tent)
- 8:30-10 a.m., 4-H/open class flower entries accepted (home economics building)
- 9 a.m., 4-H Cloverbud entries accepted and judged (Tonganoxie 4-H building)
- 9:30 a.m., 4-H/FFA tractor operators event (check in at 4-H office)
- 10 a.m., 4-H/FFA/open class poultry showmanship (poultry barn)
- 10 a.m., 4-H rocket launch (baseball field near fairgrounds)
- 10:30 a.m., 4-H/open class flower en-

Please see FAIR, page 32

## Rainbow Roofing

*We Cover All Your Roofing Needs!*

- New Roofs
- Re-lays
- Tear Offs

Composition Shingles  
Wood Shakes  
Re-Decks

Insurance Work  
Over 20 Years Experience  
**FREE ESTIMATES**



Call Butch 913.299.2667 • 816.507.8160 • 913.724.2228

## LOGAN AUTO REPAIR

110 N. 3rd Street  
Easton, Kansas 66020  
Phone: (913) 773-8330

Steve Logan, Owner



- Tire Repair
- Rotate & Balance
- Front End Alignment
- Suspension
- Computer Diagnostics and Repair
- Tune-ups
- Oil Changes
- Brake Services
- Engine/Transmission Overhaul
- Heating/AC Service



# APRIL VALLEY FARMS

## Annual Production Sale

### March 17, 2013

at the St. Joseph, Mo. Stockyards



AVF Sara 1048

A past many times champion now serving as an April Valley donor

#### Sires Represented

SAV Bismarck 5682 / SAV Brilliance 8077  
SAV Iron Mountain 8066 / Limestone Jupiter U449  
Mytty In Focus / Sitz Dash 10277  
VAR Rocky 80029 / Coneally Impression

**Also Available at the farm are  
SHOW PIGS for 4-H and FFA Projects.**

Watch for their sale listing.

EDMUND THEIS 913-682-4376 LARRY THEIS 913-775-2130  
MARK THEIS 913-683-4377 JERRY THEIS, D.V.M. 913-683-0775

Enjoy great music & drink specials!  
(Shawnee location)



Banquet Room Available  
for all your gatherings

61st & Nieman  
Shawnee, KS 66203  
913.631.5716

34th & Gibbs  
Kansas City, KS 66106  
913.677.1844

Oldest  
Restaurant in  
Shawnee  
Since 1969

- Live music 1st and 3rd Thursdays
- Matt Snook, national country recording artist  
June 26, July 24 and August 28

**New in Shawnee!**  
Full bar, including  
large selection  
of beer & spirits  
from local  
microbreweries  
and distilleries



Order online at [www.shawneepizza.com](http://www.shawneepizza.com)

## 4-H/FFA AND OPEN CLASSES

# Fair week events

FROM PAGE 31

- tries judged (home economics building)
- 10:30 a.m. - noon, 4-H/FFA beef consultation judging (north end of livestock arena)
- 2 p.m., 4-H bucket calf fitting and showing (livestock show arena), 4-H/FFA/open class poultry show (poultry barn)
- 7 p.m., 4-H/FFA/open class sheep show (livestock show arena)

### THURSDAY, AUG. 9

- 8 a.m., 4-H/FFA/open class rabbit show (rabbit barn)
- 8:30 a.m.-noon, 4-H/FFA/open class dairy cattle accepted (dairy barn)
- 9 a.m., 4-H/FFA/open class beef show (livestock show arena)
- 4 p.m., or immediately after beef show, 4-H/FFA/open class dairy goat show (livestock show arena)
- 5:30-8:30 p.m., 4-H canned food drive (west parking gate and 4-H food stand)
- 8 p.m., 4-H/FFA/open class dairy cattle show (livestock show arena)

### FRIDAY, AUG. 10

- 8 a.m., round robin showmanship (livestock show arena)
- 9:30 - 10:15 a.m., livestock judging con-

test registration (livestock show arena)

- 10:30 a.m., livestock judging contest (livestock show arena)
- 11:30-1 p.m., Ag Challenge of Champions – open to everyone! (north end of livestock arena)
- 2 p.m., setup for Livestock Auction (livestock show arena)
- 5:30-6:30 p.m., appreciation reception for 2010 4-H/FFA Buyers, (big top tent)
- 6-6:15 p.m., 4-H Spirit Awards, Ag Challenge of Champions and 4-H scholarships announced (livestock show arena)
- 6:30 p.m., 46th ANNUAL 4-H/FFA LIVE-STOCK AUCTION (livestock show arena)

### SATURDAY, AUG. 11

- 8:30 - 9:30 a.m., 4-H horticulture judging contest
- 10 a.m., Ag Olympics, sponsored by Bell 4-H Club (big tent)
- 10 a.m.-noon, 4-H dog agility (livestock show arena)
- 2 p.m., kids pedal tractor pull (livestock show arena)

### SUNDAY, AUG. 12

- 9 a.m., 4-H/FFA exhibits released, fair-ground cleanup – everyone!

# General rules

#### 4-H/FFA Classes

1. As of 2001, all exhibitors in 4-H and FFA departments must be at least 7 years of age as of Jan. 1 of the current year. They must not have passed their 19th birthday as of Jan. 1 of the current year. Exhibitors must be enrolled in 4-H/FFA by April 1 of the current year and meet project requirements and deadlines to exhibit at the county fair. Classes will be determined by age as of Jan. 1 of the current year.
2. Exhibitors who are members of both 4-H and FFA must choose how they will exhibit in each department. Exhibitors may NOT exhibit as both 4-H and FFA in any one department. Exhibitors may choose to exhibit as 4-H in one department and FFA in a different department (i.e., 4-H beef, FFA swine, 4-H rabbits, etc.). Entries are limited to one per class except where otherwise noted.
3. 4-H/FFA departments are open to youth members who are properly enrolled in the county program and have met the appropriate requirements and

#### deadlines.

4. Any 4-H/FFA member who has previously shown in a 4-H/FFA class at a county fair in the current year is only eligible for open class exhibition.
5. Exhibits must be products of the current 4-H or FFA year.
6. All entries are exhibited at the sole risk of the owner.
7. To exhibit in each department, pre-fair deadlines must be met.
8. Copyrighted and/or trademarked materials used without written permission in banners, displays, demonstrations, posters or other activities will be disqualified and will not be displayed or receive ribbons or premiums.
9. The Danish evaluation system will be used to place exhibits in one of the following classifications:  
**PURPLE** — given to a few outstanding exhibits.  
**BLUE** — specifies excellent quality work,

Please see GENERAL, page 33



## 4-H/FFA AND OPEN CLASSES

# General rules

FROM PAGE 32

far above average.

**RED** — designates average exhibits.

**WHITE** — indicates exhibits meet requirements for fair, but below average quality.

Judges may award as many ribbons of any color as they feel are justified in any class.

Judges' decisions are FINAL. Purple awards receive same premium as blue awards.

10. Kansas State Fair exhibitors must be at least 9 years of age as of Jan. 1 of the current year. NOTE: Any 4-H member with a qualified 4-H exhibit (see State Fair premium book) wishing to enter the Kansas State Fair must make arrangements at the Extension Office at the county fair. This includes all non-livestock departments.

11. Any 4-H'er wishing to make entry for the State Fair must do so by noon on Saturday of county fair week.

12. Exhibitors entering any large or delicate exhibits selected for the State Fair must be responsible for transportation of that project to the State Fair.

13. Cash premiums will be pro-rated in all exhibit classes except where noted.

14. Where judging is by consultation evaluation, the leader and parent may sit in on consultation as observers. All others are to remain away to ensure a private conference.

15. After awards have been made, ribbons must be posted so that the public may identify awards of judge.

16. Stalls will be kept clean and presentable to the public at all times. Unclean stalls will not be tolerated.

17. No fans will be allowed in aisles or alleyways.

18. The superintendent has the authority to have any animal exhibit inspected by the Fair Board-appointed veterinarian. Animals showing evidence of infection or disease will be ordered removed from the fairgrounds.

19. All animals must be owned by the exhibitor. All animals must be entered and exhibited in a class. No exhibit space is available for display purposes.

20. Livestock animals are not to be removed from stalls or pens between 6 p.m. and 10 p.m. except for showing. Wash racks are closed from 6 p.m. to 10 p.m. Between midnight and 6 a.m. no one may feed, groom, water or remove an animal from the pens/stalls for any reason. "Night tie" safety ropes must be firmly attached when they are in their stalls and are not being attended to.

21. Exhibitors must furnish their own feed, equipment and bedding. The storing of hay and the use of straw will not be allowed in the barn. Extra hay/feed should be stored elsewhere. Only take into the barn what your animal will eat at one feeding.

22. If an exhibitor has more than one animal entered in one market class, one

animal is to be shown by the exhibitor and the other by another Leavenworth County 4-H or FFA member enrolled in the same project.

23. Stalls are to be thoroughly cleaned when animals are released. Exhibits will be released between 9:00 am and 10:00 am on the last Sunday of fair week.

24. If exhibitor becomes unable to control the animal while in the ring, the attendant in the ring will help exhibitor get control of animal. If exhibitor loses control, a request will be made for other 4-H members, family members or project leader to assist exhibitor. If animal continues to be uncontrolled, exhibitor will be asked to leave the arena.

25. Only those 4-H and FFA members exhibiting livestock are allowed to stay overnight at the fairgrounds. These members must be under the direct supervision of a leader or parent. Be aware that facilities are extremely limited after closing hours.

26. Interpretation of 4-H General and Special Rules will be made by the superintendent of department in question and the Extension Office/Extension Board.

27. All 4-H/FFA exhibitors are also subject to general open class rules and regulations.

28. Each exhibitor is personally responsible for the care and showing of his/her animal. Younger members may be assisted by a family member or available Leavenworth County 4-H/FFA member or leader. Ethical fitting practices will be observed.

29. Animals not sold through the auction, but sold to individuals with the intention of the locker plant hauling the animal, must have destination sheet turned into the Fair Extension Office by 1 p.m. on Thursday of the Fair. This helps ensure that the animal goes to the right hauler and locker plant.

30. The Leavenworth County 4-H/FFA Livestock Fair and Show is the show-place for animal agriculture and animal care for Leavenworth County 4-H and FFA members. All animals and livestock shown, housed or displayed shall receive care that is humane, healthful, stress-free and consistent with public expectations. Cruelty, neglect or indifference to animal comfort and welfare will not be tolerated and will constitute grounds for removal from the premises. Ample feed and clean water will be provided to all animals consistent with sound husbandry practices and with rules and regulations set by the Leavenworth County Extension Board and Leavenworth County Fair Board. The environment in which animals are kept will be kept clean and sanitary at all times. Professional veterinary care will be provided as needed.

Animals experiencing illness, injury or discomfort will be professionally

Please see GENERAL, page 34



## K.C. Bobcat

### Visit us at our booth at The Leavenworth County Fair!



**Steve Dickey can help you with all your Bobcat  
Compact Equipment Needs!**

**Blue Springs**  
2209 West 40 Hwy  
Blue Springs, MO 64015  
(866) 794-7504

**Platte City**  
801 Main  
Platte City, MO 64079  
(816) 431-3001

**Olathe**  
1220 South Hamilton Circle  
Olathe, KS 66061  
(913) 829-4600



## Bobcat®

[www.kcbobcat.com](http://www.kcbobcat.com)

**NOW WITH TWO GREAT LOCATIONS TO SERVE YOU!**

## COUNTRY HARVEST



YOUR NEIGHBORHOOD FOOD STORE

**315 S. UNION McLOUTH, KS 66054**  
**913-796-2291**

**7312 K-4 HIGHWAY MERIDEN, KS 66512**  
**(785) 484-3580**

[WWW.COUNTRYHARVEST.US](http://WWW.COUNTRYHARVEST.US)  
[WWW.MYAPPLEMARKET.COM](http://WWW.MYAPPLEMARKET.COM)

**Free case**

**Best Choice**

**of Water**

**with \$50 purchase**



(Valid thru August 11, 2012)



# Leavenworth County 4-H classes

## DEPARTMENT 22 HOME ENVIRONMENT

Superintendent: Connie O'Brien, (913) 706-2396  
Consultation judging: 1 p.m. Tuesday, Aug. 7, Tonganoxie 4-H Building  
Special Rules  
1. Read General Rules. Member must be enrolled in the 4-H Home Environment project by February 1.  
2. Each exhibitor must pre-enter. Entries are due to the Extension Office by July 15.  
3. Articles may have been used, but if so, they need to be carefully laundered or cleaned before being exhibited.  
4. A member is limited to two entries per class.  
5. Only purple awards are eligible for State Fair.  
6. A home environment exhibit summary must be completed and attached to exhibit

upon entry at the fair. The judge will consider application of home environment and design skills learned as noted on the summary sheet and demonstrated by the exhibit.  
Explain if the exhibit contains any recycled materials.  
**SECTION 200 – HOME ENVIRONMENT**  
**Class 2201 – Single Exhibit.** An article made or refinished by the 4-H'er for the home.  
Include explanation of how it was made, cost, pictures, plans, patterns, etc. Describe how it fits into the color and design scheme of the room. This explanation will be considered in the total score. Explanation can be on a poster, in a story or other method. (If a pair is exhibited, include both.)  
**Class 2202 – Poster**  
**Class 2203 - Notebook.** Poster or notebook may include swatches, colors, stories, photographs and project records which detail what was accomplished this year with a given

indication of long-term plans.  
**SCORE CARD FOR EXHIBITS**  
• Plan and story: 20 points  
• Use of color: 20 points  
• Use of design: 20 points  
• Combination of things: 20 points  
• Selection (rating workmanship and/or choice): 20 points  
Total Score: 100 points

## DEPARTMENT 23 FOODS - NUTRITION

Superintendent: Patty Scharinger, (913) 651-0271.  
Consultation judging: 9 a.m. Monday, Aug. 6, Tonganoxie 4-H building  
Award sponsors: Sharon Riedel and Cathy Forge.  
**SPECIAL RULES**  
1. Read General Rules.  
2. Member must be enrolled in the 4-H

Foods & Nutrition project by February 1 to exhibit.  
3. Each exhibitor must pre-enter. Entries are due to the Extension Office by July 15.  
4. Member is limited to a combined total of three entries for food preparation classes (nonperishable food item, decorated item, gift package). These three exhibits may be more than one per class, but must be different recipes. Member may also enter one educational exhibit and is eligible to enter the Food Preservation department.  
5. Food and nutrition exhibits will be judged by consultation evaluation of the products with the 4-H'er and judge. Parents and leaders are welcome to listen in only. The ribbon placing will be marked on the card and the ribbon will be given to the 4-H'er at time of evaluation. Refer to the fair schedule for judging schedule and times.

Please see LEAVENWORTH COUNTY, page 35

## 4-H/FFA AND OPEN CLASSES

# General rules

FROM PAGE 33  
attended to by a veterinarian authorized by the Board. Exhibits shall reflect the care and concern that all Leavenworth County and Kansas breeders have for livestock.  
31. Withdrawal times for drugs, growth promotants and other approved materials:  
Exhibitors, their parents, leaders and instructors have a serious responsibility to use animal health aids (drugs), growth promotants and any other approved materials with great care, and only when needed and in correct

amounts. Approved withdrawal times are set and must be followed to ensure that meat customers receive wholesome food.  
Market livestock will not be allowed to show without a completed certificate signed by an exhibitor and parent or guardian.  
32. The giving of an oral or injected diuretic, growth promotants or other medication not approved for any domestic animal constitutes an unethical practice.  
The fair reserves the right to have a blood and/or urine laboratory analysis made on any animal entered in com-

petition. An exhibitor of an animal producing an analysis with a quantity of diuretic or any unapproved medication will forfeit all prizes and premiums, and may be barred from future competition at the fair.  
33. Destruction of exhibits is strictly prohibited. 4-H members found guilty will be asked to remove their exhibits from the fairgrounds, forfeit all premiums and be prohibited from fairgrounds for remainder of fair. Final decision will be made by Leavenworth County 4-H Program Development Committee.  
34. Any product administered inter-

nally or used externally to alter the conformation and/or appearance of an animal for exhibition is prohibited. This includes the covering of white skin, any false hair, steroids or artificial filling internally.  
Any animal found to be in violation will be barred from showing. In the carcass evaluation any animal exhibiting violations of meat quality standards will only receive net check from floor buyers.  
35. Any livestock animals not exhibited at the fair are not allowed on Fairgrounds unless requested by Auction Committee.



**See You at the Fair!**  
**Bank of McLouth**  
McLouth, Kansas • 913-796-6133  
[www.mybankusb.com](http://www.mybankusb.com)  
Member FDIC



**The Insurance Center**  
913-369-6600 • 913-369-3030 fax  
Farm - Auto - Home  
**FREE Quotes – Call Today**  
**Diane Bretthauer    Debbie Mendez**



# 4-H classes continued

FROM PAGE 34

6. For food safety purposes, any food with custard and cream cheese-type fillings and frostings, flavored oils, "canned" bread or cakes in a jar, or food requiring refrigeration will not be judged. Refer to K-State Research and Extension publication, 4-H 712, Food Safety Recommendations for Acceptable Fair Exhibits, for information to help you make informed, safe food exhibit decisions.

7. The entire product must be entered and uncut. Exhibit three cookies, three muffins, three breadsticks, etc.

8. All exhibits must be baked and loaves must be whole and uncut. Cookies and rolls must be the same shape and same recipe.

9. All unfrosted cakes must be exhibited in an upright position with crust showing. The exception is for those cakes made with special designs such as bundt cakes. They must have top crust side down.

10. Any baked product that can be removed from the pan must be placed on a paper plate, covered cardboard or disposable container.

11. Exhibits must be in food plastic bags, disposable plastic containers or boxes. For food safety, all products must be brought to the evaluation with protective coverings. A tip on frosting: Use a butter cream frosting, which will stand up under hot weather. Hydrogenated fats are most satisfactory to use.

12. A portion of each product, which is judged at the pre-fair foods judging, will be used to make club foods displays. The other portions will be sold unless marked "not to sell."

13. If selected for State Fair, a member may exhibit only one baked food product and one educational display.

14. Educational exhibits – May be in the form of a poster, notebook or display. Follow copyright laws as explained in the General Rules as you are preparing your exhibit. Take care to

select materials that will withstand Fair conditions. No card table displays. Posters must not be larger than 22" x 28." Displays must not be larger than a 2' x 3' tri-fold display board. Note: A collection of your favorite recipes in a recipe box or notebook does not constitute an educational exhibit. The exhibit will be judged 60 percent on nutrition information and 40 percent on appearance. All exhibits will be displayed at the county fair.

15. Food gift package – No alcoholic beverages will be accepted. A nonperishable food gift package must contain at least three different food items (prepared for human consumption), made by the 4-H'er, in a suitable container no larger than 18" x 18" x 18." Prepared food items must have recipes attached with entry. Additional homemade food items beyond the three minimum, or purchased items, may also be included in the gift basket. Attach information answering these questions: a) What is the intended use? b) What food safety precautions were taken during and after preparation? Include total dollar cost of filled basket.

16. Modified nonperishable food product – Product must be modified from original recipe to nutritionally enhance the food product. Attach one 8 X 11-inch page (front and back) that includes original recipe, modified recipe and narrative to describe modifications made, why modifications were made and lessons learned, such as nutritive value, or changes in appearance, doneness, aroma, flavor, tenderness and/or texture. Suggested resources: Altering Recipes for Better Health, Purdue University: [www.ces.purdue.edu/extmedia/CFS/CFS-157-W.pdf](http://www.ces.purdue.edu/extmedia/CFS/CFS-157-W.pdf)

Altering Recipes for Good Health, Texas A&M University: [fcs.tamu.edu/food\\_and\\_nutrition/PDF/alteringrecipes.pdf](http://fcs.tamu.edu/food_and_nutrition/PDF/alteringrecipes.pdf)

17. Recipes are required for all food product exhibits including gift basket items.

18. A decorated food item must be a food item, not a decorated box. No State Fair Class.

19. Not responsible for any items left (pans,

dishes, etc.).

20. No alcohol should be included as an ingredient in food entries. Entries with alcohol in the recipe will be disqualified and not be judged. Entries in nonperishable food item, decorated item and gift package must not total more than three entries (exception: one entry allowed in educational exhibit).

**SECTION 310 – LEVEL I** (age 7-8 as of Jan. 1 of current year)

**Class 2312** – Nonperishable Food Item

**Class 2313** – Nonperishable Decorated Item – County Class only

**Class 2314** – Nonperishable Gift Package

**Class 2315** – Educational Exhibit

**SECTION 320 – LEVEL II** (age 9-11 as of Jan. 1 of current year)

**Class 2322** – Nonperishable Food Item

**Class 2323** – Nonperishable Decorated Item – County Class only

**Class 2324** – Nonperishable Gift Package

**Class 2325** – Educational Exhibit

**SECTION 330 – LEVEL III** (age 12-14 as of Jan. 1 of current year)

**Class 2332** – Nonperishable Food Item

**Class 2333** – Nonperishable Decorated Item – County Class only

**Class 2334** – Nonperishable Gift Package

**Class 2335** – Educational Exhibit

**Class 2336** – Modified Nonperishable Food Product

**SECTION 340 – LEVEL IV** (age 15-18 as of Jan. 1 of current year)

**Class 2342** – Nonperishable Food Item

**Class 2343** – Nonperishable Decorated Item – County Class only

**Class 2344** – Nonperishable Gift Package

**Class 2345** – Educational Exhibit

**Class 2346** – Modified Nonperishable Food Product

## DEPARTMENT 24 FOOD PRESERVATION

Superintendent: Kathleen Glover, (913) 651-3066.

Consultation judging: 9 a.m. Monday, Aug. 6, Tonganoxie 4-H Building.

### SPECIAL RULES

1. Read General Rules.

2. Member must be enrolled in the 4-H Foods & Nutrition project by February 1 to exhibit.

3. Each exhibitor must pre-enter. Entries are due to the Extension Office by July 15.

4. Members may bring up to five exhibits. Any combination within classes is OK, except an exhibitor cannot have two jars of the same product (i.e., an exhibitor cannot have two jars of grape jelly). For the State Fair, a member may enter up to two exhibits, but may only make one entry per class. One jar constitutes an entry.

5. All exhibits must be preserved in the current 4-H year.

6. Each exhibit must have the complete recipe and instructions attached with the entry card, or it will be lowered one ribbon placing. Recipe must include recipe source, date of publication and altitude of residence.

7. Exhibits must be sealed in clean standard canning jars with matching brand, (use Ball lids on Ball jars, or Kerr lids on Kerr jars, etc.) two-piece lids. Ball and Kerr plaid- or fruit-decorated lids are permissible, but fancy padded lids, fabric overwraps or cozies interfere with the judging process and should not be used.

Jars must be sealed when entered. Jelly must be in half pint or pint jars. All other products must be in pint or quart jars. Note: There are now 12-ounce canning jars available. If there is not a USDA-recommended process time available for the 12-ounce jar, these may

Please see 4-H, page 36



# Dailey Ag, LLC

10152 North Highway 59, Oskaloosa, KS  
(located at the old Co-op, north of Oskaloosa)



- Moormans NEW Seasonal Summer Mineral
- All new Liquid feed "High Energy" Mix 30 Plus! Come in and ask us about it!
- Square bales for sale: Straw, Brome and Alfalfa

- ADM lick tubs \* Pet Foods
- Bailing Twine – square & round bales
- Diesel fuel, Lubricants and additives
- Propane fill station – We can fill your bottles

**Phone:** 785-863-2011

email: [mike@daileyag.com](mailto:mike@daileyag.com)  
email: [nancy@daileyag.com](mailto:nancy@daileyag.com)

**Hours:** M-F 8-6pm • Sat: 8-3:00pm

**June 30th - Sept. 1st.**

**Summer Saturday Hours:** 8-12:30pm



**Gavin W. Olds, D.C.**

307 Ridge St. Tonganoxie, KS

**Open Mon.-Fri. Sat. by appointment**



- Specialized Stretching • Acupuncture
- Soft Tissue Mobilization • Kinesiology Taping

**913-845-900 | [www.tonganoxiechiropractic.com](http://www.tonganoxiechiropractic.com)**



## 4-H classes continued

FROM PAGE 35

be used with a pint jar canning process recommendation.

8. Recommended method of processing must be used. Follow guidelines in K-State Research and Extension food preservation publications or USDA's Complete Guide to Home Canning; or So Easy to Preserve, 5th Edition, Cooperative Extension Service, The University of Georgia; or Ball Blue Book of Preserving (2009). Open kettle processed food will not be accepted. Pickles and sweet spreads must be finished using the water bath process for the altitude of residence. Low acid products must be pressure processed properly for the altitude of residence. The label must include the canning method (water bath or weighted gauge pressure method), process time and amount of pressure (pound-force per square inch) when pressure canning method is used. Refer to K-State Research and Extension publication, 4-H712 Food Safety Recommendations for Acceptable Fair Exhibits, for information to help you make informed, safe food preservation exhibit decisions.

9. Dried food item must include one kind of dried food product exhibited in a small

canning jar. If dried food product is not in a canning jar, it will be lowered one ribbon placing. Suggested amount: 1/3 to 1/2 cup, or three to four pieces per exhibit. ALL meat jerky must be cooked to 160 degrees F before or after drying. Dried products must include the recipe and preparation steps. Jerky not heated to 160 degrees F will not be judged. Heating information can be found at [www.fcs.uga.edu/ext/pubs/fdns/FDNS-E-43-11.PDE](http://www.fcs.uga.edu/ext/pubs/fdns/FDNS-E-43-11.PDE).

10. Each jar exhibited must be labeled with a uniform label placed one inch from base of the jar. The label must not cover the brand name of the jar. You may need to make a label using an adhesive mailing label. The label must not cover the brand name of jar. The label must give: class number, product, canning method, process time, pressure (psi), date processed including month and year, name and county/district.

11. It is advisable to have an extra jar to be used in case of breakage. This jar should be labeled "extra."

12. Frozen foods will not be judged.

13. Exhibit will be judged on quality of canned products and choice of foods.

14. All containers of pickles, jelly and other sweet spreads may be opened and tasted for quality by the judge.

15. No alcohol should be included as an ingredient in food preservation entries. Those entries with alcohol in the recipe will be disqualified and not be judged.

**SECTION 410 – LEVEL I** (age 7-8 as of Jan. 1 of current year)

**Class 2411 – Canned Food Item**

**Class 2412 – Dried Food Item**

**SECTION 420 – LEVEL II** (age 9-11 as of Jan. 1 of current year)

**Class 2421 – Canned Food Item**

**Class 2422 – Dried Food Item**

**SECTION 430 – LEVEL III** (age 12-14 as of Jan. 1 of current year)

**Class 2431 – Canned Food Item**

**Class 2432 – Dried Food Item**

**SECTION 440 – LEVEL IV** (age 15-18 as of Jan. 1 of current year)

**Class 2441 – Canned Food Item**

**Class 2442 – Dried Food Item**

### DEPARTMENT 25 VISUAL ARTS

Superintendent: Tina Packard, (913) 364-5700.

Award sponsors: Bisque-It (Ceramics) and Heartland Church of God.

#### SPECIAL RULES

1. Read General Rules.

1. Member must be enrolled in 4-H Visual Arts by February 1 to exhibit.

2. Each exhibitor must pre-enter. Entries are due to the Extension Office by July 15.

3. Exhibitors are allowed no more than 5 entries per project area. List each entry on a separate line on entry sheet. Example: If you have five crafts, list an entry for Class 2501 five times.

4. Your name and 4-H club must be on every item. Take pictures and make a list of what you will bring to the fair. Make duplicate lists, especially if you yourself are not picking up the items on Sunday morning. Securely attach entry card with description on back of items. If an item is small or has several small pieces, place it in a zip-close bag so it won't get lost.

5. All articles will be completed, ready for display or use. Any articles meant to be hung must have an appropriate hanger attached. Suggested hangers include frames or mats with wires attached. For younger youth drawings, string on the back attached with hot glue is suggested. Hangers applied with any type of tape will be considered unacceptable for hanging and may not get displayed.

6. Exhibits will be judged by consultation evaluation of the articles with the 4-H'er and judge. Leaders/parents are welcome to listen in only.

7. A limited number of visual arts entries

from each county are allowed to be displayed at the State Fair. Grand champion and reserve grand champion will be selected for State Fair. The items to fill the remainder of the quota will be the judge's decision.

#### SECTION 500 – VISUAL ARTS

##### Class 2501 – Crafts

Inform the judge if the project was made from kit, pattern or original design. May include, but not be limited to, nature craft, recycled craft, metal working, tin punch, miscellaneous or self-determined projects, woodburning, dough art, paper mache, puppets, corn husk, mobiles, tie dyeing, pine cone art, soft sculpture, stained glass and decorated T-shirts.

##### Class 2502 – Sketching & Drawing

May include, but not be limited to, charcoal, chalk or pastel, ink, pencil, mixed media, painting on glass (mixed media), collage, scratch board and prints (screen, woodcuts, etc.). All pictures must be ready to hang.

##### Class 2503 – Painting

May include, but not be limited to, watercolor, acrylic, mixed media, painting on glass (mixed media) and oil painting. All pictures must be ready to hang.

##### Class 2504 – Ceramics

May include, but not be limited to, slab work, free form, greenware with glaze, stains, etc. Exhibitors must include the steps accomplished to finish their pieces and bring their notes with them to consultation.

##### Class 2505 – Leather (an article)

May include, but not be limited to, billfold, belt, key chain, purse, bookmark, coin purse, bracelet, lacing and leather cloths (chaps, berets, vest, etc.). This includes stamped leather and pictures.

##### Class 2506 – Carving (an article)

May include, but not be limited to, soap plaster, soft wood, hard wood and country carving.

### DEPARTMENT 26 FIBER ARTS

Superintendent: Lori Todd, (913) 683-8330.

Award sponsors: Logan Auto Repair and Kalus Heating and Cooling.

#### SPECIAL RULES

1. Read General Rules.

1. Member must be enrolled in project by February 1 to exhibit. When the exhibit is a sewed garment that also includes one or more fiber art techniques (i.e. knitting, crochet, needle arts, or patchwork and quilting), the determination of what department

Please see 4-H, page 37

## Stop by today and get ready for the Leavenworth County Fair

We have Cattle & Horse Supplies & Accessories, Feed Grooming Supplies, Men's & Women's Apparel and so much more.



1111 North Main  
Lansing, KS 66043  
913-727-1701

**HUND**  
Service Station  
1101 Metropolitan  
Leavenworth • 682-4002

*Have Fun  
at the Fair!*



- Engine Tune-ups
- Oil Changes
- Tire Repair
- Tire Balancing
- Exhaust Repair

and much more.



## 4-H classes continued

FROM PAGE 36

(clothing & textiles or fiber arts) and class in which to enter will be left with the 4-H participant. An exhibit may not be double entered – a project is evaluated one time.

2. Fiber arts is defined as any method of creating a unique design with fiber, fabric or yarn. This may include: making fabric (such as weaving, crochet, knitting, needlepoint), or the existing fabric is changed into something quite different (such as quilting or embroidery or ethnic art). Ethnic fiber arts should use a fiber, yarn or fabric to create the design exhibit.

3. Each exhibitor must pre-enter. Entries are due to the Extension Office by July 15.

4. Limit of three entries per class. Other articles may be critiqued but no premium or ribbons will be awarded to them. All articles/garments must be finished for use.

5. The exhibitor should attach an index card, no larger than 3" x 5," to each item. Include any information on what parts of the exhibit the member made, processes used or other information that the exhibitor thinks would be helpful for the judge. For all items, please indicate if item was made from a kit. For knitted and crocheted items, indicate fiber content, and specifically if they are made of at least 90 percent wool.

6. Articles that have been used need to be cleaned before exhibiting.

7. When articles normally worn as a pair or set are exhibited, both articles must be shown together. Fasten articles together securely with yarn.

8. Special consideration will be given to articles that are the 4-H'er's original design. Such articles should have a note attached explaining the original design.

9. Exhibits will be judged by consultation evaluation of the articles with 4-H'er and judge. Parents and leaders are welcome to listen in only.

10. All exhibits that need to be hung MUST have the appropriate sawtooth hanger, rod, wire or other mechanism attached in order to be properly displayed. If necessary hardware is not attached, it may not be displayed.

11. A member may enter only one exhibit in each class at the State Fair.

12. There are no age-specific classes in fiber arts. Exhibitor's age and years in the project will be considered by judges.

### SECTION 600 – FIBER ARTS

**Class 2601 – Crochet (an article including felted items)**

**Class 2602 – Knitting (an article made either by hand or by knitting machine including felted items)**

**Class 2603 – Needle Arts (an**

**article created by hand using any of the following techniques: embroidery and cross-stitch, needlepoint, candlewicking, crewel, lacework and/or applique)**

**Class 2604 – Patchwork & Quilting (an article).** It is an acceptable practice for the exhibitor to create the patchwork and have someone else quilt it.

**Class 2605 – Rug Making (a rug).** Acceptable techniques include braiding, latch hook, tying, floor cloth, etc. The finished product should be an item used in the home.

**Class 2606 – Spinning (a skein, minimum 10 yards in length)**

**Class 2607 – Weaving (a woven article).** Members should attach information about the type of loom or process used.

**Class 2608 – Ethnic Art (an article).** This is defined as a fiber art technique that is associated with a specific country or culture. It is a practical skill that was developed to provide basic family needs such as apparel, home furnishings or decorations. It is also defined as a method that has been maintained throughout history and passed on to others, often by observation and by example, such as batik, Swedish huck towel weaving, mud cloth, bobbin weaving, tatting, felted items that are not crocheted or knitted, etc. Members should attach information on the history of the ethnic fiber art, where it was used, by whom, how it was used, a short description of the technique, etc.

**Class 2609 – Macrame (an article)**

**Class 2610 – Fiber Arts (fiber arts educational notebook).** Share with others what you learned in this project about a particular fiber art. Exhibits should be in the form of a notebook or binder. The notebook should include a narrative section describing the fiber art. It should include a clear description of the project, technique, budget, supplies, goals, accomplishments, successes, failures and future plans. It may include samples of techniques, how-tos, photographs of completed projects or other ways of educating others about fiber arts. NOTE: a collection of brochures, web pages, patterns, record book forms, etc. does not constitute an educational notebook. Follow copyright laws as explained in the General Rules as you are preparing your exhibit. Name, local unit and fiber art covered must be clearly marked in the notebook.

### DEPARTMENT 27 CLOTHING & TEXTILES

Superintendent: Kathy Theis, (913) 682-2417; Jilinda White, (913) 250-0994; Stephanie Shupe (buymanship).

Award sponsors: Candle Queen Candles, Gina Greenwood, J and N Ranch, New Haven Angus and RL Leintz Funeral Home, LLC; boys and girls buymanship levels 1-5, Peruvian Connection.

Consultation judging: 9 a.m. Thursday, Aug. 2 (construction and modeling); buymanship, 9 a.m. Friday, Aug. 3, all at THS West Campus.

### SPECIAL RULES

1. Read General Rules.
2. Member must be enrolled in the 4-H clothing & textiles project to exhibit.
3. Each exhibitor must pre-enter. Entries are due to the Extension Office by July 15.
4. Limit of five entries for construction, to include recycled clothing project, one entry for purchased (buymanship), and one entry for educational exhibit. For constructed garment classes, one entry is made for construction evaluation and another entry for modeling the garment.

5. A member is limited to modeling one outfit per class. Purchased garments may be added to complete a constructed outfit, but must be noted as purchased.

6. At State Fair, member may enter a maximum of two exhibits in this department. If two exhibits are entered, they must be in two different classes: constructed piece(s), educa-

tional exhibit or recycled clothing project.

7. Articles, garments, outfits may have been used/worn but shall be carefully laundered or cleaned before being exhibited.

8. Care labels will not be required, however, 4-H members should know how to care for fabrics they purchase.

9. Precut kits or items sewn with an overlock machine are acceptable. All articles/garments must be finished for use.

10. Please remove scissors and shears from sewing boxes before displaying at the fair.

11. 4-H clothing construction exhibits will be judged by consultation evaluation of the articles with the 4-H member and judge. Parents and leaders are welcome to listen in only. The judge will have the right to ask the 4-H'er to put on a garment of the judge's choice to check the fit. Refer to the 4-H newsletter for judging schedule.

12. Clothing exhibits will be accepted at the fair on Tuesday from 8:00 a.m. to noon.

13. Ribbons will be placed on all garments at the county fair. Garments must be exhibited at the fair to receive a ribbon.

14. Each contestant is expected to model one outfit (no changes) at the public fashion revue held on the Friday of the clothing

Please see 4-H, page 38

# SMITH VETERINARY CLINIC

VICKIE K. SMITH, D.V.M.



1625  
Tonganoxie Road,  
Tonganoxie, KS  
(913) 845-3061

Practice Limited to Horses and Small Animals

# ATCHISON COUNTY AUCTION COMPANY, INC.

2103 MAIN, ATCHISON, KANSAS

# HOG & CATTLE SALE

EVERY SATURDAY at 11 A.M.

To Buy or Sell Contact Us:

BARN PHONE	RON ESTES	STEVE ESTES
913-367-5278	913-367-6762	913-367-6764
achisonauction@att.net		





Weddings • Reunions • School & Scout groups • Birthday parties  
Military ceremonies • Company outings • Campfires • Chuck wagon meals  
Grass-fed beef • Pasture-raised pork & lamb • Free range chicken

**Barn Dance & Pumpkin Patch Opening Day: Saturday, Sept. 15**  
Pumpkin Patch open through Wednesday, Oct. 31.

---

Coupon valid during Pumpkin Patch season  
Sept. 15 - Oct. 31, 2012

**Lamborn Farm & Historic Barn**  
National Register of Historic Places • Register of Kansas Historic Places  
Kansas Preservation Alliance 2012 Medallion Award for Excellence in Preservation

25761 151st Street • Leavenworth, KS  
(1.5 miles west of the Lansing Sonic)

Buy one  
Lamborn  
Farm grass-fed  
beef burger,  
get one FREE!



# BUTLER'S

## MUFFLER & BRAKE

TRAILER  
HITCHES



### Certified Full Service Auto Repair

- OIL & LUBE
- PACK TRAILER BEARINGS
- FULL BRAKE SERVICE
- TRANSMISSION FLUSHES
- A/C REPAIR
- CATALYTIC CONVERTERS
- ROTATE & BALANCE
- ALTERNATORS & STARTERS
- SHOCKS & STRUTS
- ALIGNMENTS
- PERFORMANCE EXHAUST
- MINOR TUNE-UPS

*A well maintained vehicle  
not only gives you  
peace of mind,  
but saves you money.  
Let our quality service  
at a FAIR price  
keep you on the road.*



## ALL CARS, TRUCKS & SUV's WELCOME!

# 913-682-8443

**220 North 5th Street  
DOWNTOWN LEAVENWORTH**

Dave Norwood, Owner





MON-FRI  
7AM-5PM  
SAT  
7AM-NOON

## 4-H classes continued

FROM PAGE 37

judging. Location and time will be announced. Winners are announced at the Public Fashion Revue.

15. A special "Fashion Revue Script" sheet, available at the Extension Office or on line, must be filled out by the contestant for the Public Fashion Revue. To be turned in at judging, with copy kept by the 4-H'er. Level III, IV members: complete Cost Per Wear worksheet for judging (required for State Fair).

16. The top two in the Level IV modeling classes will represent county at State Fair.

### DEFINITIONS FOR CLOTHING & TEXTILES

**Article** - An item constructed in a clothing project such as backpack, laundry bag, garment bag, PJ's holder, tent, sleeping bag, cape, hat, gloves, scarf, etc. Item can be handmade or machine sewn and can also include applique or machine embroidering on item they have made.

**Garment** - A garment can be a dress, coat, jumper, jumpsuit, skirt, vest, blouse, shirt, pair of slacks, etc.

**Outfit** - Two or more pieces that can be worn together at the same time, but not necessarily a complete outfit. Example: a vest and skirt. **Recycled Clothing Project** - An item made of at least 50% recycled material (recycled means reusing an existing item in a new way). Could be remaking/redesigning a garment, re-purposing a clothing item for a new use, etc. Must include sewing of some kind. A 3"x5" index card MUST accompany entry describing the recycled materials and how they were used in the item.

**Educational Exhibit** - Share with others what you learned in this project. Exhibits may be in the form of a poster, notebook or display. Follow copyright laws as explained in the General Rules. Take care to select durable materials that will withstand Fair conditions. No card tables allowed. Posters no larger than 22" x 28". Maximum size for a display is a 2' x 3' tri-fold display board.

**Modeling of constructed garment or outfit** - Everything which is commonly considered as outer garment (vest, jacket, skirt, dress, pants, coat, etc.) must be constructed by the 4-H'er. A sweater, blouse or shirt can be purchased or made.

**Modeling of a purchased garment or outfit (buymanship)** - Everything which is commonly considered an outer garment (vest, jacket, dress, skirt, pants, coat, etc.) must be purchased by the 4-H'er or constructed by another person, using fabric and pattern chosen by the 4-H'er.

### SCORE CARD FOR MODELING CLASSES

General appearance & knowledge (70%)

Posture, poise, grooming, garment condition, fit of garment, modeling skills, acces-

sories used to create a total look, knowledge of wardrobe plan.

Construction appearance & life cycle knowledge (30%). Quality of construction, appropriate finishing techniques used, plan for clothing care and life cycle, able to calculate value per wear.

**SECTION 710 - LEVEL I** (age 7-8 as of Jan. 1 of current year)

**Class 2711** - garment, article, or outfit constructed by 4-H'er

**Class 2712** - educational exhibit

**Class 2713** - Recycled Clothing Project

**Class 2714** - Modeling of constructed garment or outfit

**Class 2715** - Modeling of purchased garment or outfit - for young women

**Class 2716** - Modeling of purchased garment or outfit - for young men

**SECTION 720 - LEVEL II** (age 9-11 as of Jan. 1 of current year)

**Class 2721** - garment, article, or outfit constructed by 4-H'er

**Class 2722** - educational exhibit

**Class 2723** - Recycled Clothing Project

**Class 2724** - Modeling of constructed garment or outfit

**Class 2725** - Modeling of purchased garment or outfit - for young women

**Class 2726** - Modeling of purchased garment or outfit - for young men

**SECTION 730 - LEVEL III** (age 12-14 as of Jan. 1 of current year)

**Class 2731** - garment, article, or outfit constructed by 4-H'er

**Class 2732** - educational exhibit

**Class 2733** - Recycled Clothing Project

**Class 2734** - Modeling of constructed garment or outfit

**Class 2735** - Modeling of purchased garment or outfit (for young women)

**Class 2736** - Modeling of purchased garment or outfit (for young men)

**SECTION 740 - LEVEL IV** (age 15-18 as of Jan. 1 of current year)

**Class 2741** - garment, article, or outfit constructed by 4-H'er

**Class 2742** - educational exhibit

**Class 2743** - Recycled Clothing Project

**Class 2744** - Modeling of constructed garment or outfit

**Class 2745** - Modeling of purchased garment or outfit - for young women

**Class 2746** - Modeling of purchased garment or outfit - for young men

**SECTION 750 - FIRST YEAR SEAM-STRESS ONLY** (regardless of age)

**Class 2751** - Sewing box. Judged on content only. Box may be homemade or purchased. Not a State Fair class.



## 4-H classes

### DEPARTMENT 29 DEMONSTRATIONS/ ILLUSTRATED TALKS

Supt.: Debra Buddish, (913) 651-2166.

Consultation judging: 9:30 a.m. Friday, Aug.

3, THS West Campus.

#### SPECIAL RULES

1. Read General Rules.

2. This department is open to any 4-H member who has properly enrolled by Feb. 1.

3. Each contestant must pre-enter. Entries are due to the Extension Office by July 15.

Contestants will be notified of judging schedule.

4. Members giving demonstrations or illustrated talks must check-in with the superintendent no later than 15 minutes before the scheduled time of the presentation.

5. Demonstrations or talks may be either individuals or team (two people) presentations.

6. Presentations should be of sufficient length to cover the topic adequately, 20 minutes maximum.

7. A demonstration shows a step by step procedure, and explains why each step is essential to develop a particular skill or task. An illustrated talk incorporates the use of visual aids (posters, supplies, equipment, etc.) that illustrates the topic being discussed.

An informative talk using illustrations is not a demonstration or illustrated talk. Project talks and public speaking may not be entered in this department.

8. Any purple presentation (or top blue at 4-H Day) may be entered for State Fair if the 4-H member is 9 to 18 years of age as of Jan. 1 of the current year. Counties are not limited to the number of demonstrations or illustrated talks given on any topic.

9. The following scoring breakdown will be used:

Introduction 10 points, Appearance 10 points, Presentation 30 points, Subject Matter 30 points, Visual aids and/or equipment 10 points, Summary 10 points, total 100 points

#### SECTION 900 – DEMOS/ILLUSTRATED TALKS

**Class 9001** – Demonstration or Illustrated Talk by an individual

**Class 9002** – Demonstration or Illustrated Talk by a team (two people)

### DEPARTMENT 30 BOOTH/BANNER

Superintendent: Maureen Davidson, (785) 841-7537.

Awards sponsor: Leavenworth County Conservation District offers \$50, \$25 and \$15 for the top three booths and/or banners

promoting environmental protection.

#### SPECIAL RULES

Read General Rules. Be especially aware of copyright and trademark rules.

1. This department is open to any properly enrolled 4-H member and/or 4-H club.

2. Each club and/or exhibitor must pre-enter. Entries are due to the Extension Office by July 15.

3. One of the intended purposes of this department is to encourage 4-H'er involvement with the design and construction of a booth and/or banner.

4. Each club may enter only one booth in this department; however, each club may enter one banner per section (maximum of 3 total club banners).

5. Individual 4-H members may also enter one banner per section.

6. Up to three 4-H promotional banners (club or individual) may be selected for the State Fair.

7. Each 4-H promotional banner and/or booth should illustrate a phase of 4-H work which is being practiced by youth in 4-H or promotes 4-H in general.

8. Noxious weed control and environmental protection booth/banners should illustrate information supporting that respective area. The top booth and/or banner focusing on noxious weed control will receive a special premium of \$75 from the County Weed Supervisor. The top three booths and/or banners promoting environmental protection will be awarded special premiums of \$50, \$25, and \$15 from the Leavenworth County Soil Conservation District.

9. Banners are a two dimensional display, depicting one idea. Banner dimensions are to be no less than 12 and no more than 16 square feet, with no side less than 3 feet.

10. Banners must be hung on a rod and rope or hanging wire, strong enough to support the banner.

11. Banners should be made of materials that permit the banner to be folded or rolled without damaging the display. Objects may not be attached to the front of the banner.

12. Attach a label to the back lower left-hand corner of the banner giving the club or member's name, county and year. Letters should be two inches in height. Waterproof ink prevents smearing and is recommended for the label.

13. Booth spaces are approximately six feet square. The club name should appear in a prominent place on the booth.

14. Each club will be responsible for erecting its own booth framework and furnishing all materials. Booths must be removed by the club after fair.

Please see LEAVENWORTH COUNTY, page 40

# NAVINSKY CONSTRUCTION, INC.

Steve Navinsky



**BULL DOZING  
DAM REPAIR  
EXCAVATING  
UNI-LOADER  
TRACK HOE**

20119 178th Street • Winchester, KS 66097

**913-683-4641**



**Complete Auto Body Collision Repair  
& Automotive Repair Services**

- **Expert Craftsmanship & Repair Service**
- **Insurance Claims Experts**  
(Let your insurance company know that you would like to have S & S Body Shop repair your vehicle)
- **Hail & Storm Damage**
- **ASE Certified Technicians**
- **Rental Car Services Available**

**Melanie Starcher—Owner**  
**922 E. 4th • Downtown Tonganoxie, KS**  
**(913) 369-3193**



# 4-H classes continued

FROM PAGE 39

15. Each club will be required to maintain its booth exhibit in a clean and orderly manner daily. No perishable items are to be used in display. Take care to select materials that will withstand Fair conditions. If booths are allowed to deteriorate after judging has taken place, ribbon placing may be lowered.

**SCORE CARD**

Educational Value 40 percent  
Interest/Originality 20 percent  
Appearance 20 percent

Quality of Display Material 20 percent

**SECTION 310 – 4-H PROMOTIONAL**

**Class 3011** – Banner designed/created by 4-H club members

**Class 3012** – Banner designed/created by individual 4-H member

**Class 3013** – Booth designed/created by 4-H club members

**SECTION 320 - NOXIOUS WEED CONTROL** - not eligible for State Fair

**Class 3021** – Banner designed/created by 4-H club members

**Class 3022** – Banner designed/created by individual 4-H member

**Class 3033** – Booth designed/created by 4-H club members

**SECTION 330 – ENVIRONMENTAL PROTECTION** - not eligible for State Fair

**Class 3031** – Banner designed/created by 4-H club members

**Class 3032** – Banner designed/created by individual 4-H member

**Class 3033** – Booth designed/created by 4-H club members

## DEPARTMENT 31 PROJECT DISPLAYS

Superintendent: Maureen Davidson, (785) 841-7537.

Judging: 2 p.m. Tuesday, Aug. 7, Green Metal Building, east side.

**SPECIAL RULES**

1. Read General Rules.
2. This department is limited to projects for which no other 4-H class is provided at the fair. No more than one entry per class except for Self-Determined. One entry may be made for each Self-Determined project. Exhibitors must be enrolled in the project in which they are exhibiting.
3. Each exhibitor must pre-enter. Entries are due to the Extension Office by July 15.
4. A member may enter ONE of the follow-

ing: notebook, table-top display, or poster telling about work done in their project -- per project area.

5. No project manuals or records should be entered.

6. Posters, limited to 22" x 28" in size, must relate to something learned in project.

7. Notebook contents may pertain to some phase, results, story or information about the project.

8. A table-top display, designed and constructed by the 4-H'er, must tell about what the member has done in a 4-H project through the use of posters, pictures, models, actual objects, etc. Name and club must be clearly marked on display.

9. Table-top displays must be freestanding, sturdy and limited to the size of a square card table. Everything must be contained on the card table - including title and display board. Members must furnish their own square table and/or display equipment. No round tables will be allowed.

10. No live animals or use of electricity is allowed.

11. Exhibitors must comply with state and federal laws. It is illegal to possess threatened or endangered wildlife, or the feathers, nests or eggs of non-game birds. Game birds and game animals taken legally during an open season may be used.

12. Nothing can be removed from displays after judging. The exhibit must remain intact as it was judged. Exhibitors are responsible for maintaining table-top displays in a clean and orderly manner daily.

13. Take care to select durable materials that will withstand Fair conditions. If display is allowed to deteriorate after judging has taken place, ribbon placing may be lowered.

14. Exhibits will be judged using the following guidelines: Stopping Power (15 pts.), Interest/Holding Power (15 pts.), 4-H Project Application (15 pts.), Mechanical Power (5 pts.), Personal Growth (25 pts.), and Educational Value (15 pts.).

15. Entries accepted 8 a.m.-noon Tuesday.

16. No State Fair exhibits in this department, with the exception of Wildlife.

**SECTION 110 - TABLE-TOP DISPLAY, NOTEBOOK OR POSTER**

**Class 3111** – Bicycle Class 3122 - Reading

**Class 3112** – Citizenship Class 3123 - Recreation

**Class 3113** – Communications Class 3124 - Self-determined

**Class 3114** – Dog Care and Training Class 3125 - Shooting Sports

**Class 3115** – Exploring 4-H Class 3126 - Sport Fishing

**Class 3116** – Exploring Your Environment

**Class 3127** – Wildlife (eligible for State Fair)

**Class 3117** – Environmental Science-Water

**Class 3118** – Family Studies

**Class 3119** – Health

**Class 3120** – Performing Arts

**Class 3121** – Outdoor Adventure

## DEPARTMENT 32 ENERGY MANAGEMENT/ELECTRIC

Award sponsor: Diamond E Farms  
**SPECIAL RULES**

1. Read General Rules.

1. Member must be enrolled in 4-H Electric or Energy Management project(s) by February 1 to exhibit.

2. Each exhibitor must pre-enter. Entries are due to the Extension Office by July 15.

3. Member is limited to a total of 5 entries.

4. Articles that have been in use should be cleaned for exhibit.

5. A sheet of operating instructions must be furnished for any exhibit that is not self explanatory. Wiring diagrams are needed.

6. Exhibits must be operable. If battery power is required, batteries must be furnished.

7. Any project with a complexity of size or electronics must have instructions for assembly and use; and equipment available at the time of judging for actual testing of the exhibit.

8. No hand dipped solder may be used on exhibits

9. Use correct light for fixture. For example, shatterproof light bulb for trouble light.

10. Exhibits must be weatherproof if for exterior light.

11. At State Fair, each exhibitor is limited to two articles in each Section, but only one article per class.

**SECTION 200 – ELECTRICITY**

**Class 3201** – AC Electric Projects. Electric projects with a 110 or 120 V alternating current (AC) power source. Some project examples are household wiring demonstrations, small appliances extension cords, trouble lights, indoor or outdoor wiring boards, or shop lights. Projects may be a restoration or original construction. The project must be operational and meet minimum safety standards. AC projects must be 110/120 V, no 240 V exhibits are allowed, and must be constructed such that the judges have access to examine the quality of workmanship.

**Class 3202** – DC Electric Projects. Electric projects with a battery or direct current

Please see 4-H, page 41

## PUBLIC NOTICE EXTENSION COUNCIL ELECTION(S) LEAVENWORTH COUNTY EXTENSION COUNCIL

TO: The Voters of Commissioner District No. 1, Commissioner District No. 2, and Commissioner District No. 3, Leavenworth County, State of Kansas

PUBLIC NOTICE is hereby given in accordance with K.S.A. 2-611, as amended, State of Kansas, that on the date and at the time and place mentioned below, the citizens of voting age of the Commissioner Districts mentioned shall meet for the purpose of electing four members, (one each for Agricultural Pursuits, Home Economics Work, 4-H Club and Youth Work, and Economic Development Initiatives) in each Commissioner District and Representatives to the Leavenworth County Extension Council.

Commissioner District No. 1	August 7, 8, 10, 2012, 6-9 p.m. Leavenworth County Fairgrounds
Commissioner District No. 2	August 7, 8, 10, 2012, 6-9 p.m. Leavenworth County Fairgrounds
Commissioner District No. 3	August 7, 8, 10, 2012, 6-9 p.m. Leavenworth County Fairgrounds

Consideration shall be given to the Extension Program for the Commissioner Districts of the County.

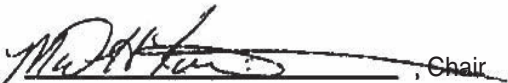
  
Executive Board



## 4-H classes continued

FROM PAGE 40

power source. This class includes electric kits or original projects. This class also includes demonstration DC powered project. Examples include: wiring two or three way switches, difference between series/parallel lighting circuits or wiring doorbells switches. All DC electric projects must work with batteries supplied by 4-H'er. Projects must be constructed such that the judges have access to examine the quality of wiring workmanship.

**Class 3203 – Electronics Projects.** Electronic projects with a battery or direct current power source. This class includes electronic kits or original projects. Examples include radios, telephones, toy robots, light meters, security systems, etc. May be constructed using printed circuit board, wire wrap, or breadboard techniques. Include instruction/assembly manual if from a kit. Include plans if an original project. Projects must be constructed such that the judges have access to examine the quality of wiring workmanship.

**Class 3204 – Educational Displays and Exhibits.** The purpose of the educational display and exhibit is to educate the viewer about a specific area of the 4-H electrical or electronics project. The display or exhibit should illustrate one basic idea. This class includes any educational displays, exhibits or science fair type projects which DO NOT have a power source, i.e. exhibits, posters or displays of wire types, conduit types, electrical safety, tool or motor parts identification or electrical terminology. Educational displays and exhibits must be legible from a distance of four feet, using a maximum tri-fold size of 3' x 4'.

### SECTION 300 – ENERGY MANAGEMENT

This section contains exhibits from the Small Engines and Power of the Wind projects.

**Small Engines-** All exhibits should involve engines smaller than 20 horsepower for classes 4610-4612. Displays are limited to 4' wide and 4' deep - both upright and floor displays.

**Class 3210 – DISPLAY** - Exhibit a display, selecting one of the following options: 1) a display identifying different engine or lawn and garden equipment parts or a display showing the function of the various engine or lawn and garden equipment parts; OR 2) a display identifying and explaining the function(s) of different special tools needed for small engine work; OR 3) a display illustrating and providing the results of any one of experiments that are included in the project books. No complete engines, lawn tractors, tillers, chainsaws are permitted for display. Maximum tri-fold size is 3' x 4'.

**Class 3211 – MAINTENANCE** - Exhibit a display that illustrates either 1) Routine maintenance procedures OR 2) Diagnosing

and trouble shooting specific problems in an engine. No complete engines, lawn tractors, tillers, chainsaws, etc. are permitted for display, using a maximum tri-fold size of 3' x 4'.

**Class 3212 – OPERATION** - Exhibit an operable small engine (no more than 20 HP) overhauled or rebuilt by the member. Include maintenance schedule for the engine and a brief description of steps taken by the member overhauling or rebuilding the engine. Maximum tri-fold size is 3' x 4'.

**WIND ENERGY** - All exhibits in this division are limited in size to standard, tri-fold, display boards (36" X 48") and items may not extend beyond 12" from the back board. All displays must be self standing.

**Class 3220 – EDUCATIONAL DISPLAY** - Create an exhibit that addresses a focused topic related to wind power as a renewable energy source. The purpose of the exhibit is to inform and create awareness.

**Class 3221 – EXPERIMENT** - Display an experiment addressing a problem or question related to wind power as a renewable energy source. Include hypothesis, background research, variables, a control, data, findings, conclusions and recommendations for future study.

For complete rules for the remaining departments, go to [leavenworth.ksu.edu/](http://leavenworth.ksu.edu/) and look for the "4-H Fair Book" tab.

## DEPARTMENT 33 ENTOMOLOGY

Superintendent: Carmen Hopkins,  
(913) 845-6039

CONSULTATION JUDGING:  
1 p.m. Tuesday, Aug. 7, Rabbit Barn

## DEPARTMENT 34 FORESTRY

Superintendent: Michelle Briggs, (913) 727-1063

CONSULTATION JUDGING:  
1 p.m. Tuesday, Aug. 7, Rabbit Barn

## DEPARTMENT 35 GEOLOGY

Superintendent: Carmen Hopkins,  
(913) 845-6039

CONSULTATION JUDGING:  
1 p.m. Tuesday, Aug. 7, Rabbit Barn

## DEPARTMENT 36 PHOTOGRAPHY

Superintendent: Marissa Wiley, (913) 775-1191.

Please see 4-H/FFA, page 42

## DeSoto Veterinary Clinic

**Matthew A. VanderVelde, D.V.M.**

General Veterinary Medicine & Surgery  
Grooming by Appointment

33900 Lexington • DeSoto, KS • (913) 585-1115  
Mobile 913-406-5508



## Bonner Springs



We Support  
The Leavenworth  
County Fair!  
Have fun and we'll  
see you there!

501 S. Commercial • Bonner Springs, KS  
913-441-6988 • [www.mypricechopper.com](http://www.mypricechopper.com)

## WAGG'N TAILS DAY SPA

Boutique - Pet Grooming - Training

15630 Pinehurst Drive, Basehor, KS 66012  
(913) 724-3700

[www.waggntailsdayspa.com](http://www.waggntailsdayspa.com)

**Full service grooming salon and pet boutique**

Bring this  
ad in for a  
**FREE teeth  
brushing  
with any spa  
purchase**



Offering  
Military  
and Public  
service  
discounts



# 4-H/FFA classes continued

FROM PAGE 41

ENTRIES ACCEPTED:  
9 a.m.-noon Tuesday, Aug. 7  
Tonganoxie 4-H Building  
CONSULTATION JUDGING:  
1 p.m. Tuesday, Aug. 7,  
Tonganoxie 4-H Building

## DEPARTMENT 37 4-H WOODWORKING

Superintendent: Roger White, (913)  
250-0994  
CONSULTATION JUDGING:  
9 a.m. Monday, Aug. 6,  
Green Metal Building — West Side

## DEPARTMENT 38 4-H/FFA VEGETABLES

Superintendent: Jason Ernzen, (913)  
727-3980  
ENTRIES ACCEPTED:  
1-4 p.m. Tuesday, Aug. 7  
Green Metal Building — East Side  
JUDGING: 5 p.m. Tuesday Aug. 7  
Green Metal Building — East Side  
Award Sponsors: Leavenworth County  
Master Gardeners

## DEPARTMENT 39 4-H/FFA FLOWERS

Superintendent: Brad Reynolds, (913)  
727-2088  
ENTRIES ACCEPTED:  
8:30-10 a.m. Wednesday, Aug. 8  
Home Economics Building  
JUDGING: 10:30 a.m. Wednesday,  
Aug. 8  
Home Economics Building  
Award Sponsors: Leavenworth County  
Master Gardeners

## DEPARTMENT 41 4-H/FFA PLANT SCIENCE

Superintendent: Jason Ernzen, (913)  
727-3980  
ENTRIES ACCEPTED:  
1-4 p.m. Tuesday, Aug. 7  
Green Metal Building – East Side  
JUDGING: 5 p.m. Tuesday, Aug. 7  
Green Metal Building – East Side

## DEPARTMENT 42 4-H/FFA POULTRY

Superintendent: Diane Larsen, (913)  
683-3291  
Award sponsors: Valley Feed and  
Sharon Henke.  
See 4-H/FFA General Regulations for  
pre-entry instructions  
ENTRIES ACCEPTED:  
8 a.m. to noon and 1 to 5:30 p.m.  
Tuesday, Aug. 7  
Poultry Barn  
SHOWMANSHIP JUDGING:  
10 a.m. Wednesday, Aug. 8,  
Poultry Barn  
POULTRY JUDGING:  
2 p.m. Wednesday, Aug. 8,  
Poultry Barn  
Award Sponsors: Heart of America  
Game Breeders Association and Leaven-  
worth County Co-Op.

## DEPARTMENT 43 4-H/FFA RABBITS

Superintendent: Mary Heston, (785)  
865-6261  
See 4-H/FFA General Regulations for  
pre-entry instructions  
ENTRIES ACCEPTED:

5-9 p.m. Monday, Aug. 6, and 8 a.m.-  
noon Tuesday Aug. 7  
Rabbit Barn  
RABBIT & SHOWMANSHIP JUDGING:  
9 a.m. Thursday, Aug. 9  
Rabbit Barn

## DEPARTMENT 44 4-H/FFA SWINE

Superintendents: Dean Sheets, (913)  
723-3505; Gene Waters, (913) 250-  
0660  
ENTRY & WEIGH IN:  
5-10 p.m. Monday, Aug. 8  
Livestock barns  
JUDGING: 6 p.m. Tuesday, Aug. 9  
Show Arena  
Swine Award Sponsors:  
Albert & Galen Knapp  
April Valley Farms  
Brandt Trucking  
CK Show Pigs  
Evans Real Estate  
Geiger Ready Mix Co.  
Johnson Farms  
Kraft Farms  
Kraft Garage Doors  
Larry & Teresa Lee  
Leavenworth County Co-Op  
Mike and Tammy Kissinger  
Patrick Cattle  
Terry, Karol, Tyler and Trey Lohman  
Theresa Holt  
Waters Feed Co.  
Waters Show Pigs  
Winchester Meat Processing, Inc.

## DEPARTMENT 45 4-H/FFA SHEEP

Superintendents: Oni and Jeff Hoge  
and Lauren Hoge, (913) 301-3080.

ENTRY & WEIGH IN:  
4-5 p.m. Monday, Aug. 6  
MARKET SHEEP JUDGING & SHOW-  
MANSHIP:  
7 p.m. Wed., Aug. 8, Show Arena  
BREEDING SHEEP JUDGING: follows  
above

Award Sponsors:  
KanGas Corporation  
Radius Broadband  
Bonner Springs Animal Health Center  
Lawrence Farms  
Ken Roads and Field Service  
Lauren Hoge  
Leavenworth County Co-Op  
Mollie Hoge  
Premier Designs by Packard  
Ken's Garage  
Caprine Supply  
Kansas Country Store  
Waters Feed  
Eldemar Farm  
Walking Sweater Farm & Fiber Arts-  
Abe Buddish

## DEPARTMENT 46 4-H/FFA HORSE

Superintendent: Katherine Shade,  
(913) 796-6967  
CHECK IN TIME: 8-9 a.m. Sunday, Aug.  
5  
JUDGING: 9 a.m. Sunday, Aug. 5  
Horse Arena  
Showmanship 7-9, 10-13, 14-18,  
Horseless, Beginners -  
Award Sponsors:  
Smith Veterinary Clinic, Inc.  
Kansas Country Store  
Bo and Paula Rollins  
Fox Eye Ranch

Please see 4-H/FFA, page 43

# Ken's Garage, Inc.

**Complete Auto & Truck Repair**

- Air Conditioning
- Tune Ups
- Transmission Service
- Alignments
- Computer Diagnostics
- Preventive Maintenance

**(913) 651-2433**  
108 Shawnee, Leavenworth  
[www.kensgarage1.com](http://www.kensgarage1.com)



# Ken's Road & Field Service

**Complete Heavy Equipment**  
**Truck & Trailer Farm Equipment**  
**Portable Welding**

# Mobile Tire Repair

**(913) 651-2433 1-877-668-3917**  
[www.kensgarage1.com](http://www.kensgarage1.com)





# 4-H/FFA classes continued

FROM PAGE 42

Wolken Flooring  
Petro Deli

## DEPARTMENT 47 4-H/FFA GOATS

Superintendent: Leana Leslie, (913) 481-3278  
See 4-H/FFA General Regulations for pre-entry instructions  
ENTRIES ACCEPTED AND WEIGHED IN: 8-9 a.m. Tuesday, Aug. 7  
Livestock barns  
MARKET & OTHER GOAT JUDGING: 8 a.m. Wednesday, Aug. 8  
Show Arena  
DAIRY GOAT SHOW:  
4 p.m. Thursday, Aug. 9, or immediately after beef show  
Show Arena  
Award Sponsors:  
Abe Buddish with Walking Sweater Farm and Fiber Arts  
Beth's Kydz Sudz, LLC  
Big D's Auction Service  
Black and Gold Farms  
CbarD Ranch Cindy and David Pelky Falk Family  
Jason and Jessica Webb  
Jen-Mae-Ka Kids Dairy Goats, Megan and Jennifer Lawrence  
Justyn Leslie  
K&L Farms  
Kansas Country Store  
Koch-Kidz Farm  
Lawrence Miller Farm  
Leslie Farm  
Mattox Family  
Rodney and Amy Parsons  
Tonga Ridge Acres  
Tonya Yadon Agency, Farmers Insur-

ance  
Tori's Ark

## DEPARTMENT 48 4-H/FFA BEEF

Superintendent: Matt Yungmans, (913) 727-2386 and Bill Baragary, (913) 708-3905  
ENTRY & WEIGH IN: 9-11 a.m. Tuesday, Aug. 7  
Livestock Barns  
JUDGING: 9 a.m. Thursday, Aug. 11, Show Arena  
Award Sponsors:  
AAF Fleet Service  
ADM Grain  
Atchison County Auction, Inc.  
Baldwin Farms  
Commerce Bank  
Dreamchaser Family Farm  
First State Bank and Trust  
J & N Ranch  
J Bar A LLC  
Johnson Family Farm  
Kansas Country Store  
Leavenworth Cooperative Assn.  
Leavenworth County Beef Improvement Assn.  
Charlie and Mary J. Luse  
McGraw Fertilizer, Inc.  
McConnel Machinery, Inc.  
Midland Farm Store  
Murrfield Farms  
John Navinsky  
New Haven Angus  
Rezac Livestock Commission  
David Tellefson Family  
Tire Town Inc.  
Tuttle Farms  
Waters Feed  
Winchester Meat Processing  
Highfill Family Farms

Mid-Continent Livestock Supplies  
Brandt Trucking  
DeMaranville and Associates CPA  
Navinsky Construction  
Parsons Red Angus  
St. Joseph Stockyards  
Triple K Gelveih  
John and Sharon Wagner Family  
Wiehe Angus  
Yungmans Family Farm  
Double MJ Limousin  
Rocky Top Limousin  
AF Van Fleet Excavating  
Atchison Animal Clinic  
Don and Shirley Navinsky  
Perry Milling  
Twin Oak Gelveih

## DEPARTMENT 49 4-H/FFA BUCKET CALF

Superintendents: Tyler Ewert, (913) 651-2449  
See 4-H/FFA General Regulations for pre-entry instructions  
ENTRIES ACCEPTED: 11 a.m. Tuesday, Aug. 7  
Livestock Barns  
CONSULTATION JUDGING: 8 a.m. Wednesday, Aug. 8  
Big Top Tent  
FITTING & SHOWING JUDGING: 2 p.m. Wednesday, Aug. 8  
Show Arena  
Award Sponsors:  
Triple K Gelbvieh  
Ron and Kay Ewert Family  
Diamond E Farms  
Tyler and Joy Ewert Family  
Tony and Susan Berg

## DEPARTMENT 50

## 4-H/FFA DAIRY

Superintendent: Rob Leach, (913) 723-3472  
See 4-H/FFA General Regulations for pre-entry instructions  
ENTRIES ACCEPTED: 8:30 a.m.-noon Thursday, Aug. 9  
Livestock Barns  
JUDGING: 8 p.m. Thursday, Aug. 11  
Show Arena

## DEPARTMENT 51 4-H/FFA DOGS

Superintendent: Debra Buddish, (913) 651-2166; Amy Parsons.....(913) 727-3071  
JUDGING: 9 a.m. Saturday, July 30  
Show Arena  
Agility Classes: 10 a.m. Saturday, Aug. 13  
Show Arena  
Award Sponsors:  
Zach Buddish in memory of Bessie Wade and Valyn Schmierer  
Pam Wolf  
Smith Veterinary Clinic  
Evans Real Estate  
James and Barbara White

## DEPARTMENT 52 TRACTOR OPERATOR

Superintendent: Tom Norman, (913) 301-3614  
EVENT TIME: 9:30 a.m. Wednesday, Aug. 10  
Check in at 4-H Office  
Award Sponsors: Leavenworth County Farm Bureau and Tom Norman family.

Please see 4-H/FFA, page 44

# RELIABLE CONSTRUCTION

Premium Quality Steel, Manufactured for Easy Assembly!

## CALL FOR QUOTE!



**UTILITY KING BUILDING SYSTEM®**  
INDEPENDENT DEALER

SOURCE: 1P0

# 866-609-4321



*"Our People Care"*

- Rehabilitation to Home
- Out Patient Rehabilitation
- Short Term Respite Care
- Long Term Care



## Tonganoxie Nursing & Rehabilitation Center

1010 East St – Tonganoxie KS - 913-369-8705



# SALUTE TO OUR DONORS

We Salute our 2011 4-H Fair Premium Donors  
THANK YOU for YOUR SUPPORT

- Leavenworth County Fair Association
- Hallmark Cards
- Leavenworth -Jefferson Electric Co-op
- Leavenworth County Fair Food Vendors:
- Blackbelt Bar-B-Q
- E&W Ice Cream and Food Shoppe
- Hall's Fantastic Funnel Cake and Hall's Fresh Squeezed Lemonade
- Holmes Enterprises
- Tropical Sno
- Italian Sausages and Moore LLC
- K&C Concessions

# GOAT SPONSORS

- Leslie Farm, sponsor of the Market Crossbred Champion and Market Crossbred Reserve Champion.
- Beth's Kydz Sudz LLC, sponsor of Dairy Showmanship 7-9 Reserve Champion and Dairy Showmanship 10-13 Reserve Champion.
- Cheryl Dufresne, sponsor for Senior Dairy Grand Champion and Senior Dairy Reserve Grand Champion.
- Tonya Yadon Agency, sponsor for Dairy Showmanship 14-18 Champion and Chevon Breeding Doe Champion.
- Tonga Ridge Acres, Junior Dairy Grand Champion
- Lawrence Miller Farm, sponsor
- Black and Gold Farms, Market Grand Champion and Market Purebred Champion
- Tori's Ark, Dairy Showmanship 7-9 Champion and Dairy Showmanship 10-13 Champion.

## 4-H/FFA classes continued

FROM PAGE 43

### DEPARTMENT 53 PETS/CATS

Superintendent: JoNell Thomas, (913) 682-5792  
JUDGING: 10 a.m. Saturday, July 30  
Tonganoxie 4-H Building  
CHECK-IN TIME: 9:30 A.M.  
Award Sponsors:  
Dog and Cat Clinic  
Gronis Hardware  
Kansas Country Store  
Smith Vet Clinic  
Waters Feed Co.

### DEPARTMENT 54 SPACETECH

Superintendent: Brenda Schmalstieg, (913) 796-6082  
EXHIBITS ACCEPTED & JUDGED: 5-8 p.m. Monday, Aug. 8, Tonganoxie 4-H Building  
LAUNCHING: 11:30 a.m. Friday, Aug. 13, Baseball field near fairgrounds  
Award Sponsors: Frances Frick

### DEPARTMENT 56 LEADERSHIP

Superintendent: Michelle Briggs, (913) 727-1063  
SPECIAL RULES  
1. Read General Rules.  
2. This department is open to any 4-H member enrolled in the 4-H Leadership project by Feb. 1.  
3. Each member needs to pre-enter by July 15.  
4. Members, 13 years and older, wishing to complete a Leadership Plan, need to enter Class 5621 to participate in the plan interview.  
5. Plan Interviews will be held pre-fair. The member should be prepared to discuss their leadership plan that they are in the process of completing or have completed.  
6. Project interviews will be held pre-fair. The member should be prepared to discuss their leadership opportunities and growth this 4-H year.  
7. Educational Exhibits must be directly related to leadership and may be in the form of a poster, notebook, or dis-

play. Follow copyright laws as explained in the General Rules and take care to select materials that will withstand Fair conditions. Posters may not be larger than 22" x 28". Displays may not be larger than 2'x3' tri-fold display board.

8. A limit of one entry per member for each class.

9. Leadership classes are not eligible for State Fair.

**SECTION 610 – 4-H LEADERSHIP** (ages 7-12)

**Class 5611 – Project Interview**

**Class 5612 – Educational Exhibit**

**SECTION 620 – 4-H TEEN LEADERSHIP** (ages 13-18)

**Class 5621 – Plan Interview**

**Class 5622 – Project Interview**

**Class 5623 – Educational Exhibit**

### DEPARTMENT 91 CLOVERBUDS

1. Read General Rules.  
2. Youth ages 5 & 6 as of January 1 of the current year and who are properly enrolled in the 4-H Cloverbud program by February 1 may exhibit in this depart-

ment.

3. Pre-entries are due July 15 to the Extension Office.

4. 4-H Cloverbud members may enter a total of 3 exhibits. If you have three Cloverbud items to enter, list Class 9101 three times on your entry sheet.

5. Articles made by the 4-H Cloverbud member as a club project may be entered.

6. All entries will receive a participation award and written comments.

7. Exhibits may include, but not limited to, a small woodwork item, arts and crafts item, garden item, poster, no-bake, non-perishable food item, etc. No live animals.

8. Cloverbud clubs are encouraged to provide a display, backdrop, banner or other similar group exhibit that may include their members' items. Such an exhibit will be for public viewing only.

**SECTION 100 - 4-H CLOVERBUD EXHIBITS**

**Class 9101 – an item made by a 4-H Cloverbud member**



**Great Western Manufacturing**

Great Western Manufacturing is a world leader in the design and manufacture of custom industrial processing machinery specializing in sifting and screening equipment.

*Founded in 1858, Great Western Manufacturing is the oldest continuously operated manufacturing firm in Kansas.*

**2017 S. 4th Street | Leavenworth, KS  
913-682-2291 | www.gwmfg.com**



**Walmart** Save money. Live better.

**5000 10th Avenue, Leavenworth, Kansas**

**OPEN 24 HOURS**

**We Proudly Support The Leavenworth County Fair!**

59091



# SALUTE TO OUR BUYERS

We Salute our 2011 Livestock Buyers

THANKS for YOUR SUPPORT

- A.F. Van Fleet Excavating, Inc.
- AAF Fleet Services, Inc.
- Acme Floor Company, Inc.
- Al Ramirez
- American Angus Hall of Fame
- Anchor Heavy Hauling
- Anchor Trucking
- April Valley Farms
- Bank of McLouth
- Bank of America Home Loans
- Bennie Phillips & Assoc.

#### Auctioneers

- Bill Parsons
- Brandt Truck
- Butler Muffler South Store
- C&J Feed
- CK Show Pigs
- Citizens Savings & Loan
- Clearwater Pools and Spas
- Commerce Bank
- Community National Bank
- Courtneys Used Truck Agribusiness
- DeMaranville & Assoc.
- Dog and Cat Clinic
- Double J limousin
- Dr. Jerry Theis
- Eberth's Show Cattle
- Ernie and Melissa Rieke
- Evans Real Estate
- First National Bank – Easton
- First State Bank and Trust
- Frederick Excavating
- Geiger Ready Mix
- Great Western Mfg.
- Heartland Dental Group
- Heartland Services, Inc.
- Heritage Tractor of Atchison and Lawrence.

#### ence.

- Highfill Family Farms
- Hilltop Market – Easton
- J Bar A LLC
- Jarbalo Junction Body Shop
- Joe McMillen
- Johnson Farms
- Joseph Steve, Jr.
- K.C. Bobcat
- Kansas Heavy Construction
- Knapp Family Farms
- Kramer and Associates, CPAs
- Leavenworth County Farm Bureau Association

#### sociation

- Ladd Service Company
- Leavenworth County Co-Op
- Leintz Lawn and Landscape
- Linaweaver Construction

- Lomar Acres LLC
- Lovendahl Farms
- Lynch Real Estate
- Lynn Ronnebaum
- Manville, Feldkamp, Navinsky Pioneer

#### Seed

- Mary and Charlie Luse
- Mary Knapp - Realtor
- Meadowlark Retrievers
- Mid West Fertilizer, Inc.
- Midcontinent Livestock Supplements
- Mudhole Farms LLC
- Murrfield Farms Supply
- Navinsky Construction, Inc.
- Navinsky Show Steers
- Perry Milling
- Petro Deli
- Phillips Insurance
- Pine Landscape Center
- Purple Wave Auction
- R Lazy K Feeders
- RL Stein Company, Inc.
- Reece & Nichols Premier Realty Basehor
- Rep. Melanie Meier
- Richard Parker
- Robert Stephen Wagner, CPA, Chartered
- Rowe's Mobile Service
- Schmalstieg Pedal Tractor Pulls
- Sheriff Dave Zoellner
- Southside Carpet
- Sparks Sand Blasting
- Superior Wood Products
- Tire Town
- Todd's Tire LLC
- Tonganoxie Mirror/The World Company
- Top Shelf Show Cattle
- Travis and Erica Graham
- Triple K Gelbvieh
- Turf Design Inc.
- Tuttle Farms
- Van Tuyl Farms
- Waters Feed Company
- Waters Show Pigs
- Winchester Meat Processing
- Yunghans Family Farm
- Zeck Ford



**550 Northstar Court**  
Tonganoxie, KS • 913-369-2700  
**15516 State Avenue**  
Basehor, KS • 913-724-2194

**GREAT SERVICE  
GREAT FOOD**

Bring this COUPON in for a  
**Regular Breakfast  
Burrito**

**99¢**



excludes  
premium  
burritos



**MIDWEST**  
*Bikes to Trikes*



[www.MidwestBikesToTrikes.com](http://www.MidwestBikesToTrikes.com)



**1601 Commerce Avenue**  
**Tonganoxie, KS 66086**



Email: [info@MidwestBikesToTrikes.com](mailto:info@MidwestBikesToTrikes.com)

Web: [www.midwestbiketotrikes.com](http://www.midwestbiketotrikes.com)

**Office: 913-727-2507 • Cell: 913-240-5198**

Call before you come. We may be on a Service Call.



**R Bar B**  
**Saddle, Tack & Trailer**

- New & Used Trailers • New & Used Saddles
- Saddle & Tack Repairs • Feed
- Livestock Show Supplies

**785-286-3006**

[www.rbarb.com](http://www.rbarb.com)

3256 NE 39th • Topeka, KS 66617



# LEAVENWORTH COUNTY FAIRGROUNDS

## COUNTY FAIR PARADE ROUTE:

Line up on Main Street in Tonganoxie by the City Pool. West on 4th Street to Church Street. North on Church Street to 3rd Street and proceed into Fair Grounds.

**Parents:** Pick up point for all children participating in the parade is inside the grandstand arena.

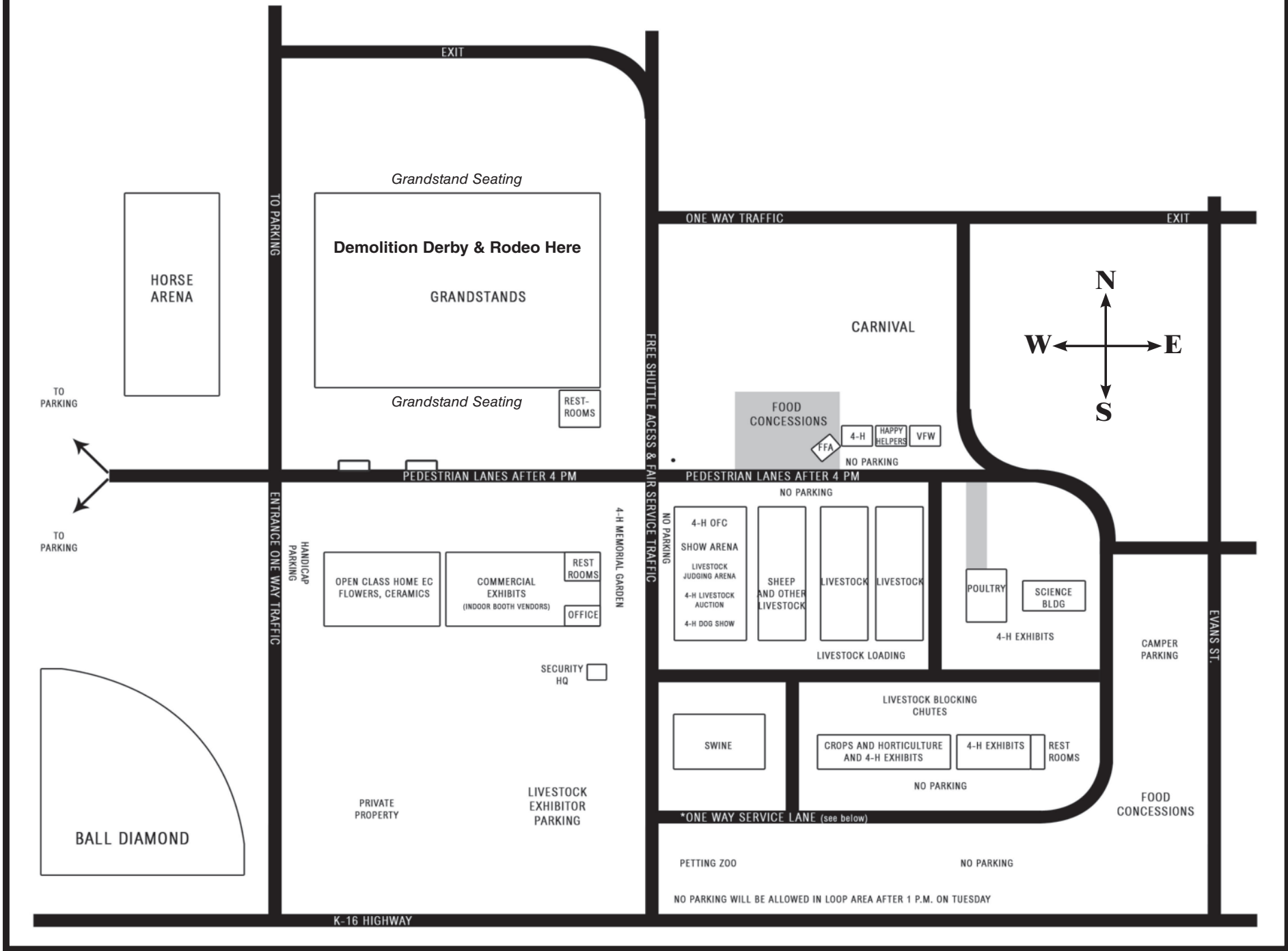





## READY TO WORK AS HARD AS YOU.

Getting the job done means working the whole day, every day. And it means having equipment that works as hard as you do. The new Farmall® C tractors from Case IH are more than ready to do their part – built to deliver the power and performance you need, reliably and cost-effectively. And they deliver a level of operator comfort that makes those long hard days a lot more productive. Here's a new generation of Case IH utility tractors that's as ready as you are for a hard day's work.



**SEE US TODAY!**

**MCCONNELL MACHINERY CO.**

1111 E 23rd

Lawrence, Ks. 66046

785-843-2676

[mcconnellmachineryco.com](http://mcconnellmachineryco.com)







# Great rates! Don't wait!



First State Bank & Trust is ready to help you with a new home loan or to refinance your current home loan. Work with a local bank and real people who have served the community since 1934!

**Here is your first step:**

☒ Give Tamara Morando a call at 913/845-5173 to start your home loan application.

OR

☒ Apply online at [www.mortgageapp.firststateks.com](http://www.mortgageapp.firststateks.com).

Where banking is *still* a people business.

[www.firststateks.com](http://www.firststateks.com) 800/463-7782 Tonganoxie & Basehor

Member FDIC



**Join us on  
MARCH 30, 2013  
for our  
14th annual  
PRODUCTION  
SALE**

# NEW HAVEN ANGUS

*A Cow  
Like This  
Produces*



Brandon New  
913-680-4414  
brandon@  
newhavenangus.com

Damon New  
913-727-1885  
[www.newhavenangus.com](http://www.newhavenangus.com)

Bill & Loris New  
913-351-1813  
Leavenworth, Kansas