

CORNER RECORD

Bk 24 Pg 84
Document Number CR 2760
City of PLEASANTON County of ALAMEDA, California

Brief Legal Description LOT 3, 196 PMB1, APN 094-0014-078

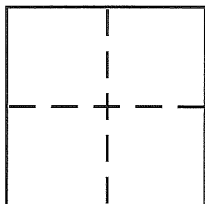

CORNER TYPE

Government Corner ☐ Control ☐
Meander ☐ Property ☒
Rancho ☐ Other ☐
Date of Survey 8-1-2006

COORDINATES (Optional)

N. _____
E. _____
Zone _____ NAD27 ☐ NAD83 ☐
NAD83 Epoch _____
Elev. _____
Vert. Datum: NGVD29 ☐ NAVD88 ☐
Meas. Units: Metric ☐ Imperial ☐

Corner - Left as found ☒ Found and tagged ☐ Established ☒ Reestablished ☐ Rebuilt ☐

Identification and type of corner found: Evidence used to identify or procedure used to establish or reestablish the corner:

SEE SKETCH

A description of the physical condition of the monument as found and as set or reset:

SEE SKETCH

SURVEYOR'S STATEMENT

This Corner Record was prepared by me or under my direction in conformance with the Land Surveyor's Act on August 8 2006.

Signed Frank C. Bellocq P.L.S. or R.C.E. No. PLS 5399

COUNTY SURVEYOR'S STATEMENT

This Corner Record was received _____

and examined and filed _____

Signed Russell R. Penland P.L.S. or R.C.E. No. 5726

Title COUNTY SURVEYOR

County Surveyor's Comment _____

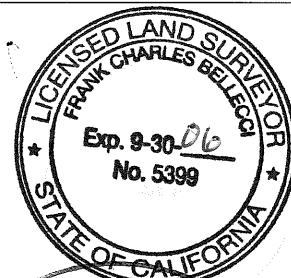

LEGEND

- FOUND STD. ST. MON, 196 PM 81, UNLESS NOTED
- ▲ FOUND RAILROAD SPIKE, 196 PM 81
- SET 5/8" REBAR & CAP, LS 5399

SCALE: 1" = 40'

ALL DIMENSIONS PER 196 PM 81

